

F.A.P. RTE.	SECTION	COUNTY	TOTAL SHEETS	SHEET NO.
327	(51-23)B-3	LAWRENCE	56	10
STA.		TO STA.		
FED. ROAD DIST. NO.		ILLINOIS FED. AID PROJECT		

- SUGGESTED SEQUENCE OF OPERATIONS:
1. CONSTRUCT BASE COURSE WIDENING.
  2. INSTALL STANDARD 701321 AND BARRIER FOR STAGE 1.
  3. REMOVE A PORTION OF EXISTING STRUCTURE AND CONSTRUCT STAGE 1 OF PROPOSED STRUCTURE.
  4. CONSTRUCT PROPOSED DITCHES AND EARTHWORK FOR STAGE 1.
  5. CONSTRUCT HMA FULL DEPTH PAVEMENT (EXCEPT SURFACE COURSE), BRIDGE APPROACHES AND SHOULDERS.
  6. CONSTRUCT PROPOSED GUARDRAIL.
  7. PLACE A PORTION OF THE BINDER COURSE ON THE EAST END TO CREATE TRANSITION BETWEEN PROPOSED AND EXISTING PROFILES.

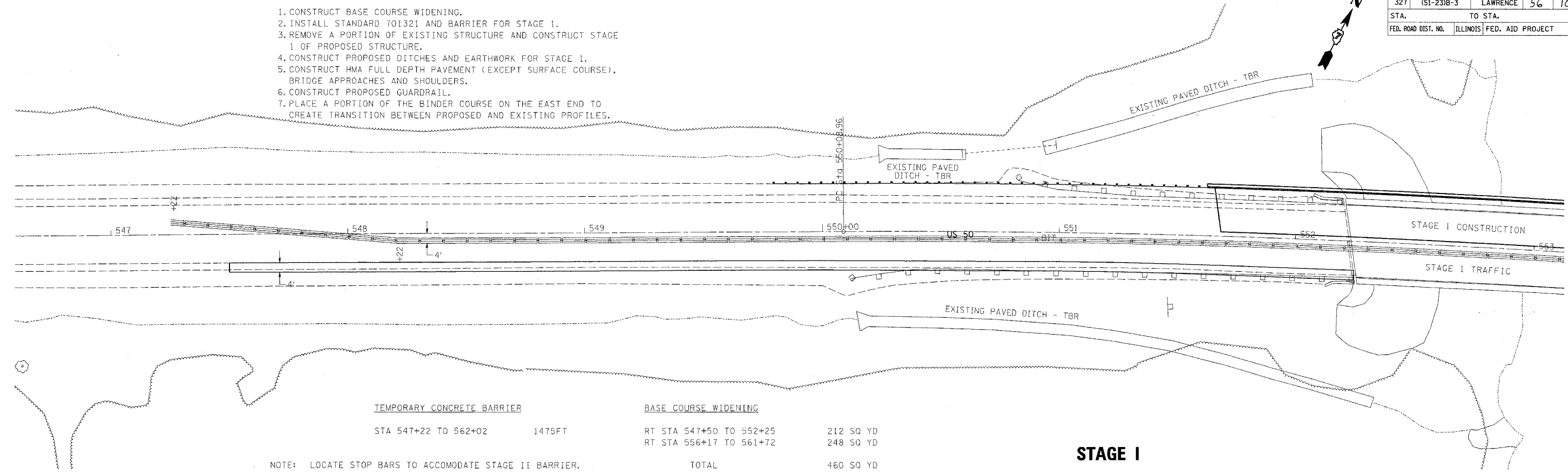

<u>TEMPORARY CONCRETE BARRIER</u>	<u>BASE COURSE WIDENING</u>		
STA 547+22 TO 562+02	RT STA 547+50 TO 552+25	1475FT	212 SQ YD
	RT STA 556+17 TO 561+72		248 SQ YD
	<b>TOTAL</b>		<b>460 SQ YD</b>

NOTE: LOCATE STOP BARS TO ACCOMMODATE STAGE II BARRIER.

**STAGE I**

- SUGGESTED SEQUENCE OF OPERATIONS:

- |  |  |
|--|--|
| <ol style="list-style-type: none"> <li>1. RELOCATE BARRIER AND SWITCH TRAFFIC TO STAGE 2 CONFIGURATION.</li> <li>2. REMOVE REMAINDER OF EXISTING STRUCTURE AND CONSTRUCT REMAINDER OF PROPOSED STRUCTURE.</li> <li>3. CONSTRUCT NEW DITCHES AND EMBANKMENT.</li> <li>4. CONSTRUCT HMA FULL DEPTH PAVEMENT (EXCEPT SURFACE COURSE), BRIDGE APPROACHES AND SHOULDERS.</li> <li>5. CONSTRUCT PROPOSED GUARDRAIL.</li> </ol> | <ol style="list-style-type: none"> <li>6. PLACE A PORTION OF THE BINDER COURSE ON THE EAST END TO CREATE TRANSITION BETWEEN PROPOSED AND EXISTING PROFILES.</li> <li>7. OPEN BRIDGE TO TWO WAY TRAFFIC.</li> <li>8. CONSTRUCT REMAINDER OF BINDER COURSE TO ATTAIN PROPOSED PROFILE.</li> <li>9. CONSTRUCT SURFACE COURSE AND REMAINDER OF SHOULDERS.</li> </ol> |
|--|--|

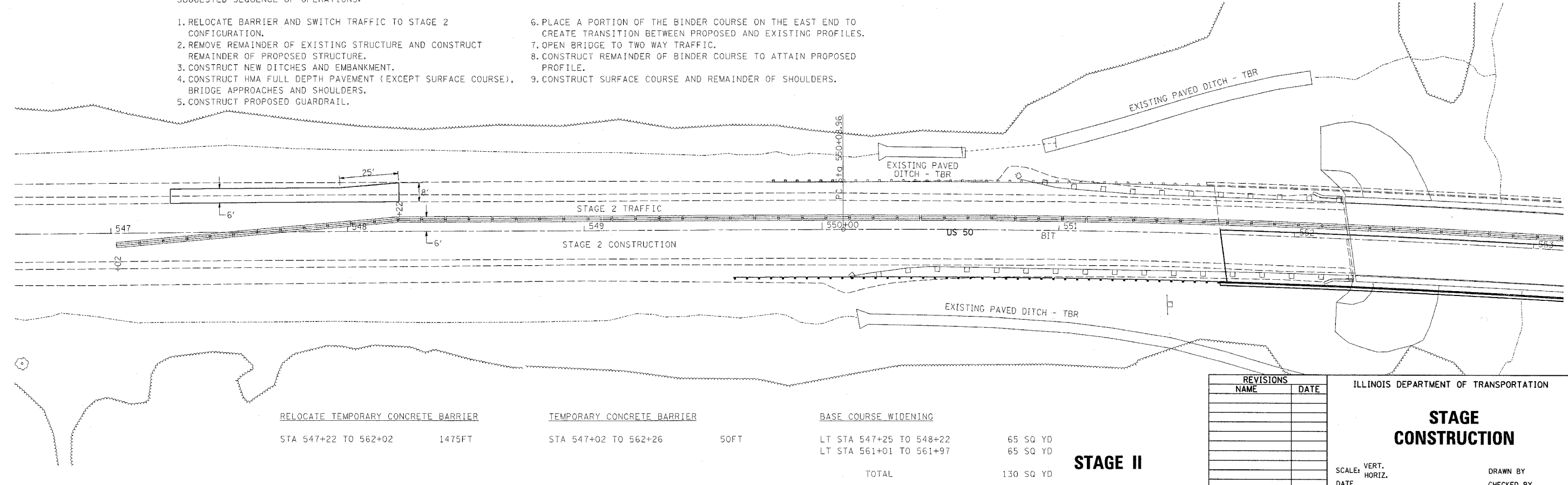

<u>RELOCATE TEMPORARY CONCRETE BARRIER</u>	<u>TEMPORARY CONCRETE BARRIER</u>	<u>BASE COURSE WIDENING</u>	
STA 547+22 TO 562+02	STA 547+02 TO 562+26	LT STA 547+25 TO 548+22	65 SQ YD
1475FT	50FT	LT STA 561+01 TO 561+97	65 SQ YD
		<b>TOTAL</b>	<b>130 SQ YD</b>

**STAGE II**

REVISIONS	
NAME	DATE

ILLINOIS DEPARTMENT OF TRANSPORTATION

**STAGE CONSTRUCTION**

SCALE: VERT. / HORIZ. / DATE

DRAWN BY / CHECKED BY

PLOT DATE = 9/4/2007  
 FILE NAME = c:\projects\94967\whiteage-94967.dgn  
 PLOT SCALE = 20.0000 / 1 IN.  
 USER NAME = sstf@emk