

F.A.S. RTE.	SECTION	COUNTY	TOTAL SHEETS	SHEET NO.
	06-00196-01-SW	ST. CLAIR	48	1
CONTRACT NO. 97322 FEDERAL AID PROJECT				

STATE OF ILLINOIS  
DEPARTMENT OF TRANSPORTATION  
DIVISION OF HIGHWAYS  
**PLANS FOR PROPOSED  
CITY OF BELLEVILLE  
DOWNTOWN BELLEVILLE STREETScape PH 2**  
SECTION 06-00196-01-SW  
PROJECT NO. TE-00D8(130)  
JOB NO. C98-308-08  
ST. CLAIR COUNTY

**INDEX OF SHEETS**

1. COVER SHEET
2. GENERAL NOTES & LEGEND
3. SUMMARY OF QUANTITIES
4. TYPICAL SECTIONS
- 5.-8. SCHEDULES
9. PLAN INDEX OF SHEETS
- 10.-12. ROADWAY PLAN SHEETS
- 13.-14. ROADWAY PROFILES
15. TRAFFIC CONTROL PLAN
- 16.-18. LANDSCAPE PLAN IN QUADRANTS
- 19.-22. WARPING DETAILS
23. IRRIGATION PLAN
24. DRAINAGE PLAN
- 25.-26. VAULT SCHEDULE, DETAILS AND NOTES
- 27.-29. PAVEMENT MARKING AND SIGNAGE PLAN
- 30.-31. MISC. DETAILS
32. ELECTRICAL SITE PLAN-DEMOLITION
33. ELECTRICAL SITE PLAN - NEW WORK
- 34.-36. LIGHTING
- 37.-39. POWER
- 40.-43. ELECTRICAL DETAILS
44. ELECTRICAL SCHEDULES
- 45.-48. CROSS SECTIONS

**STANDARDS**

000001-04
280001-03
424001-04
442101-06
606001-03
606301-03
701001-01
701006-02
701306-01
701501-03
701502-01
701602-02
701701-04
701801-03
702001-06
720001
720006-01
780001-01
781001-02
814006-01
BLR17-3
BLR21-6
BLR22-4

**SCALES:**

PLAN	1 INCH = 20 FEET
QUAD DETAILS	1 INCH = 10 FEET
KEY SHEETS	1 INCH = 40 FEET
CROSS SECTIONS	1 INCH = 5 FEET HORIZONTAL 1 INCH = 2 FEET VERTICAL

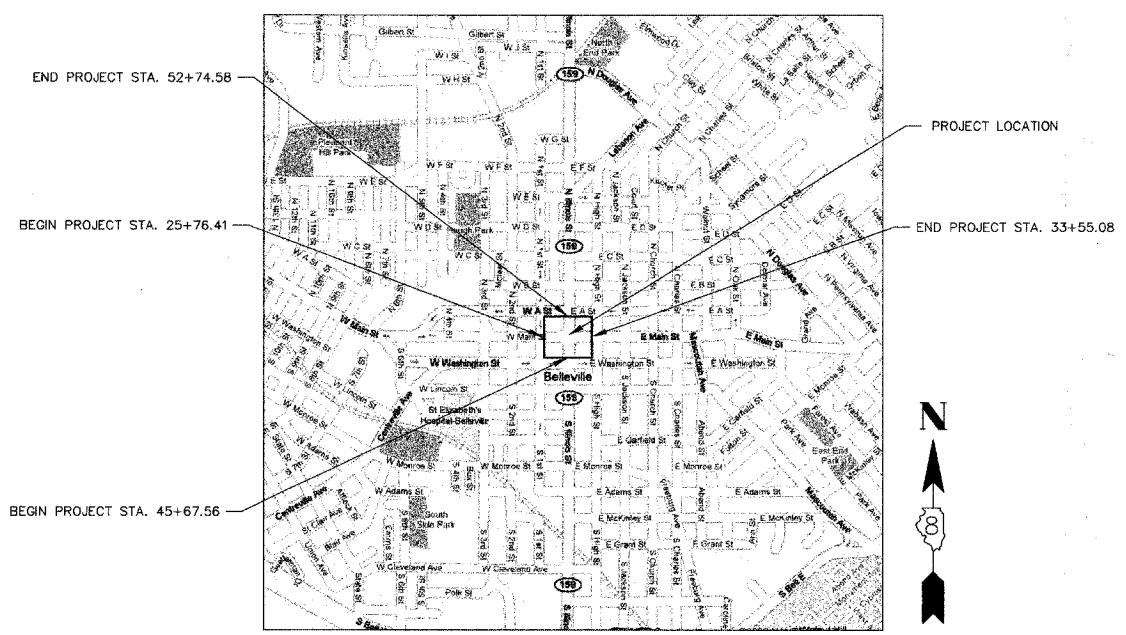
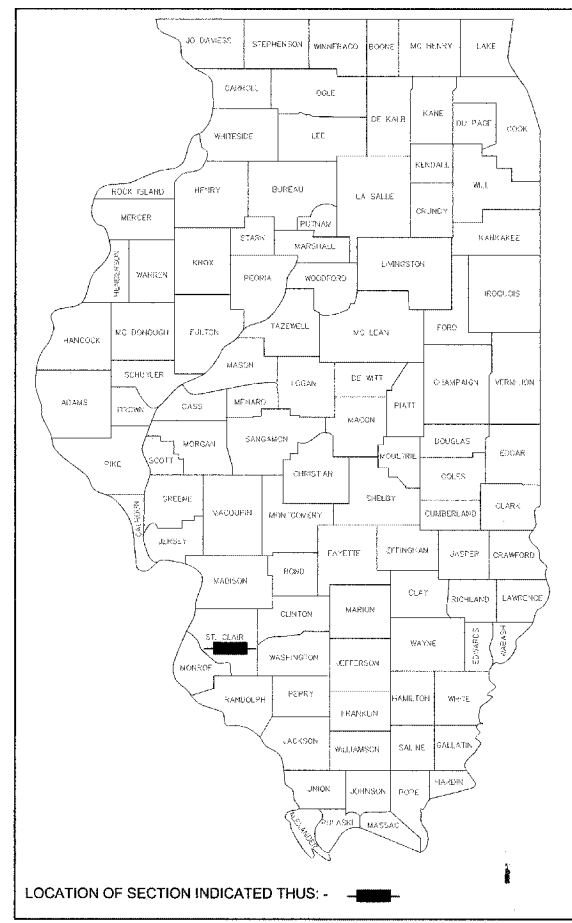

STATE OF ILLINOIS DEPARTMENT  
OF TRANSPORTATION DIVISION OF  
HIGHWAYS

SUBMITTED 9-12 20 07  
*Mark W. Eckert*  
MARK W. ECKERT, MAYOR

PASSED 9-18 20 07  
*[Signature]*  
RICHARD C. MAUCH, P.E., ACTING DISTRICT 8  
ENGINEER OF LOCAL ROADS AND STREETS

9-18 20 07  
*Mary C. Lame*  
MARY C. LAMIE, P.E., DEPUTY DIRECTOR OF HIGHWAYS,  
REGION FIVE ENGINEER

RELEASING FOR BID BASED UPON LIMITED REVIEW

GRAPHIC SCALES TO BE USED ARE SHOWN  
ACCORDINGLY ON EACH PLAN SHEET

**(J.U.L.I.E.)  
JOINT UTILITY LOCATION INFORMATION FOR  
EXCAVATION 1-800-892-0123**

LENGTH OF PROJECT  
GROSS/ NET LENGTH - ILLINOIS STREET = 707.02' (0.13 MILES)  
MAIN STREET = 778.67' (0.15 MILES)

IL 159 (N. & S. ILLINOIS) AND MAIN STREET  
ROADWAY CLASSIFICATION IL 159 - URBAN COLLECTOR  
DESIGN SPEED - 45 MPH  
ROADWAY CLASSIFICATION MAIN ST. - URBAN MINOR COLLECTOR  
DESIGN SPEED - 25 MPH

CURRENT YEAR (2007) ADT IL 159 - 16100  
CURRENT YEAR (2007) ADT MAIN ST. - 8300

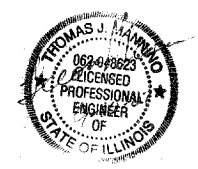

*Thomas Mannino* 9-10-07  
THOMAS MANNINO DATE  
LICENSE NO. 082-048623 EXPIRES: 11/30/2007

PREPARED BY:  
**Kaskaskia Engineering Group L.L.C.**