

GENERAL NOTES

1. CONTRACTOR SHALL LOCATE ALL EXISTING UTILITIES PRIOR TO BEGINNING CONSTRUCTION.
2. UNLESS NOTED OTHERWISE, ALL CONDUIT SHALL BE PVC.
3. ROUTE CONDUITS AROUND TREE PLANTING AREAS.
4. ALL LIGHTING SHALL REMAIN OPERATIONAL UNTIL NEW IS INSTALLED AND MADE OPERATIONAL.

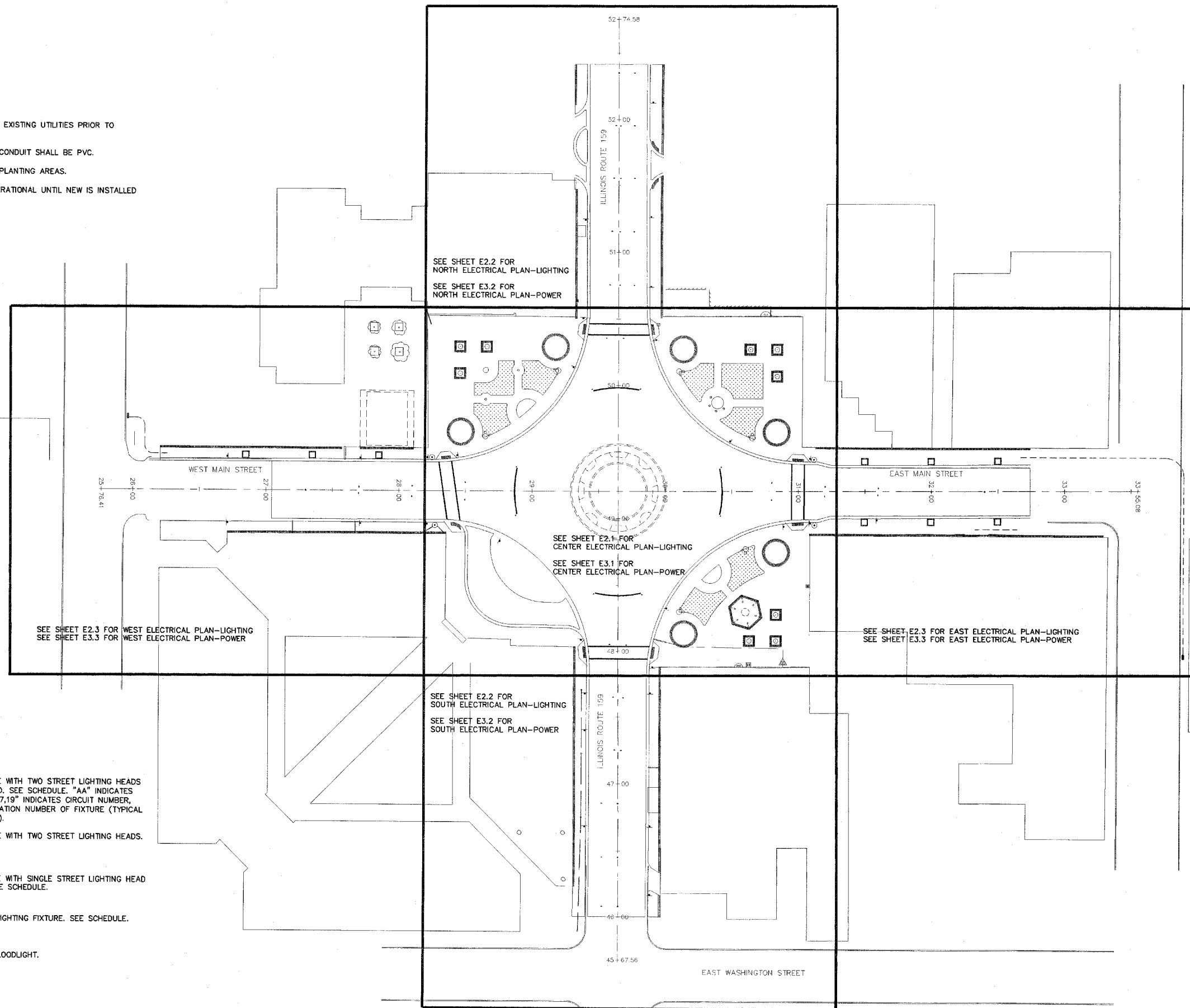

SYMBOL LEGEND

- AA
17,19
28+76LT
- AB
18,20
28+76RT
- B
17,19
28+21LT
- C
22,24
28+46RTI
- D
22,24
30+52RT2
- E
22,24
30+64RT
- DUPLEX RECEPTACLE
- GFI DUPLEX RECEPTACLE
- SVC ELECTRICAL SERVICE PEDESTAL/LIGHTING CONTROLLER. SEE ONE-LINE DIAGRAMS ON SHEET E4.3 AND DETAIL #1/E4.4.

ELECTRICAL SITE PLAN - NEW WORK

1" = 40'-0"



Kaskaskia Engineering Group L.L.C.
 23 Public Square Suite 404
 Belleville, Illinois 62220
 Office: (618)-239-2877 Fax: (618)-239-5977
 www.kaskaskiaeng.com
 A Disadvantaged Business Enterprise

PREPARED BY:

LEADSEAL:
 18-000713
 20-308036

PROFESSIONAL REGISTRATIONS:
 ILLINOIS PROFESSIONAL DESIGNER
 ILLINOIS PROFESSIONAL ENGINEERING CORP.

BRIC
 PARTNERSHIP, LLC
 CONSULTING ENGINEERS
 100 EAST WASHINGTON, SUITE 220
 BELLEVILLE, IL 62220
 TEL: 618.277.5200 FAX: 618.277.5227

SEAL

Signature: _____
 Expiration Date: _____

REV	DATE	DESCRIP

SHEET TITLE: **ELECTRICAL SITE PLAN - NEW WORK**

PROJECT TITLE: **BELLEVILLE SQUARE CITY OF BELLEVILLE ST. CLAIR COUNTY, ILLINOIS**

DESIGNED BY: ESF	SHEET
DRAWING BY: GYK/ESF	33
CHECKED BY: BEC	E1.0
DATE OF PRELIMINARY: 08/17/2007	
DATE OF FINAL:	
SHEET NO. 2	OF 13 SHEETS
PROJECT NUMBER 07-0041	