

F.A.P. RTE.	SECTION	COUNTY	TOTAL SHEETS	SHEET NO.
350	57B-3I	COOK	62	22
STA.		TO STA.		
FED. ROAD DIST. NO. 1 ILLINOIS FED. AID PROJECT				

CONTRACT NO. 60440

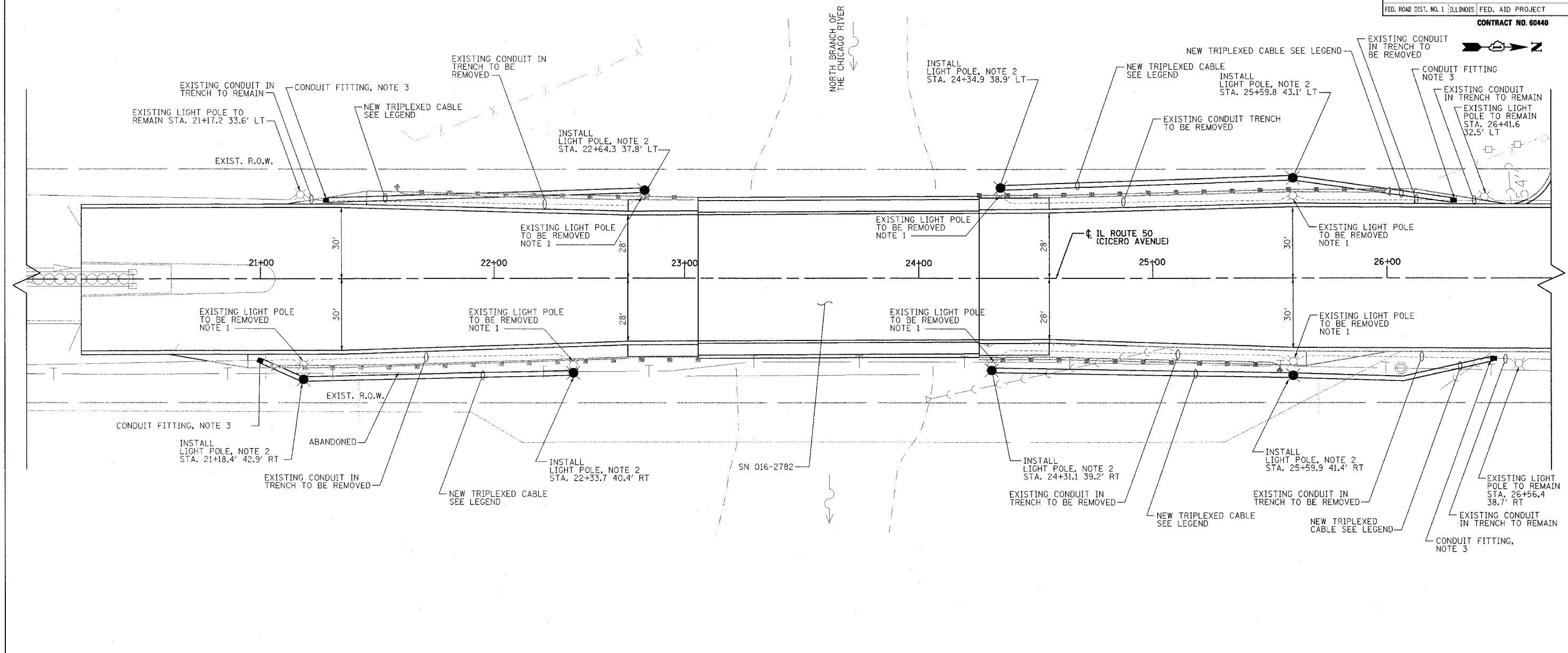

- NOTES:**
- REMOVAL AND DISPOSAL OF EXISTING LIGHTING UNIT, INCLUDING POLE, LUMINAIRE, FOUNDATION, ETC. PER IDOT STANDARD SPECS 842.
 - INSTALL NEW ALUMINUM 30' MOUNTING HT, 8' DAVIT ARM LIGHT POLE WITH A 480W SEMI-CUT-OFF LUMINAIRE PROVIDED BY OTHERS AT THE LOCATIONS SHOWN. INSTALL NEW CONCRETE FOUNDATION WITH ANCHOR RODS AND GROUND ROD AS SPECIFIED.
 - REMOVE EXISTING CABLE FROM CONDUIT. CUT EXISTING CONDUIT 10 FEET FROM THE POLE BASE AND CONNECT NEW CONDUIT.
 - ELECTRICAL CONTRACTOR SHALL COORDINATE WITH CDOT (CONTACT PATRICK SULLIVAN AT 312-746-8208) TO SCHEDULE PICK UP OF THE LIGHT POLES AND LUMINAIRES. COST SHALL BE INCLUDED WITH LIGHT POLE ITEM.
 - ELECTRICAL CONTRACTOR SHALL COORDINATE WITH CDOT AND MAINTAIN LIGHTS OPERATIONAL FOR THE SIDE OF THE ROAD THE TRAFFIC IS ON DURING STAGE CONSTRUCTION AS FOLLOWS:
 - MAINTAIN EXISTING LIGHTS ON THE EAST SIDE OF THE ROAD DURING STAGE 1 CONSTRUCTION.
 - NEW LIGHTS ON THE WEST SIDE SHALL BE OPERATIONAL PRIOR TO STAGE 2 CONSTRUCTION.
 - THE COST OF MAINTAINING THE LIGHTS OPERATIONAL SHALL BE INCLUDED WITH THE COST OF REMOVAL OF EXISTING LIGHTING UNIT ITEM.

BILL OF MATERIALS

CODE NO.	ITEM	UNIT	QUANTITY
81012600	CONDUIT IN TRENCH, 2" DIA., PVC	FOOT	700
81500200	TRENCH AND BACKFILL FOR ELECTRICAL WORK	FOOT	700
X8300100	LIGHT POLE, ALUMINUM, WITH MAST ARM, INSTALL ONLY	EACH	7
83600200	LIGHT POLE FOUNDATION, 24" DIAMETER	FOOT	63
84200600	REMOVAL OF EXISTING LIGHTING UNIT, NO SALVAGE	EACH	7
84200700	LIGHTING FOUNDATION REMOVAL	EACH	7
89502300	REMOVE ELECTRIC CABLE FROM CONDUIT	FOOT	700
X0322738	ELECTRIC CABLE IN CONDUIT, 600V (EPRN-TRIPLEXED) 2-1/C NO. 6, 1-1/C NO. 8 GROUND	FOOT	750
-	LUMINAIRE, INSTALL ONLY	EACH	7
-	REMOVAL OF CONDUIT IN TRENCH	FOOT	700

- LEGEND**
- PROF. EXIST.
- EXISTING LIGHT POLE
 - NEW LIGHT POLE PROVIDED BY OTHERS
 - EXISTING CONDUIT TO BE REMOVED
 - EXISTING CONDUIT TO REMAIN
 - CONDUIT FITTING
 - NEW 2" PVC CONDUIT WITH 2-1/C #6, 1-1/C #8 GROUND TYPE EPRN-TRIPLEXED, 600V

REVISIONS	
NAME	DATE

ILLINOIS DEPARTMENT OF TRANSPORTATION
ILLINOIS ROUTE 50 (CICERO AVENUE) OVER
NORTH BRANCH CHICAGO RIVER

LIGHTING PLAN

SCALE: 1"=20'

DATE: AUGUST 18, 2006

DRAWN BY: GMC
CHECKED BY: VVK

PATRICK
ENGINEERING INC.
LISLE, ILLINOIS