

F.A.U. RTE.	SECTION	COUNTY	TOTAL SHEETS	SHEET NO.
1627	0102.11-1	COOK	13	1

STATE OF ILLINOIS
DEPARTMENT OF TRANSPORTATION
DIVISION OF HIGHWAYS

**PROPOSED
HIGHWAY PLANS**

**FAU ROUTE 1627: GLENWOOD-LANSING RD
OVER IL 394 (BISHOP FORD EXPRESSWAY)
SECTION: 0102.11-1
BEAM REPLACEMENT
COOK COUNTY
C-91-291-06**

FOR INDEX OF SHEETS, SEE SHEET NO. 2

THE IMPROVEMENT IS LOCATED IN THE
CITIES OF GLENWOOD AND LANSING

TRAFFIC DATA

GLENWOOD-LANSING RD:

2002 ADT = 8,500
SPEED LIMIT = 30 MPH

IL 394:

2003 ADT = 59,700
SPEED LIMIT = 55 MPH

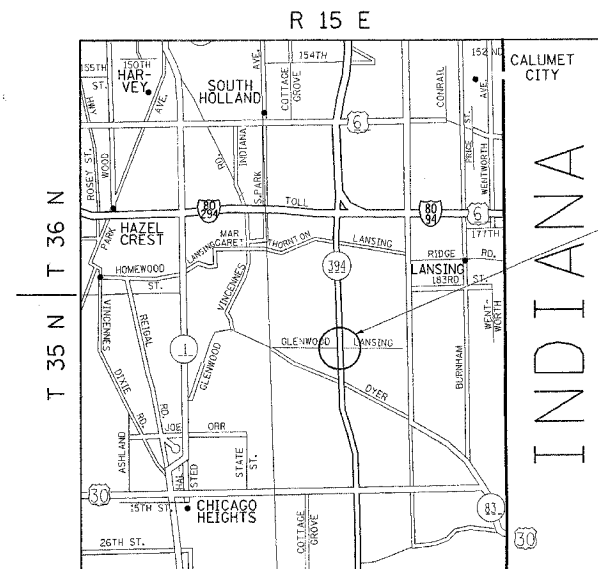
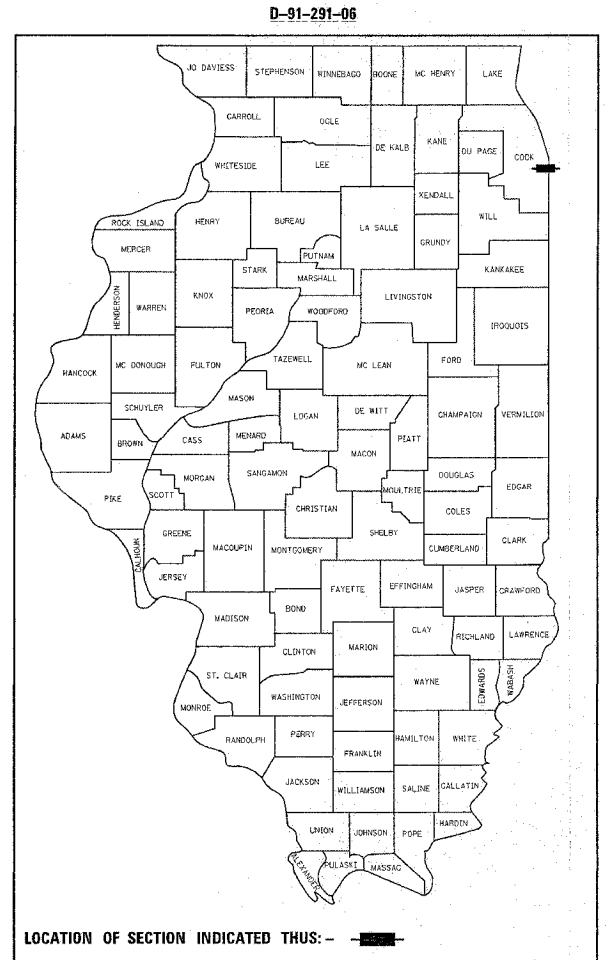

LOCATION OF IMPROVEMENT
GLENWOOD-LANSING RD OVER
IL 394, SN 016-0918

DISTRICT ONE DESIGN PLAN PREPARATION ENGINEER:
KEN ENG/ROBERT BORO (847)705-4178

J.U.L.I.E.
JOINT UTILITY LOCATION INFORMATION FOR EXCAVATION
1-800-892-0123

CONTRACT NO. 60B16

STATE OF ILLINOIS
DEPARTMENT OF TRANSPORTATION
DIVISION OF HIGHWAYS

SUBMITTED Sept 11 20 06
Diana O'Keefe /ca
DEPUTY DIRECTOR OF HIGHWAYS, REGION ENGINEER

October 13, 20 06
Mike Nune
ENGINEER OF DESIGN AND ENVIRONMENT

October 13, 20 06
Michael P. See, P.E.
DIRECTOR OF HIGHWAYS, CHIEF ENGINEER

**PRINTED BY THE AUTHORITY
OF THE STATE OF ILLINOIS**