

E.A.P. NO.	SECTION	COUNTY	TOTAL SHEETS	SHEET NO.
351	537 R-1	COOK	245	30
STA.	TO STA.		FED. ROAD DIST. NO.	
	ILLINOIS		FED. AID PROJECT	
CONTRACT # 62880				

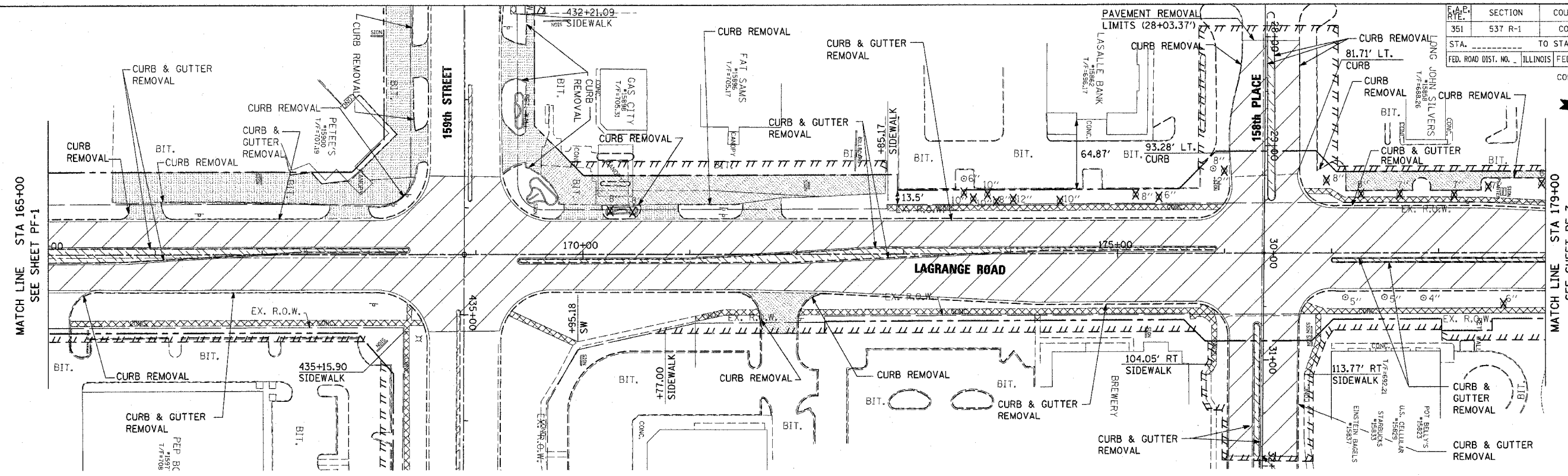

EXISTING CONDITIONS AND REMOVAL PLAN

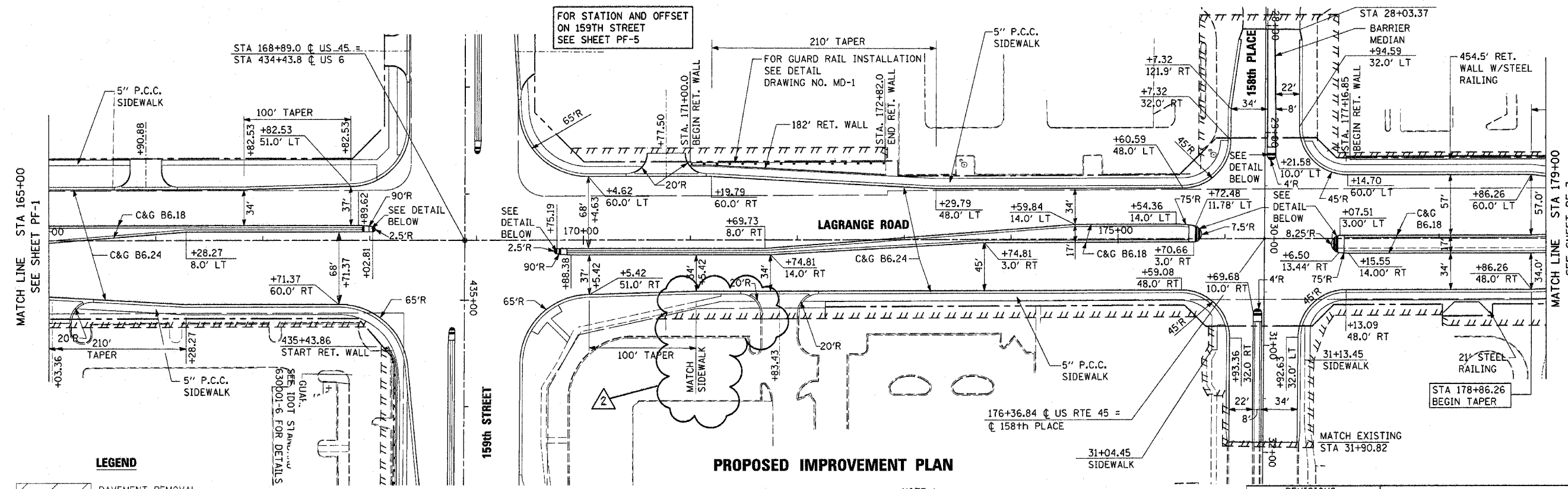

PROPOSED IMPROVEMENT PLAN

LEGEND

	PAVEMENT REMOVAL
	MEDIAN REMOVAL
	SIDEWALK REMOVAL
	CONCRETE DRIVEWAY REMOVAL (PAID AS "DRIVEWAY PAVEMENT REMOVAL")
	BITUMINOUS DRIVEWAY/PARKING REMOVAL (PAID AS "DRIVEWAY PAVEMENT REMOVAL")
	5" TREE REMOVAL
	TEMPORARY EASEMENT

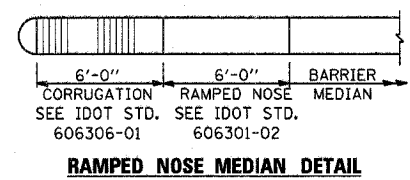

- NOTE 1:**
- ALL DRIVEWAY RECONSTRUCTION SHALL CONSIST OF PORTLAND CEMENT CONCRETE PAVEMENT 8". SEE SHEET DS-2 FOR DETAILS.
 - CONTRACTOR SHALL CONSTRUCT HANDICAP ACCESSIBILITY RAMPS AT ALL INTERSECTIONS AND DRIVEWAYS. SEE IDOT STANDARD 424001.

REVISIONS	
NAME	DATE

ILLINOIS DEPARTMENT OF TRANSPORTATION
 US RTE 6 (159TH ST) AT US RTE 45 (LAGRANGE RD)
EXISTING AND PROPOSED PLAN
 STA 165+00 TO STA 179+00
 SCALE: 1"=50'
 DATE: 7-07-06
 DRAWN BY: JTF
 CHECKED BY: RCH



I:\Dgn\101002.sht
 10/28/2006 8:26:40 PM
 8/26/06 PM