

**EXISTING CONDITIONS AND REMOVAL PLAN**

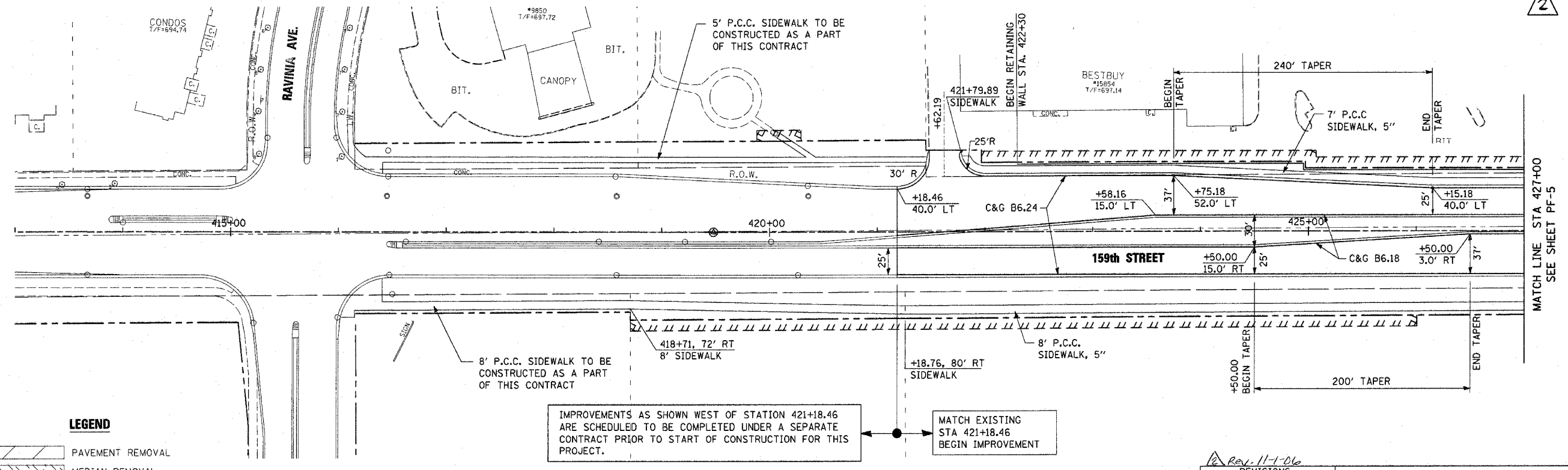

**PROPOSED IMPROVEMENT PLAN**

**LEGEND**

	PAVEMENT REMOVAL
	MEDIAN REMOVAL
	SIDEWALK REMOVAL
	CONCRETE DRIVEWAY REMOVAL (PAID AS "DRIVEWAY PAVEMENT REMOVAL")
	BITUMINOUS DRIVEWAY/PARKING REMOVAL (PAID AS "DRIVEWAY PAVEMENT REMOVAL")
	5' TREE REMOVAL
	TEMPORARY EASEMENT

- NOTE 1:**
- ALL DRIVEWAY RECONSTRUCTION SHALL CONSIST OF PORTLAND CEMENT CONCRETE PAVEMENT 8". SEE SHEET DS-2 FOR DETAILS.
  - CONTRACTOR SHALL CONSTRUCT HANDICAP ACCESSIBILITY RAMPS AT ALL INTERSECTIONS AND DRIVEWAYS. SEE IDOT STANDARD 424001-03.

Rev. 11-7-06

REVISIONS	NAME	DATE

ILLINOIS DEPARTMENT OF TRANSPORTATION  
 US RTE 6 (159TH ST) AT US RTE 45 (LAGRANGE RD)  
 US RTE 6 (159TH STREET)  
 EXISTING AND PROPOSED PLAN  
 STA 413+00 TO STA 427+00  
 SCALE: 1"=50'  
 DATE: 7-07-06  
 DRAWN BY: JTF  
 CHECKED BY: RCH

**McDonough Associates Inc.**  
 Engineers / Architects

E:\Dgn\PF01004.sht  
 10/28/2006 8:27:09 PM