

EXISTING CONDITIONS AND REMOVAL PLAN

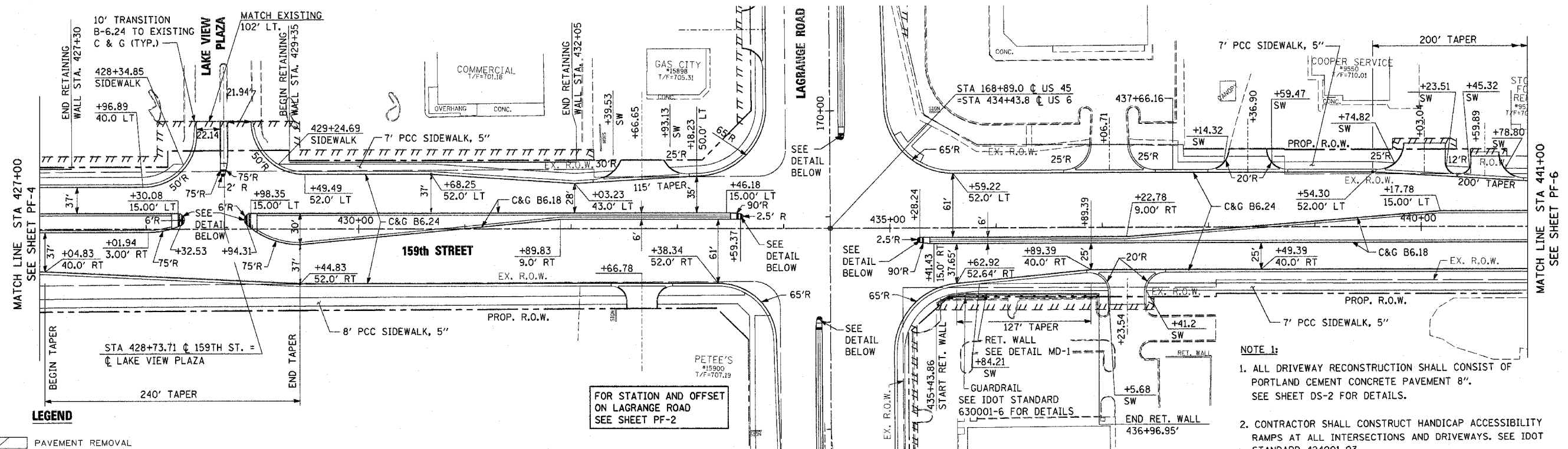

LEGEND

- PAVEMENT REMOVAL
- MEDIAN REMOVAL
- SIDEWALK REMOVAL
- CONCRETE DRIVEWAY REMOVAL (PAID AS "DRIVEWAY PAVEMENT REMOVAL")
- BITUMINOUS DRIVEWAY/PARKING REMOVAL (PAID AS "DRIVEWAY PAVEMENT REMOVAL")
- TREE REMOVAL
- TEMPORARY EASEMENT

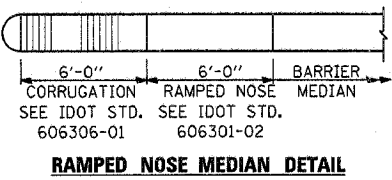

PROPOSED IMPROVEMENT PLAN

- NOTE 1:**
1. ALL DRIVEWAY RECONSTRUCTION SHALL CONSIST OF PORTLAND CEMENT CONCRETE PAVEMENT 8\"/>
SEE SHEET DS-2 FOR DETAILS.
- NOTE 2:**
2. CONTRACTOR SHALL CONSTRUCT HANDICAP ACCESSIBILITY RAMPS AT ALL INTERSECTIONS AND DRIVEWAYS. SEE IDOT STANDARD 424001-03.

| REVISIONS | |
|-----------|------|
| NAME | DATE |
| | |
| | |
| | |
| | |

ILLINOIS DEPARTMENT OF TRANSPORTATION
US RTE 6 (159TH ST) AT US RTE 45 (LAGRANGE RD)
US RTE 6 (159TH STREET)
EXISTING AND PROPOSED PLAN
STA 427+00 TO STA 441+00
SCALE: 1"=50'
DATE: 7-07-06
DRAWN BY: JTF
CHECKED BY: RCH



I:\Dm\p101005.sht
10/26/06 9:27:30 PM

REV. 11-1-06