

CONTINUED FROM DRAWING PF-5
MATCH LINE STA 441+00

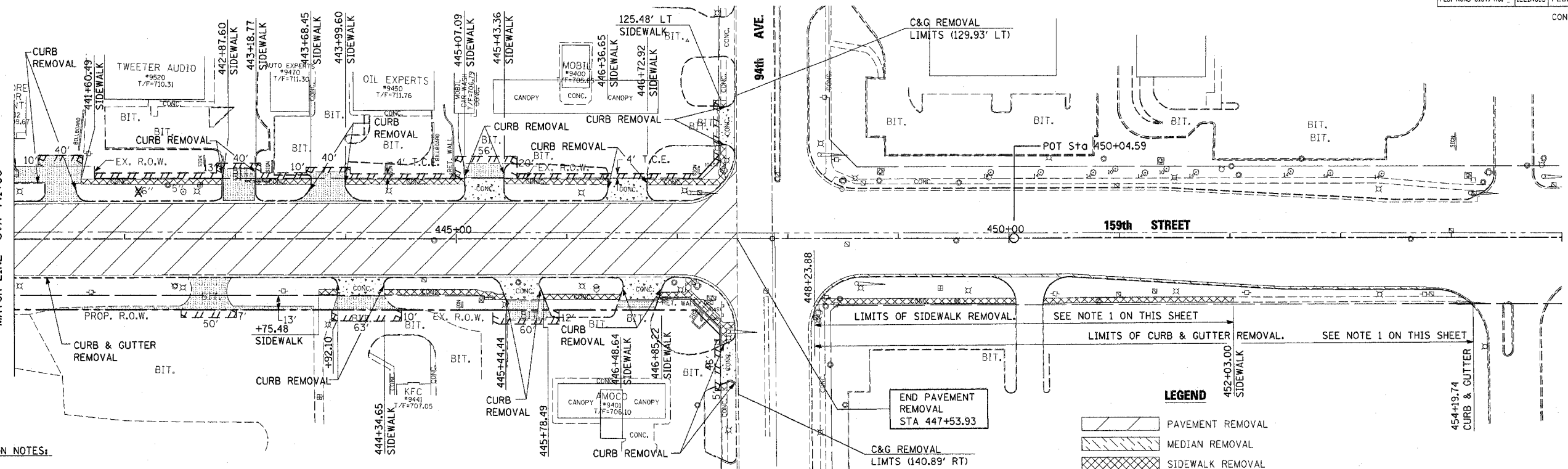

NOTE 1:

RESTORATION NOTES:

AT THE TEMPORARY PAVEMENT LOCATION, THE CONTRACTOR SHALL REMOVE AND REPLACE CURB & GUTTER, MEDIAN AND SIDEWALK IN-KIND FOR THE FOLLOWING LIMITS:

CURB & GUTTER LIMITS: STA. 448+23.88± TO STA. 454+19.74± (SOUTH ONLY)
SIDEWALK LIMITS: STA. 448+23.88± TO STA. 454+19.74± (SOUTH ONLY)

EXISTING LIGHTS WITHIN THIS PARCEL LIMITS TO REMAIN. PROTECT AS REQUIRED.

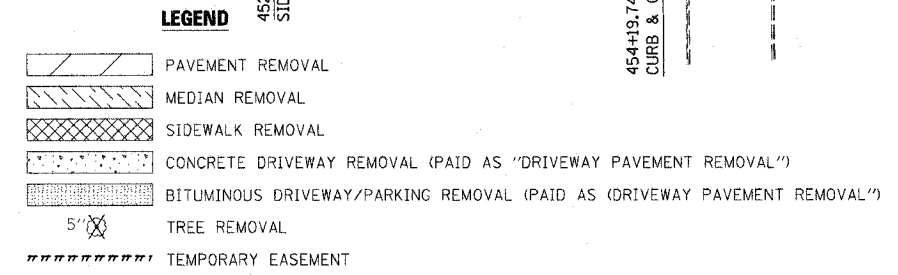

CONTINUED FROM DRAWING PF-5
MATCH LINE STA 441+00

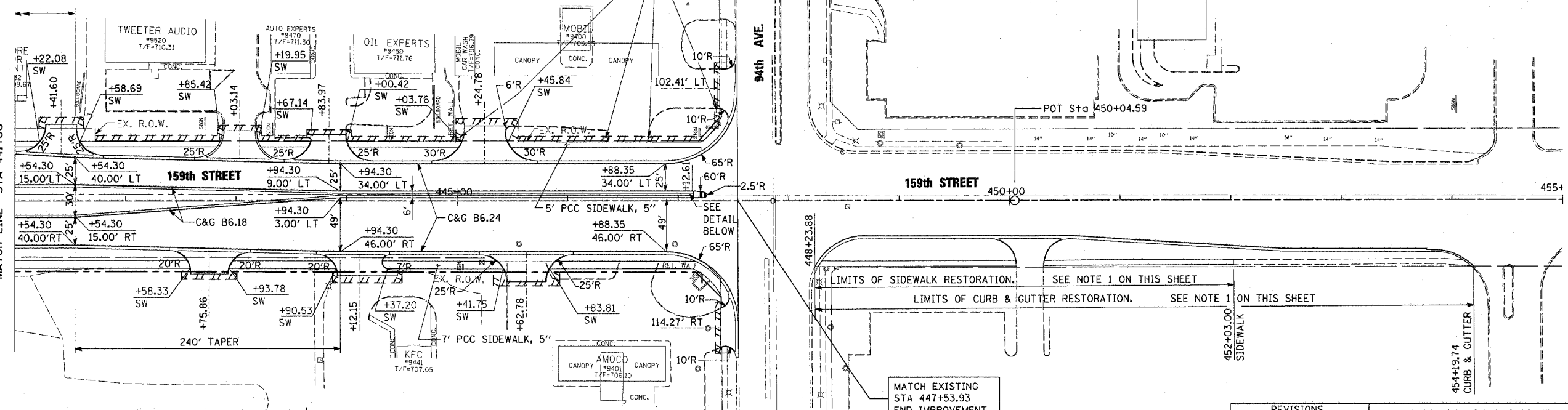

NOTE 2:

- ALL DRIVEWAY RECONSTRUCTION SHALL CONSIST OF PORTLAND CEMENT CONCRETE PAVEMENT 8". SEE SHEET DS-2 FOR DETAILS.
- CONTRACTOR SHALL CONSTRUCT HANDICAP ACCESSIBILITY RAMPS AT ALL INTERSECTIONS AND DRIVEWAYS. SEE IDOT STANDARD 424001-03.

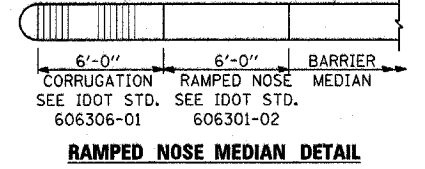

REVISIONS	
NAME	DATE

ILLINOIS DEPARTMENT OF TRANSPORTATION
US RTE 6 (159TH ST) AT US RTE 45 (LAGRANGE RD)
US RTE 6 (159TH STREET)
EXISTING AND PROPOSED PLAN
STA 441+00 TO 94TH AVE.
SCALE: 1"=50'
DATE: 7-07-06
DRAWN BY: JTF
CHECKED BY: RCH

McDonough Associates Inc.
Engineers / Architects

Rev. 11-1-06