

**DRAINAGE LEGEND AND SYMBOLS**

- |        |  |      |                                     |
|--------|--|------|-------------------------------------|
| (160R) | STRUCTURE NUMBER (STORM SEWER)                                   | →    | SWALE                               |
| (R)    | STRUCTURE REMOVAL  | ○    | EXISTING CATCH BASIN                |
| (AD)   | STRUCTURE TO BE ADJUSTED   | ●    | PROPOSED CATCH BASIN                |
| (REC)  | STRUCTURE TO BE RECONSTRUCTED                                    | ▷    | EXISTING CULVERT FLARED END SECTION |
| (F)    | STRUCTURE TO BE FILLED   | ▶    | PROPOSED CULVERT FLARED END SECTION |
| (RP)   | REMOVE EXISTING DRAINAGE STRUCTURE AND PLUG EXISTING STORM SEWER | ---- | EXISTING UTILITY TO BE REMOVED      |
| (A)    | VALVE VAULT TO BE ADJUSTED                                       | XXXX | EXISTING UTILITY TO BE ABANDONED    |
| (△)    | TELEPHONE MANHOLE TO BE REMOVED/ADJUSTED (BY OTHERS)             |      |                                     |
| (160W) | STRUCTURE NUMBER (WATER MAIN)                                    |      |                                     |
| (160S) | STRUCTURE NUMBER (SANITARY SEWER)                                |      |                                     |
| (M)    | STRUCTURE TO BE REMOVED  |      |                                     |

**EXISTING CONDITIONS**

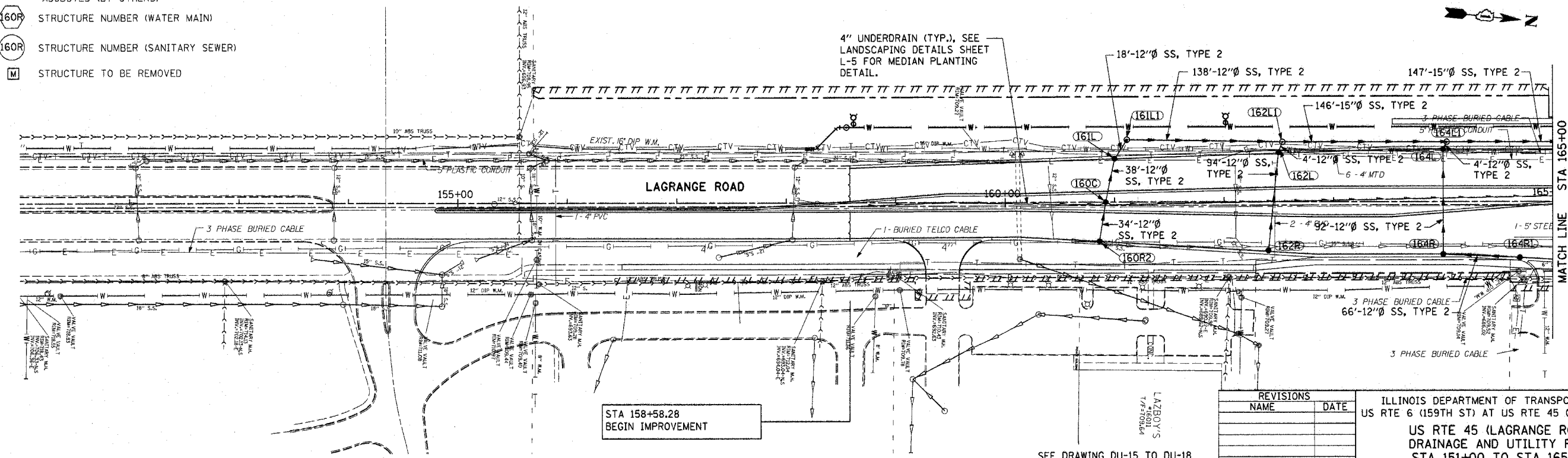

**PROPOSED IMPROVEMENTS**

SEE DRAWING DU-15 TO DU-18 FOR WATER MAIN RELATED ITEMS

Rev. 11-1-06

REVISIONS	
NAME	DATE

ILLINOIS DEPARTMENT OF TRANSPORTATION  
 US RTE 6 (159TH ST) AT US RTE 45 (LAGRANGE RD)  
**US RTE 45 (LAGRANGE ROAD)  
 DRAINAGE AND UTILITY PLAN  
 STA 151+00 TO STA 165+00**  
 SCALE: 1"=50' DRAWN BY: OJU  
 DATE: 7-07-06 CHECKED BY: RCH

**McDonough Associates Inc.**  
 Engineers / Architects

I:\Data\du01001.dwg  
 10/28/2006  
 8:00:11 PM