

TOPOGRAPHY SHOWN WEST OF STA. 412+18.46 REPRESENTS EXISTING CONDITIONS IN FEBRUARY, 2006

EXISTING CONDITIONS

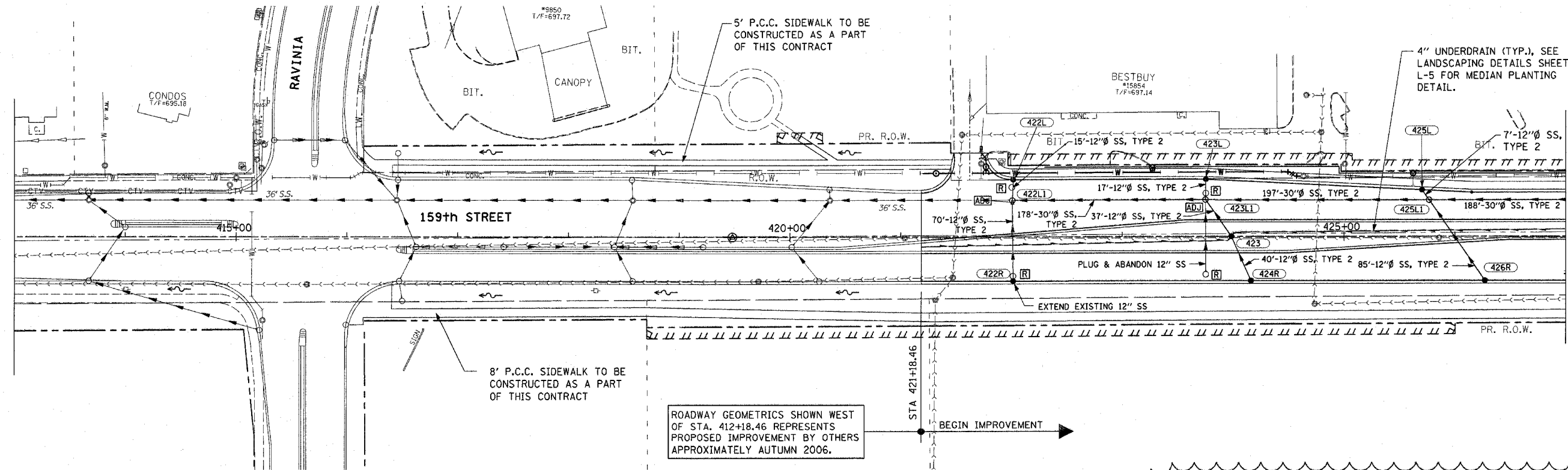

ROADWAY GEOMETRICS SHOWN WEST OF STA. 412+18.46 REPRESENTS PROPOSED IMPROVEMENT BY OTHERS APPROXIMATELY AUTUMN 2006.

PROPOSED IMPROVEMENTS

SEE DRAWING DU-15 TO DU-18 FOR WATER MAIN RELATED ITEMS

Rev. 11-1-06

REVISIONS	
NAME	DATE

ILLINOIS DEPARTMENT OF TRANSPORTATION
 US RTE 6 (159TH ST) AT US RTE 45 (LAGRANGE RD)
US RTE 6 (159TH STREET)
DRAINAGE AND UTILITY PLAN
 STA 421+18.46 TO STA 427+00
 SCALE: 1"=50'
 DATE: 7-07-06
 DRAWN BY: OIU
 CHECKED BY: RCH

McDonough Associates Inc.
 Engineers / Architects

I:\Dgn\dd01004.sht
 07/20/2006
 9:02:44 PM