

F.A.P. RTE.	SECTION	COUNTY	TOTAL SHEETS	SHEET NO.
351	537 R-1	COOK	245	163
STA. 413+00		TO STA. 427+00		
FED. ROAD DIST. NO.	ILLINOIS	FED. AID PROJECT		
CONTRACT # 62880				

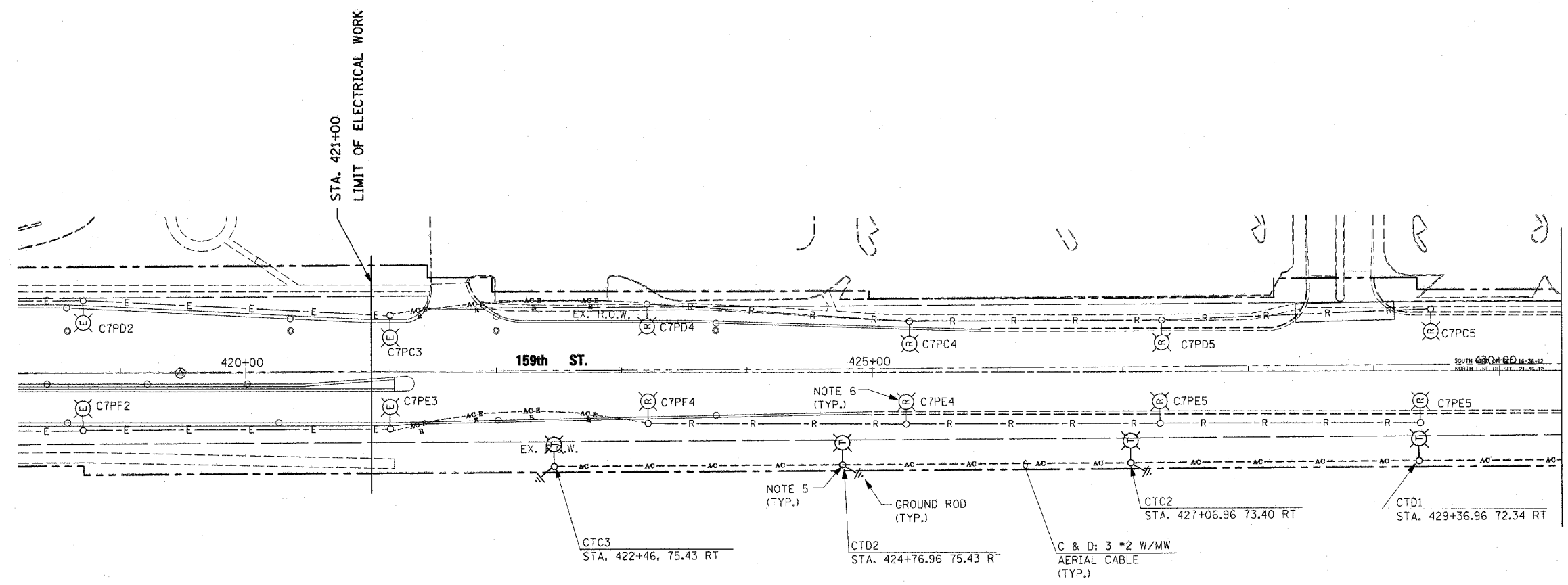

MATCH LINE STA 430+50
FOR CONTINUATION SEE DRAWING RL-2

- NOTES:**
- SEE DRAWING RL-1 FOR LIGHTING PHASING NOTES.
 - TEMPORARY LIGHTING UNITS SHALL BE FURNISHED, INSTALLED AND ENERGIZED PRIOR TO THE COMMENCEMENT OF STAGE 1 WORK.
 - TEMPORARY LIGHTING WILL REMAIN IN SERVICE UNTIL PROPOSED (PERMANENT) LIGHTING IS INSTALLED, ENERGIZED, TESTED AND APPROVED BY THE ENGINEER.
 - FOR TEMPORARY LIGHTING DETAILS, SEE DRAWING ED-7.
 - TEMPORARY WOOD POLE, 100 FT., CLASS 4, 15 FT. MAST ARM WITH LUMINAIRE, SODIUM VAPOR, HIGH MAST, HORIZONTAL MOUNT, 750 WATT, 80 FT. MOUNTING HEIGHT AND 20 TILTED FROM VERTICAL TOWARDS ROADWAY. FOR TEMPORARY LIGHTING DETAILS, SEE DRAWING ED-7.
 - EXISTING LIGHTING POLE FOUNDATION SHALL BE REMOVED IN ACCORDANCE WITH IDOT STANDARD SPECIFICATIONS.

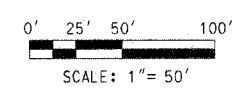
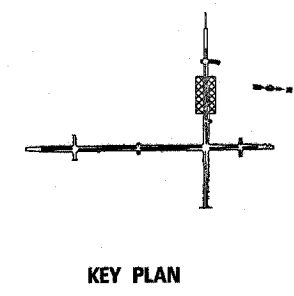

Rev. 11-1-06

REVISIONS	
NAME	DATE

RL-4

ILLINOIS DEPARTMENT OF TRANSPORTATION
US RTE 6 (159TH ST) AT US RTE 45 (LAGRANGE RD)
159TH STREET (US RTE 6)
TEMPORARY LIGHTING AND REMOVAL PLAN
STA 421+18.76 TO STA 430+50

SCALE: 1" = 50' DRAWN BY: MB
DATE: 7-07-06 CHECKED BY: KMY

McDonough Associates Inc.
Engineers / Architects

E:\Elec\CADD\RL-4.dgn
10/28/2006
7:43:54 PM