

F.A. RTE.	SECTION	COUNTY	TOTAL SHEETS	SHEET NO.
351	537 R-1	COOK	245	200
STA.		TO STA.		
FED. ROAD DIST. NO.		ILLINOIS	FED. AID PROJECT	
CONTRACT # 62880				

DATE	
BY	
FINAL SURVEY	
SHRINKED PLOTTED	
NOTE BOOK	
AREAS CHECKED	

DATE	
BY	
ORIGINAL SURVEY	
SHRINKED PLOTTED	
NOTE BOOK	
AREAS CHECKED	

DATE	
BY	
ORIGINAL SURVEY	
SHRINKED PLOTTED	
NOTE BOOK	
AREAS CHECKED	

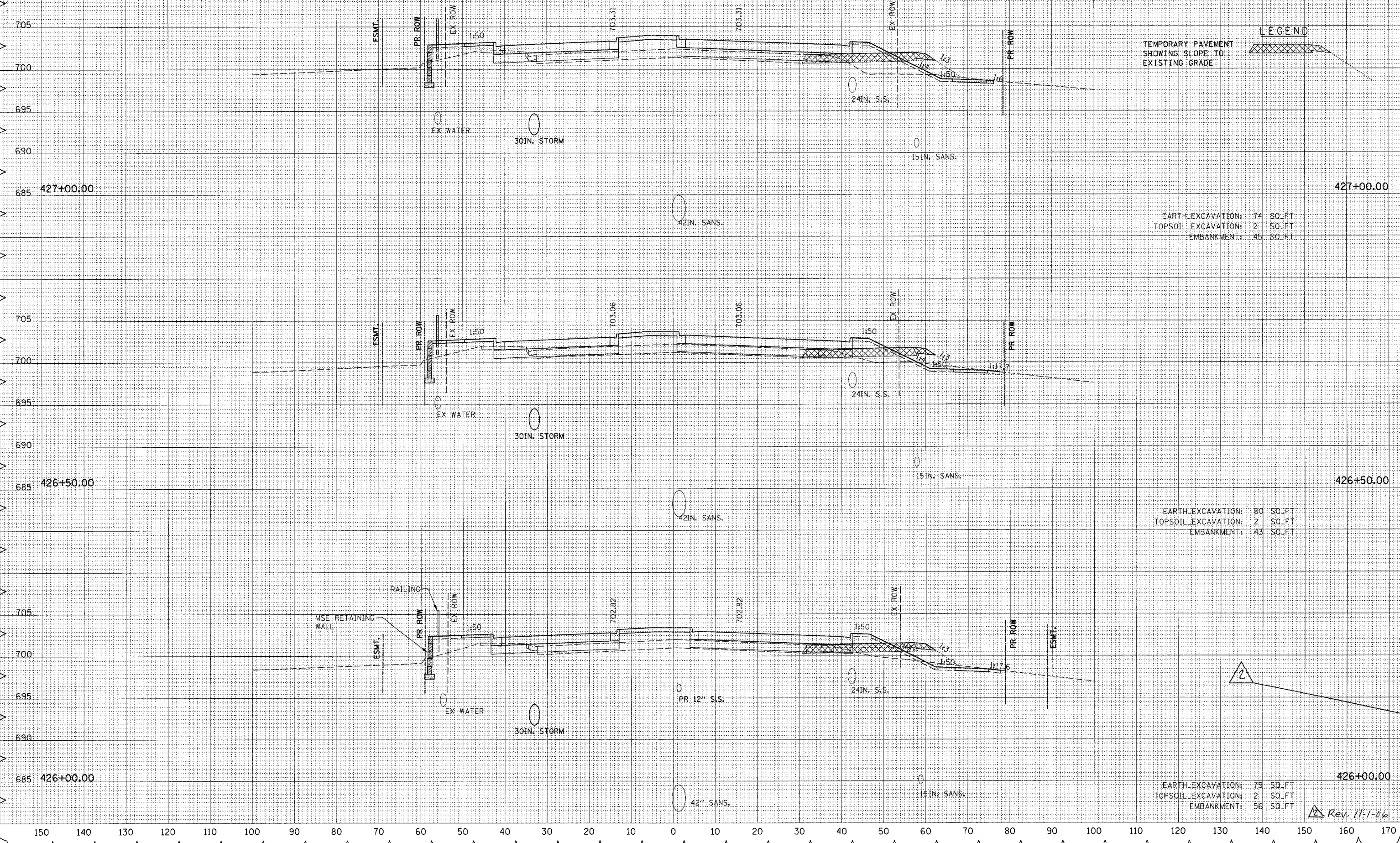

EARTH EXCAVATION: 74 SQ.FT
 TOPSOIL EXCAVATION: 2 SQ.FT
 EMBANKMENT: 45 SQ.FT

EARTH EXCAVATION: 80 SQ.FT
 TOPSOIL EXCAVATION: 2 SQ.FT
 EMBANKMENT: 43 SQ.FT

EARTH EXCAVATION: 79 SQ.FT
 TOPSOIL EXCAVATION: 2 SQ.FT
 EMBANKMENT: 56 SQ.FT

Rev. 11-1-16