

F.A. RTE.	SECTION	COUNTY	TOTAL SHEETS	SHEET NO.
351	537 R-1	COOK	245	202
STA.		TO STA.		
FED. ROAD DIST. NO.		ILLINOIS FED. AID PROJECT		
CONTRACT # 62880				

DATE
BY
REVISIONS
DESIGNED
CHECKED
DATE
BY
REVISIONS
DESIGNED
CHECKED

DATE
BY
REVISIONS
DESIGNED
CHECKED
DATE
BY
REVISIONS
DESIGNED
CHECKED

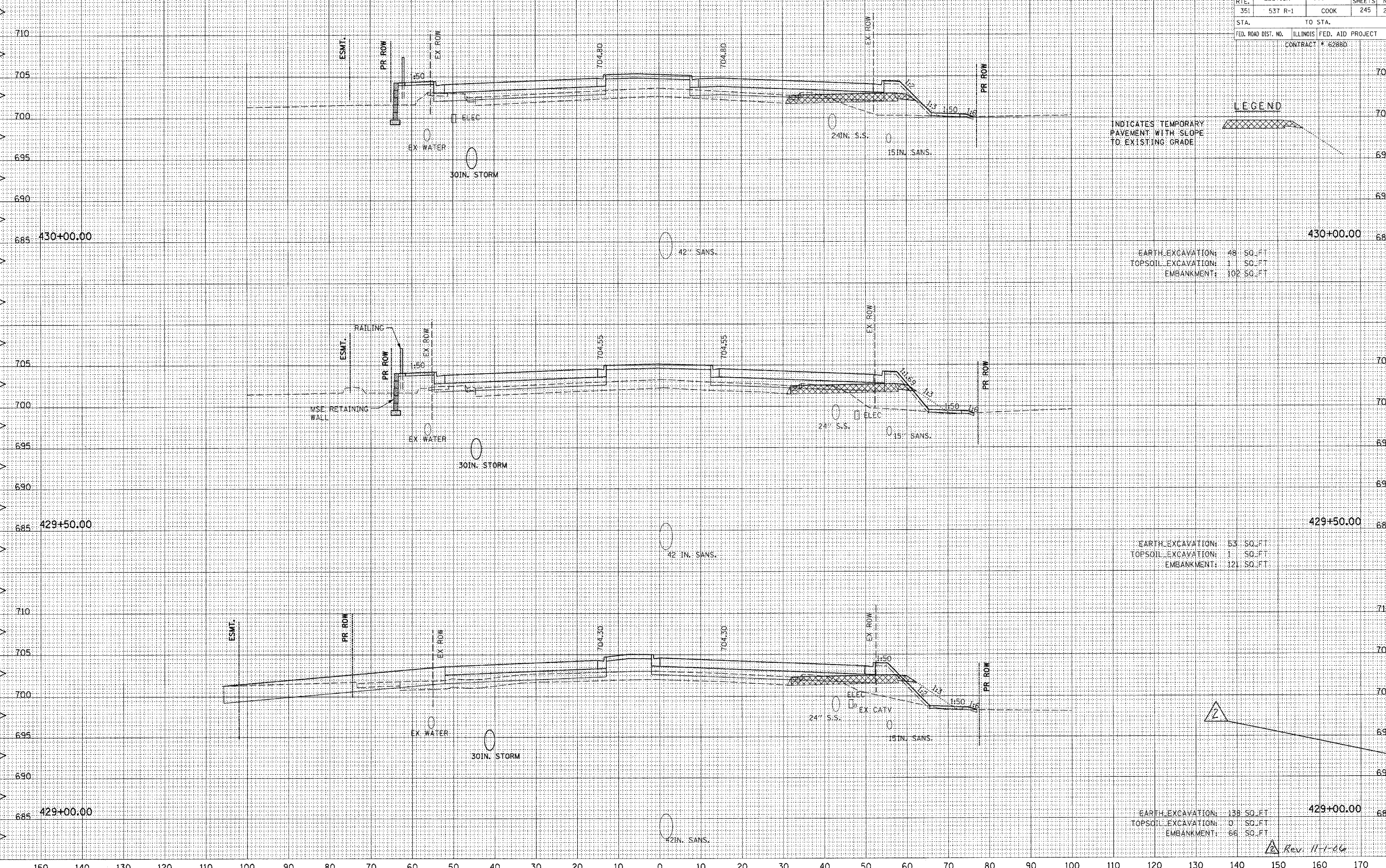

EARTH EXCAVATION: 48 SQ.FT
TOPSOIL EXCAVATION: 1 SQ.FT
EMBANKMENT: 102 SQ.FT

EARTH EXCAVATION: 53 SQ.FT
TOPSOIL EXCAVATION: 1 SQ.FT
EMBANKMENT: 121 SQ.FT

EARTH EXCAVATION: 138 SQ.FT
TOPSOIL EXCAVATION: 0 SQ.FT
EMBANKMENT: 66 SQ.FT

Rev. 11-1-06