

F.A. RTE.	SECTION	COUNTY	TOTAL SHEETS	SHEET NO.
351	537 R-1	COOK	245	212
STA. 715		TO STA.		
FED. ROAD DIST. NO.		ILLINOIS	FED. AID PROJECT	
CONTRACT # 62880				

LEGEND

TEMPORARY PAVEMENT  
SHOWING SLOPE TO  
EXISTING GRADE

EARTH EXCAVATION: 54 SQ. FT.  
TOPSOIL EXCAVATION: 0 SQ. FT.  
EMBANKMENT: 30 SQ. FT.

EARTH EXCAVATION: 57 SQ. FT.  
TOPSOIL EXCAVATION: 0 SQ. FT.  
EMBANKMENT: 35 SQ. FT.

EARTH EXCAVATION: 66 SQ. FT.  
TOPSOIL EXCAVATION: 6 SQ. FT.  
EMBANKMENT: 35 SQ. FT.

Rev. 11-1-06

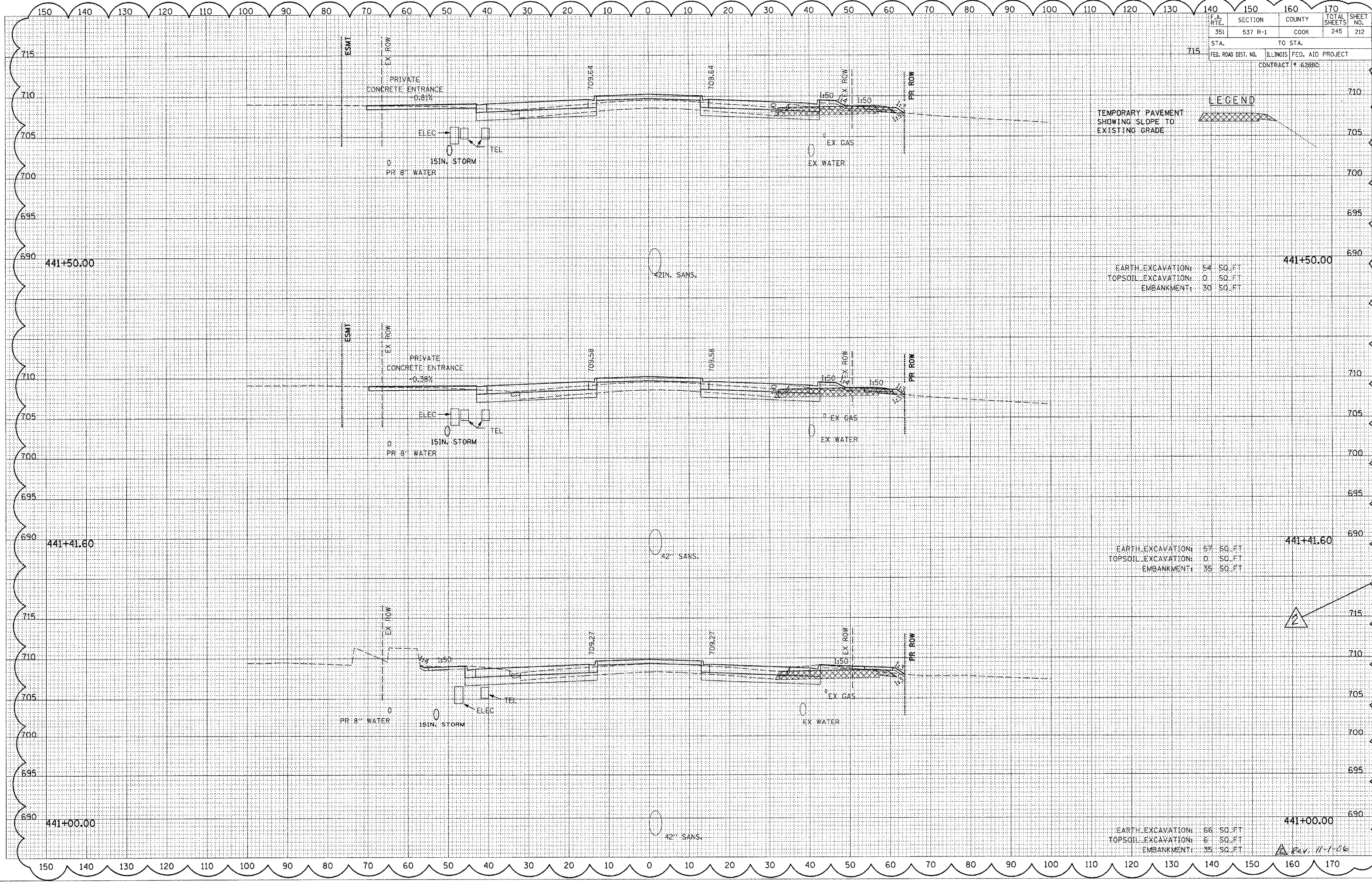

DATE	BY

DATE	BY