

150 140 130 120 110 100 90 80 70 60 50 40 30 20 10 0 10 20 30 40 50 60 70 80 90 100 110 120 130 140 150 160 170

STATE	SECTION	COUNTY	TOTAL SHEETS	SHEET NO.
351	537 R-1	COOK	245	213
STA. _____		TO STA. _____		
FED. ROAD DIST. NO. _____		ILLINOIS FED. AID PROJECT		
CONTRACT # 62880				

LEGEND

TEMPORARY PAVEMENT SHOWING SLOPE TO EXISTING GRADE

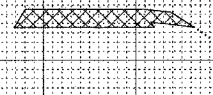

DATE
BY
REVIEWED
DATE
NO.

DATE
BY
REVIEWED
DATE
NO.

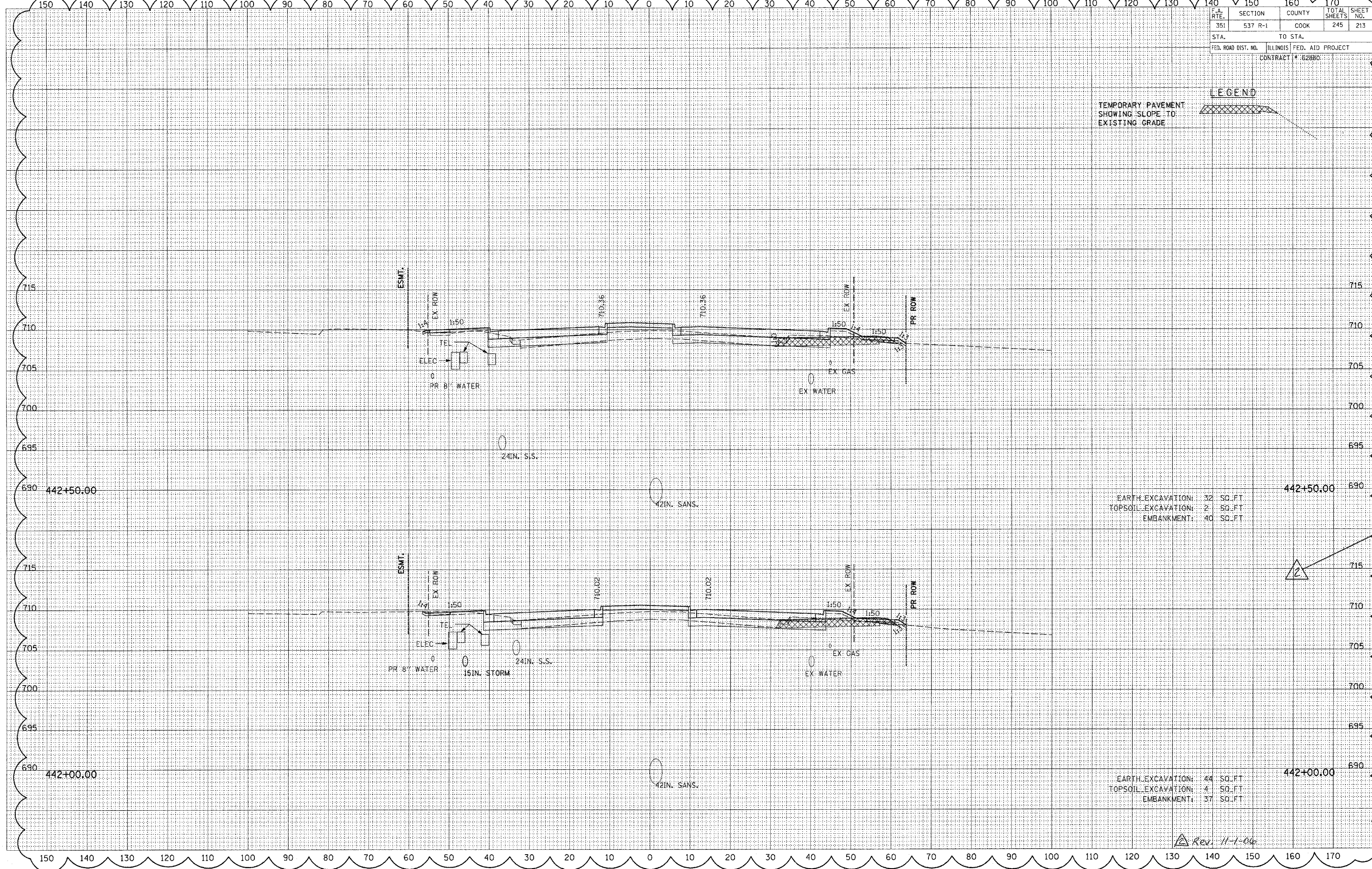

EARTH EXCAVATION: 32 SQ. FT.
 TOPSOIL EXCAVATION: 2 SQ. FT.
 EMBANKMENT: 40 SQ. FT.

EARTH EXCAVATION: 44 SQ. FT.
 TOPSOIL EXCAVATION: 4 SQ. FT.
 EMBANKMENT: 37 SQ. FT.

Rev. 11-1-06