

DATE \_\_\_\_\_  
 BY \_\_\_\_\_  
 ORIGINAL SURVEY \_\_\_\_\_  
 SURVEY PLOTTED \_\_\_\_\_  
 NOTE BOOK \_\_\_\_\_  
 AREAS CHECKED \_\_\_\_\_

DATE \_\_\_\_\_  
 BY \_\_\_\_\_  
 ORIGINAL SURVEY \_\_\_\_\_  
 SURVEY PLOTTED \_\_\_\_\_  
 NOTE BOOK \_\_\_\_\_  
 AREAS CHECKED \_\_\_\_\_

F.A. RTE.	SECTION	COUNTY	TOTAL SHEETS	SHEET NO.
351	537 R-1	COOK	245	214
STA.		TO STA.		
FED. ROAD DIST. NO.		ILLINOIS FED. AID PROJECT		
		CONTRACT # 62880		

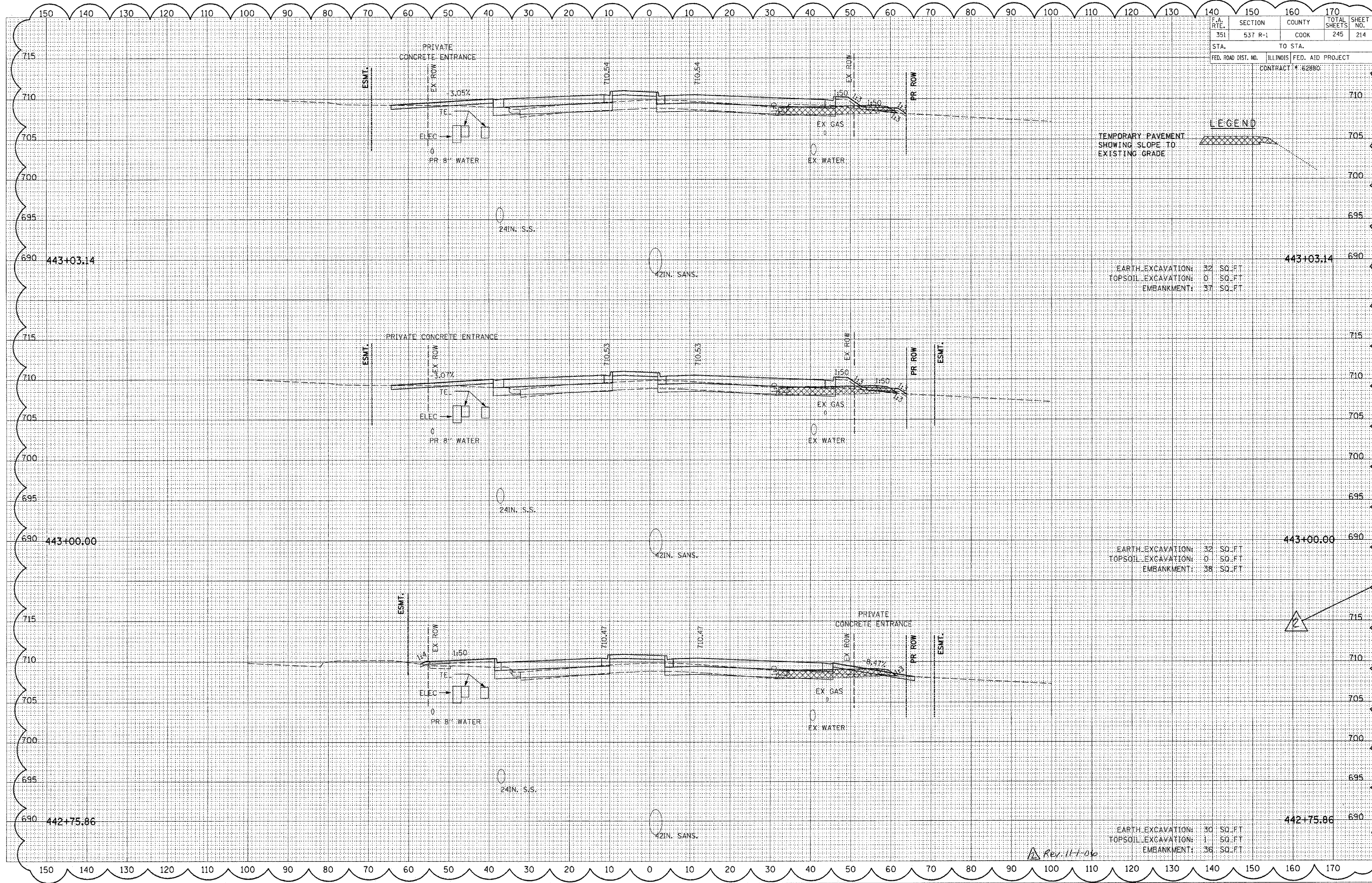

LEGEND

TEMPORARY PAVEMENT  
 SHOWING SLOPE TO  
 EXISTING GRADE

EARTH EXCAVATION: 32 SQ. FT.  
 TOPSOIL EXCAVATION: 0 SQ. FT.  
 EMBANKMENT: 37 SQ. FT.

EARTH EXCAVATION: 32 SQ. FT.  
 TOPSOIL EXCAVATION: 0 SQ. FT.  
 EMBANKMENT: 38 SQ. FT.

EARTH EXCAVATION: 30 SQ. FT.  
 TOPSOIL EXCAVATION: 1 SQ. FT.  
 EMBANKMENT: 36 SQ. FT.

Rev. 11-1-06