

DATE \_\_\_\_\_  
 BY \_\_\_\_\_  
 SUPERVISOR \_\_\_\_\_  
 CHECKED \_\_\_\_\_  
 FINAL SURVEY \_\_\_\_\_  
 NOTE BOOK \_\_\_\_\_  
 NO. \_\_\_\_\_

DATE \_\_\_\_\_  
 BY \_\_\_\_\_  
 SUPERVISOR \_\_\_\_\_  
 CHECKED \_\_\_\_\_  
 ORIGINAL SURVEY \_\_\_\_\_  
 NOTE BOOK \_\_\_\_\_  
 NO. \_\_\_\_\_

F.A. RTE.	SECTION	COUNTY	TOTAL SHEETS	SHEET NO.
351	537 R-1	COOK	245	216
STA.		TO STA.		
FED. ROAD DIST. NO.		ILLINOIS FED. AID PROJECT		
CONTRACT # 62880				

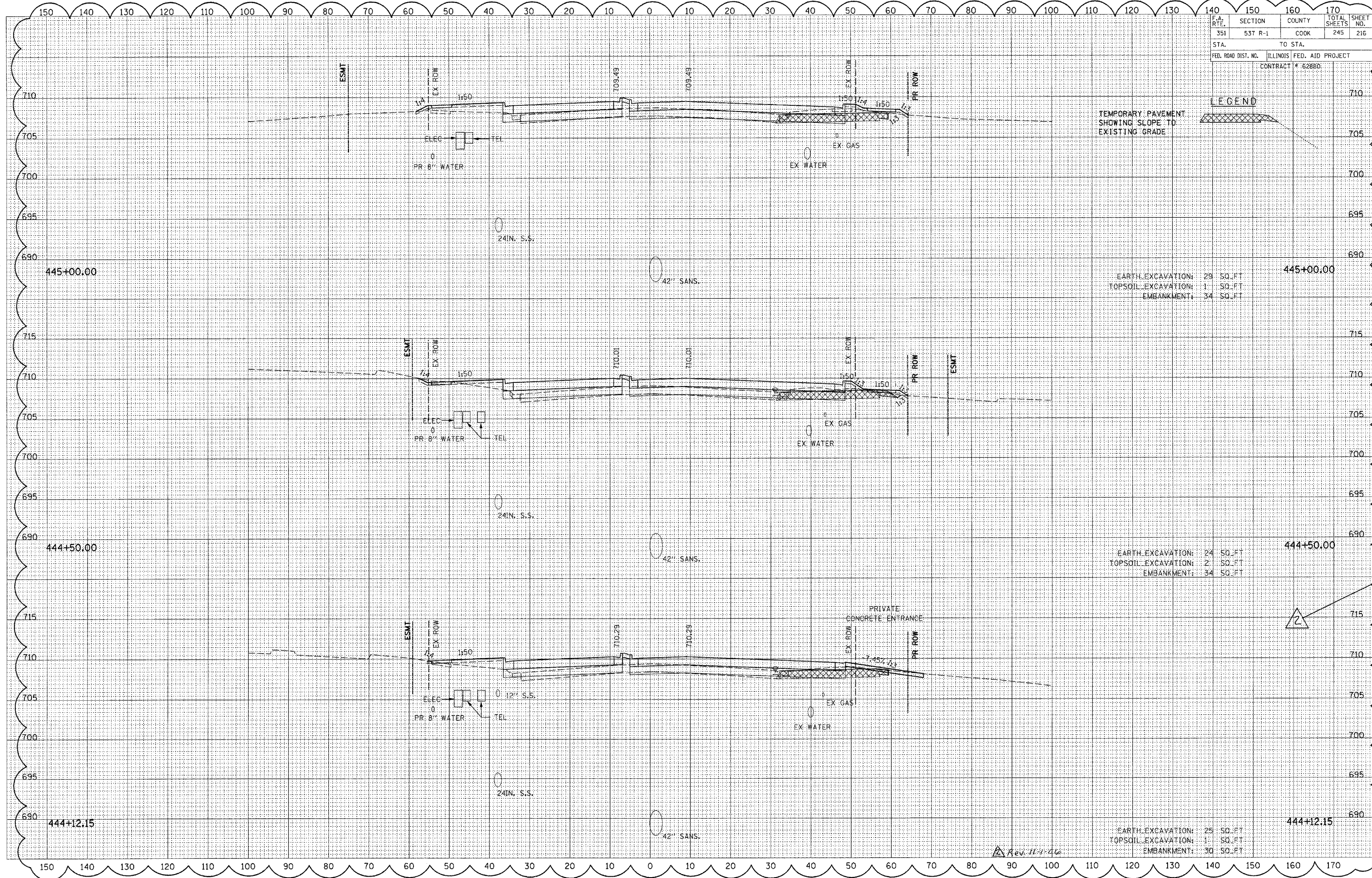

TEMPORARY PAVEMENT  
 SHOWING SLOPE TO  
 EXISTING GRADE

LEGEND

EARTH EXCAVATION: 29 SQ. FT  
 TOPSOIL EXCAVATION: 1 SQ. FT  
 EMBANKMENT: 34 SQ. FT

EARTH EXCAVATION: 24 SQ. FT  
 TOPSOIL EXCAVATION: 2 SQ. FT  
 EMBANKMENT: 34 SQ. FT

EARTH EXCAVATION: 25 SQ. FT  
 TOPSOIL EXCAVATION: 1 SQ. FT  
 EMBANKMENT: 30 SQ. FT

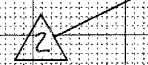

Rev. 11-1-26