

F.A. RTE.	SECTION	COUNTY	TOTAL SHEETS	SHEET NO.
351	537 R-1	COOK	245	217
STA. TO STA.		ILLINOIS FED. AID PROJECT		
CONTRACT # 62880				

DATE	BY

DATE	BY

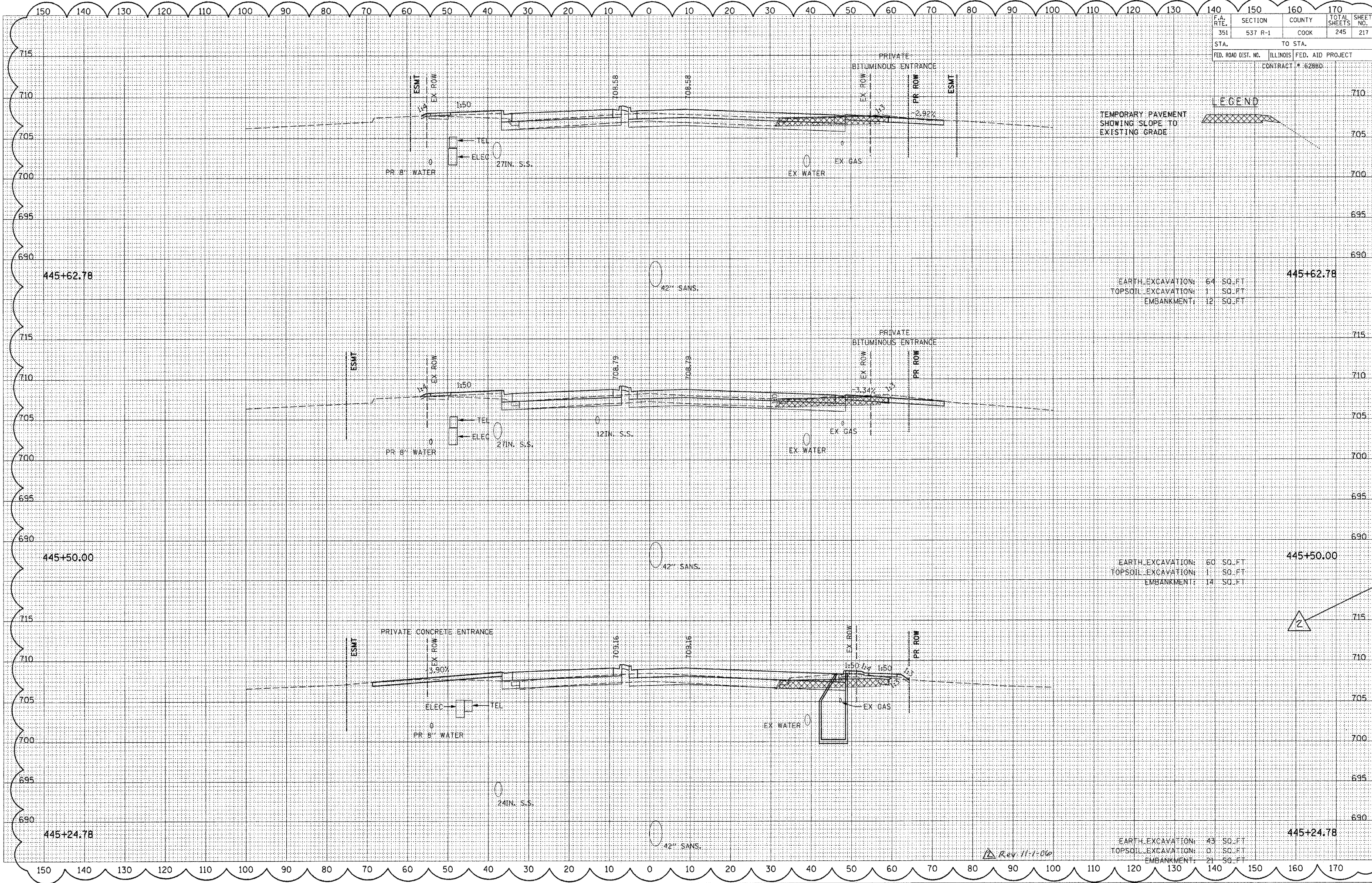

LEGEND
 TEMPORARY PAVEMENT SHOWING SLOPE TO EXISTING GRADE

445+62.78
 EARTH EXCAVATION: 64 SQ. FT.
 TOPSOIL EXCAVATION: 1 SQ. FT.
 EMBANKMENT: 12 SQ. FT.

445+50.00
 EARTH EXCAVATION: 60 SQ. FT.
 TOPSOIL EXCAVATION: 1 SQ. FT.
 EMBANKMENT: 14 SQ. FT.

445+24.78
 EARTH EXCAVATION: 43 SQ. FT.
 TOPSOIL EXCAVATION: 0 SQ. FT.
 EMBANKMENT: 21 SQ. FT.

Rev. 11-1-06