

STATE	SECTION	COUNTY	TOTAL SHEETS	SHEET NO.
ILLINOIS	537 R-1	COOK	245	30
STA. _____ TO STA. _____		FED. ROAD DIST. NO. _____ ILLINOIS FED. AID PROJECT		
CONTRACT # 62880				

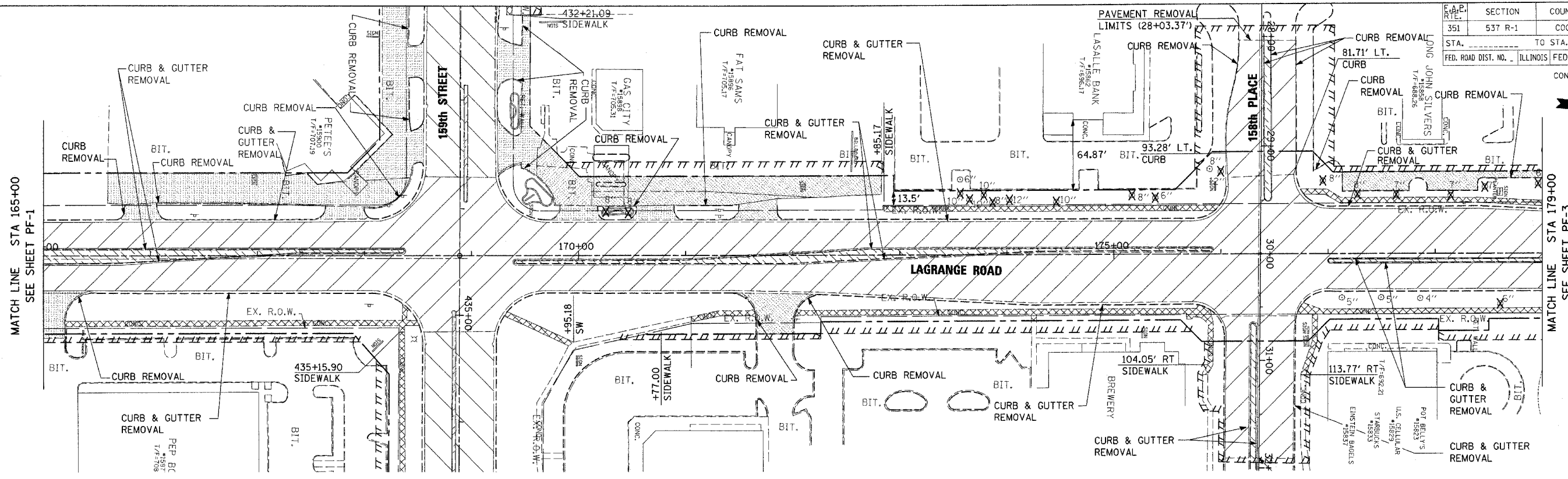

EXISTING CONDITIONS AND REMOVAL PLAN

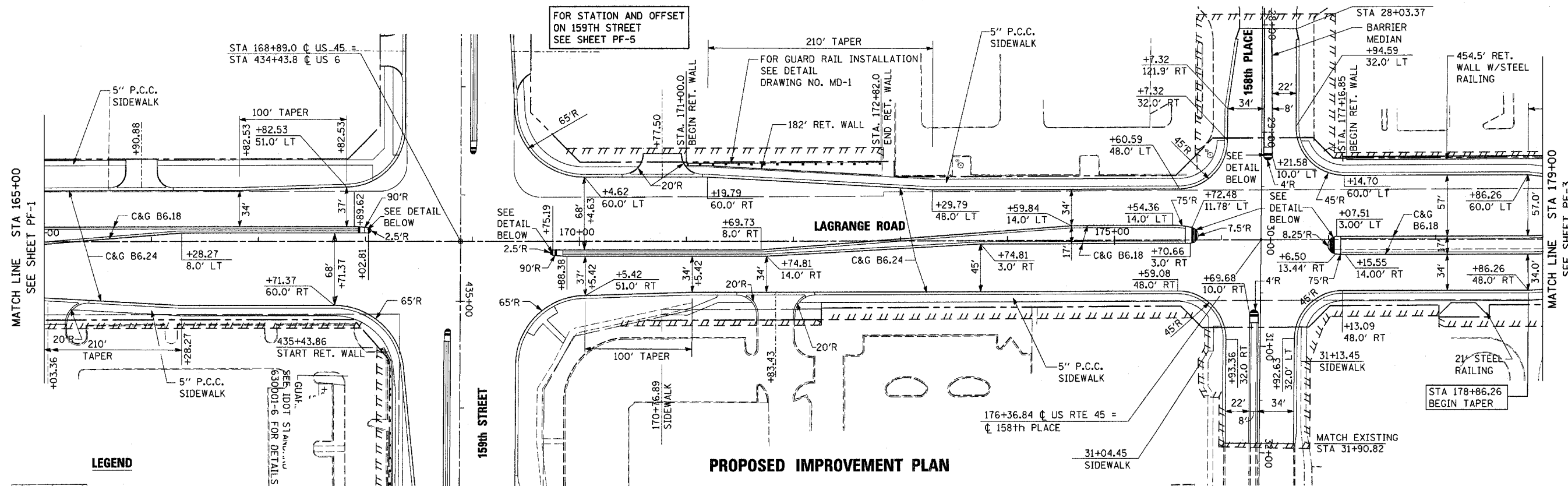

PROPOSED IMPROVEMENT PLAN

LEGEND

	PAVEMENT REMOVAL
	MEDIAN REMOVAL
	SIDEWALK REMOVAL
	CONCRETE DRIVEWAY REMOVAL (PAID AS "DRIVEWAY PAVEMENT REMOVAL")
	BITUMINOUS DRIVEWAY/PARKING REMOVAL (PAID AS "DRIVEWAY PAVEMENT REMOVAL")
	TREE REMOVAL
	TEMPORARY EASEMENT

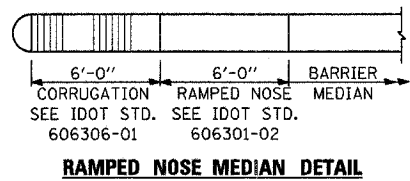

- NOTE 1:**
- ALL DRIVEWAY RECONSTRUCTION SHALL CONSIST OF PORTLAND CEMENT CONCRETE PAVEMENT 8". SEE SHEET DS-2 FOR DETAILS.
 - CONTRACTOR SHALL CONSTRUCT HANDICAP ACCESSIBILITY RAMPS AT ALL INTERSECTIONS AND DRIVEWAYS. SEE IDOT STANDARD 424001.

REVISIONS	
NAME	DATE

ILLINOIS DEPARTMENT OF TRANSPORTATION
US RTE 6 (159TH ST) AT US RTE 45 (LAGRANGE RD)
US RTE 45 (LAGRANGE ROAD)
EXISTING AND PROPOSED PLAN
STA 165+00 TO STA 179+00

SCALE: 1"=50'
DATE: 7-07-06

DRAWN BY: JTF
CHECKED BY: RCH

McDonough Associates Inc.
Engineers / Architects

I:\Dgn\pr010002.sht
7/31/2006
12:07:33 PM