

STATE	SECTION	COUNTY	TOTAL SHEETS	SHEET NO.
351	537 R-1	COOK	245	79
STA. _____		TO STA. _____		
FED. ROAD DIST. NO. _____		ILLINOIS FED. AID PROJECT		

CONTRACT # 62880

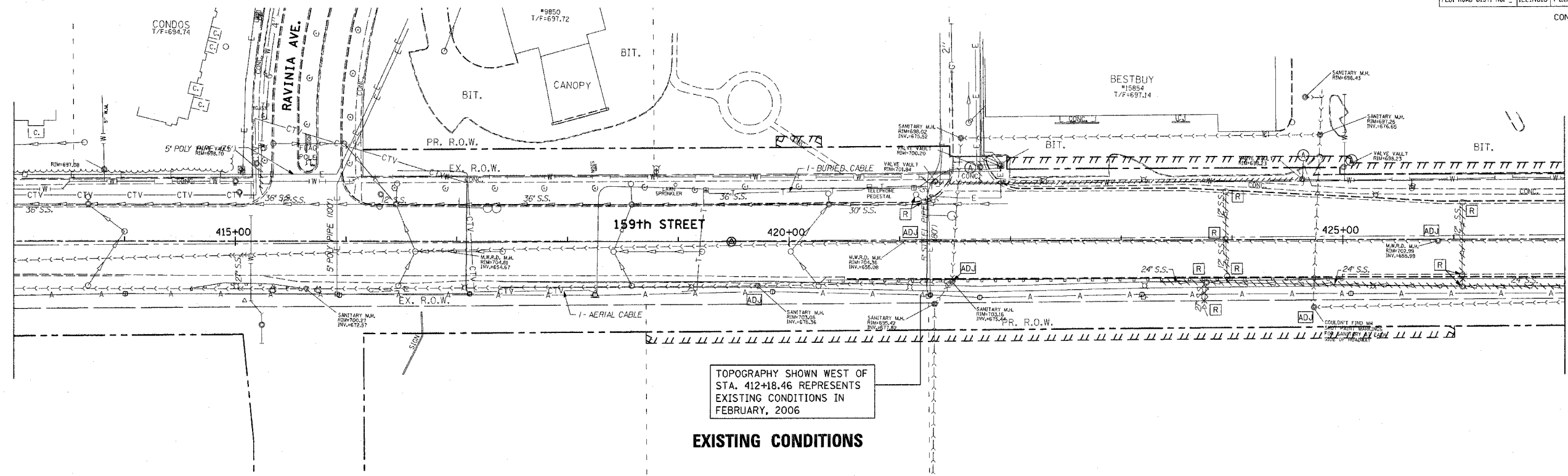

TOPOGRAPHY SHOWN WEST OF STA. 412+18.46 REPRESENTS EXISTING CONDITIONS IN FEBRUARY, 2006

EXISTING CONDITIONS

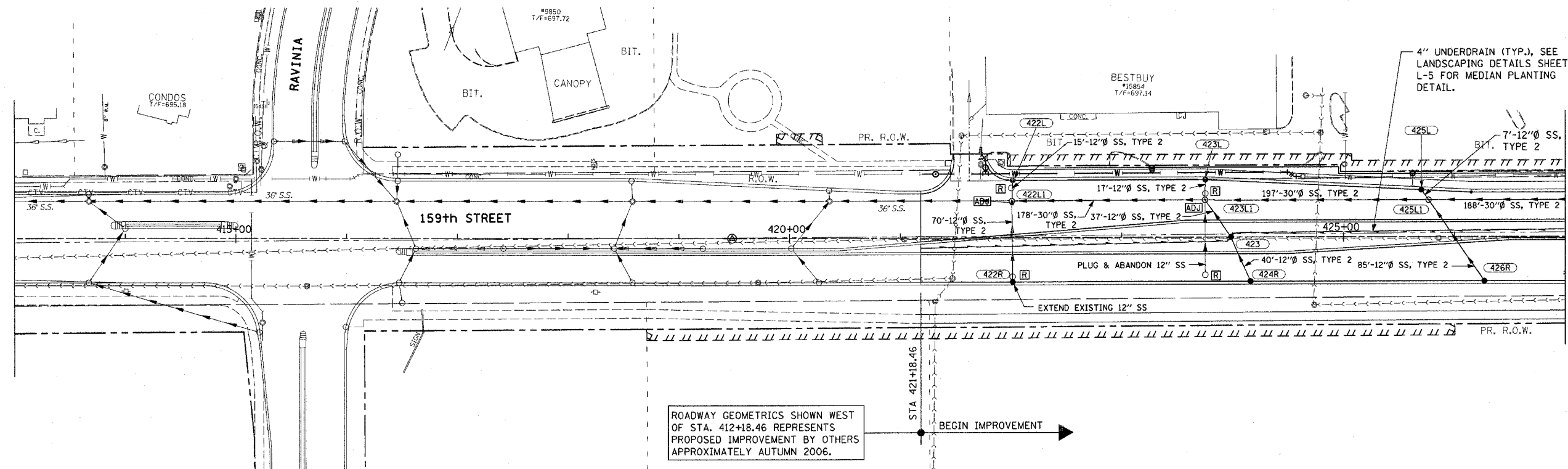

ROADWAY GEOMETRICS SHOWN WEST OF STA. 412+18.46 REPRESENTS PROPOSED IMPROVEMENT BY OTHERS APPROXIMATELY AUTUMN 2006.

PROPOSED IMPROVEMENTS

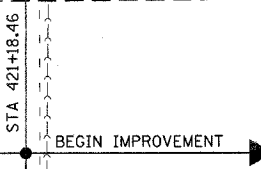

SEE DRAWING DU-15 TO DU-18 FOR WATER MAIN RELATED ITEMS

REVISIONS	
NAME	DATE

ILLINOIS DEPARTMENT OF TRANSPORTATION
 US RTE 6 (159TH ST) AT US RTE 45 (LAGRANGE RD)
 US RTE 6 (159TH STREET)
 DRAINAGE AND UTILITY PLAN
 STA 421+18.46 TO STA 427+00
 SCALE: 1"=50'
 DATE: 7-07-06
 DRAWN BY: OIU
 CHECKED BY: RCH

McDonough Associates Inc.
 Engineers / Architects

MATCH LINE STA 427+00
SEE SHEET DU-5

MATCH LINE STA 427+00
SEE SHEET DU-5

FILES
DATES
TIMES