

F.A.P. NO.	SECTION	COUNTY	TOTAL SHEETS	SHEET NO.
351	537 R-1	COOK	245	119
STA. _____ TO STA. _____		FED. AID PROJECT		
FED. ROAD DIST. NO. _____ ILLINOIS		CONTRACT # 62880		

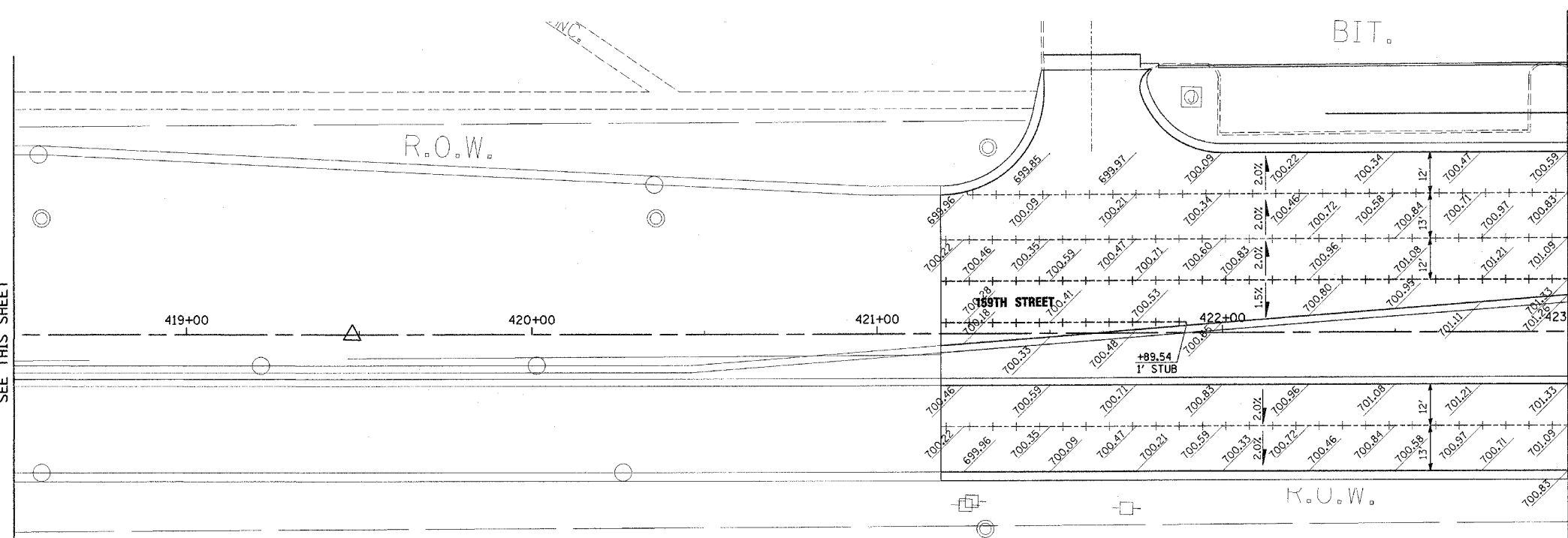
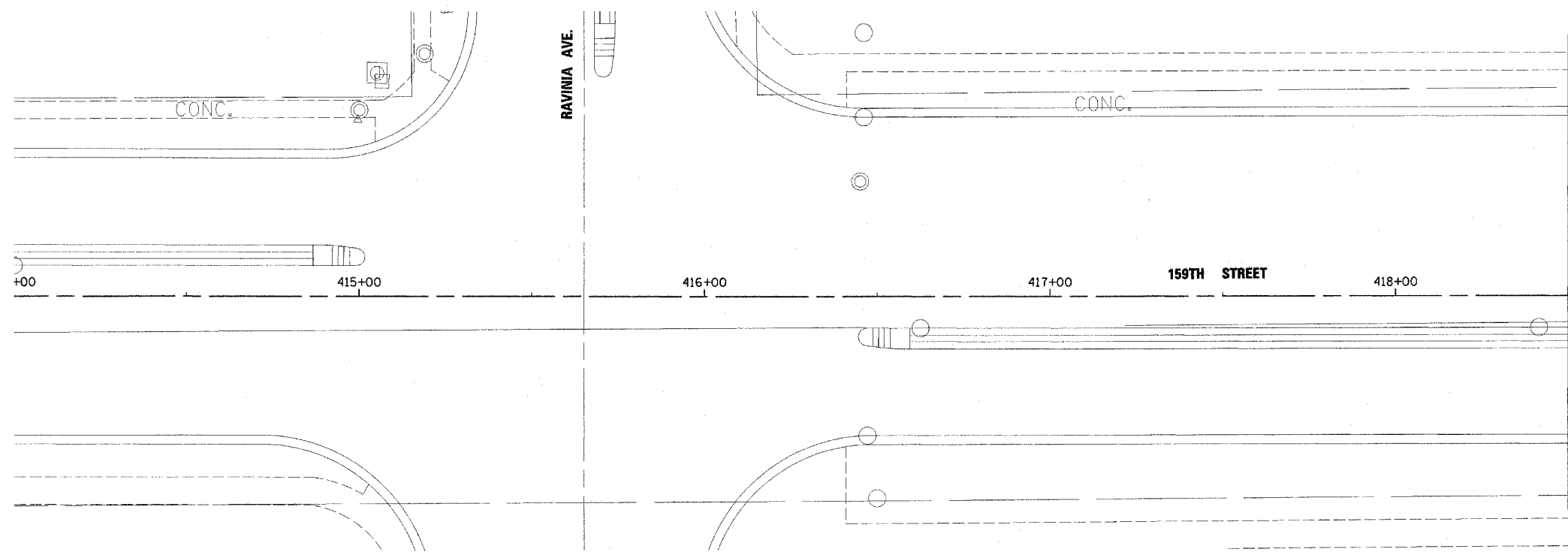

**LEGEND**

----- LONGITUDINAL CONSTRUCTION JOINT GROUDED IN PLACE, NO. 6 TIE BAR AT 24" LONG, DEFORMED (EPOXY COATED) AT 24" CENTERS

**NOTE:** TRANSVERSE CONTRACTION JOINTS SHALL BE SPACED ACCORDING TO STANDARDS 420101 AND 420106.

REVISIONS	
NAME	DATE

ILLINOIS DEPARTMENT OF TRANSPORTATION  
 US RTE 6 (159TH ST) AT US RTE 45 (LAGRANGE RD)  
 US RTE 6 (159TH STREET)  
 PAVEMENT JOINT DETAILS AND ELEVATIONS  
 STA. 414+00 TO STA 423+00  
 SCALE: 1"=20' DRAWN BY: BA  
 DATE: 7-07-06 CHECKED BY: RCH

**McDonough Associates Inc.**  
 Engineers / Architects

U:\DATA\p\01005.sh1  
 8/7/2006 4:04 PM  
 8:58:07 PM