

F.A.P. RTE.	SECTION	COUNTY	TOTAL SHEETS	SHEET NO.
351	537 R-1	COOK	245	161

STA. 165+00 TO STA. 179+00
 FED. ROAD DIST. NO. ILLINOIS FED. AID PROJECT

CONTRACT # 62880

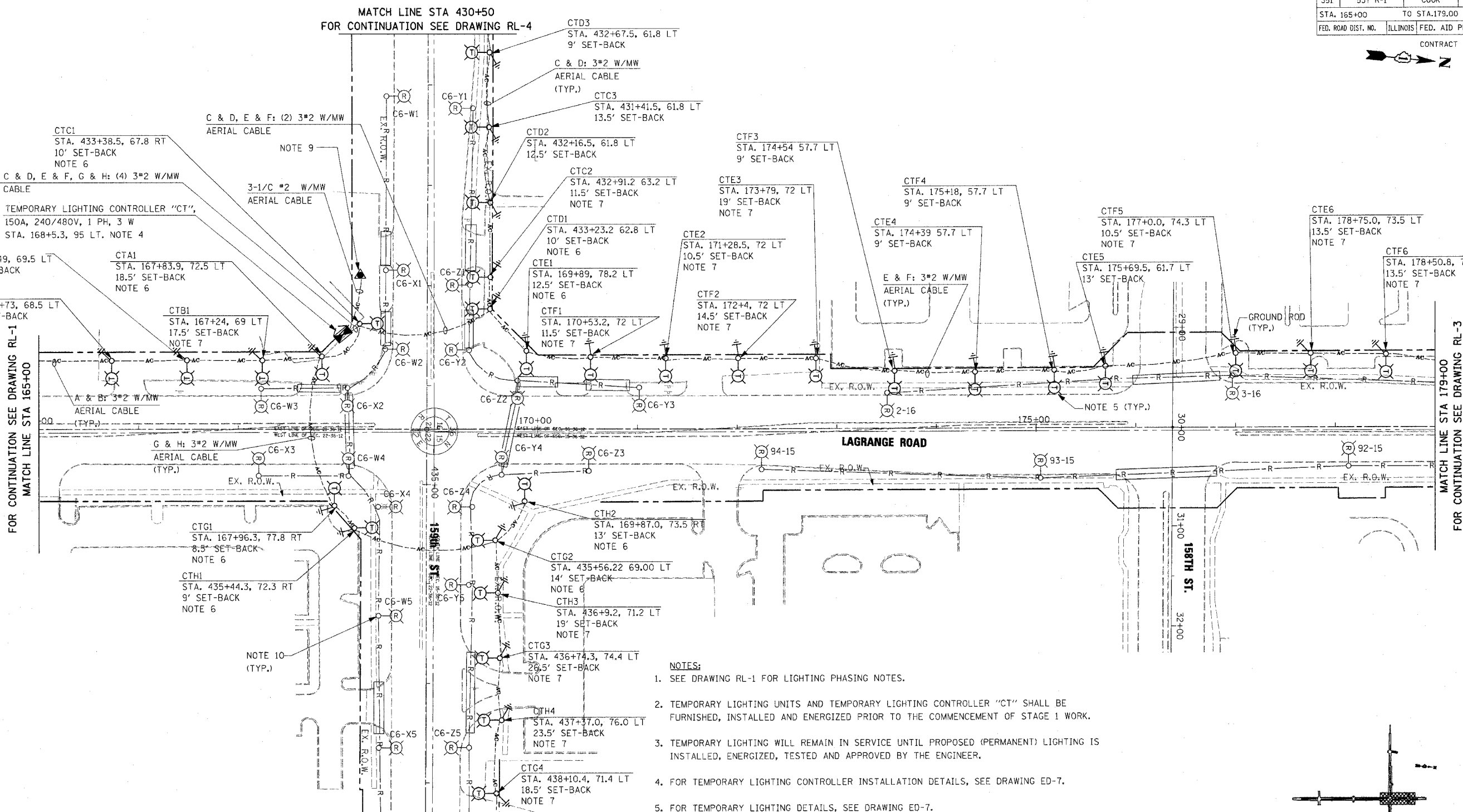

- NOTES:**
- SEE DRAWING RL-1 FOR LIGHTING PHASING NOTES.
 - TEMPORARY LIGHTING UNITS AND TEMPORARY LIGHTING CONTROLLER "CT" SHALL BE FURNISHED, INSTALLED AND ENERGIZED PRIOR TO THE COMMENCEMENT OF STAGE 1 WORK.
 - TEMPORARY LIGHTING WILL REMAIN IN SERVICE UNTIL PROPOSED (PERMANENT) LIGHTING IS INSTALLED, ENERGIZED, TESTED AND APPROVED BY THE ENGINEER.
 - FOR TEMPORARY LIGHTING CONTROLLER INSTALLATION DETAILS, SEE DRAWING ED-7.
 - FOR TEMPORARY LIGHTING DETAILS, SEE DRAWING ED-7.
 - TEMPORARY LIGHTING LUMINAIRE, 400W SODIUM VAPOR, CUTOFF ARCHITECTURAL, WITH IES TYPE III DISTRIBUTION.
 - LUMINAIRE SHALL BE TILTED 5° FROM THE HORIZONTAL PLANE.
 - THE SET-BACK DISTANCE FOR THE TEMPORARY LIGHT POLES LOCATED WEST OF LAGRANGE RD. AND THE TEMPORARY LIGHT POLES LOCATED NORTH OF 159TH ST. IS FROM THE BACK OF THE CURB INSTALLED IN STAGE 1 OF CONSTRUCTION. THE SET-BACK DISTANCE FOR THE TEMPORARY LIGHT POLES LOCATED EAST OF LAGRANGE RD. AND THE TEMPORARY LIGHT POLES LOCATED SOUTH OF 159TH ST. IS FROM THE EDGE OF TEMPORARY PAVEMENT INSTALLED IN PRE-STAGE 1 OF CONSTRUCTION.
 - ELECTRIC UTILITY SERVICE DROP, 240/480V, 1-PHASE, 3-WIRE SERVICE. EXACT LOCATION OF SERVICE POLE AND THE UTILITY SERVICE DROP TO BE DETERMINED IN THE FIELD.

10. EXISTING LIGHT POLE FOUNDATIONS SHALL BE REMOVED IN ACCORDANCE WITH IDOT STANDARD SPECIFICATIONS.

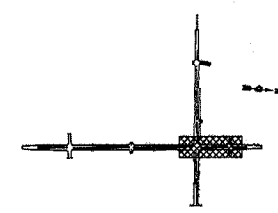
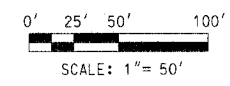

KEY PLAN

RL-2

REVISIONS		NAME	DATE
NO.	DESCRIPTION		

ILLINOIS DEPARTMENT OF TRANSPORTATION
 US RTE 6 (159TH ST) AT US RTE 45 (LAGRANGE RD)
**LAGRANGE ROAD (US45)
 TEMPORARY LIGHTING AND REMOVAL PLAN
 STA 165+00 TO STA 179+00**
 SCALE: 1" = 50' DRAWN BY: MB
 DATE: 7-07-06 CHECKED BY: KMY

McDonough Associates Inc.
 Engineers / Architects

FILES
 SDATES
 STIMES