

F.A. RTE.	SECTION	COUNTY	TOTAL SHEETS	SHEET NO.
			245	210
STA.		TO STA.		
FED. ROAD DIST. NO.		ILLINOIS FED. AID PROJECT		
<b>62880</b>				

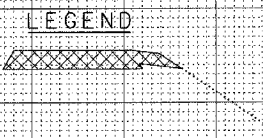

TEMPORARY PAVEMENT  
SHOWING SLOPE TO  
EXISTING GRADE

DATE	BY
DATE	BY
DATE	BY

DATE	BY
DATE	BY
DATE	BY

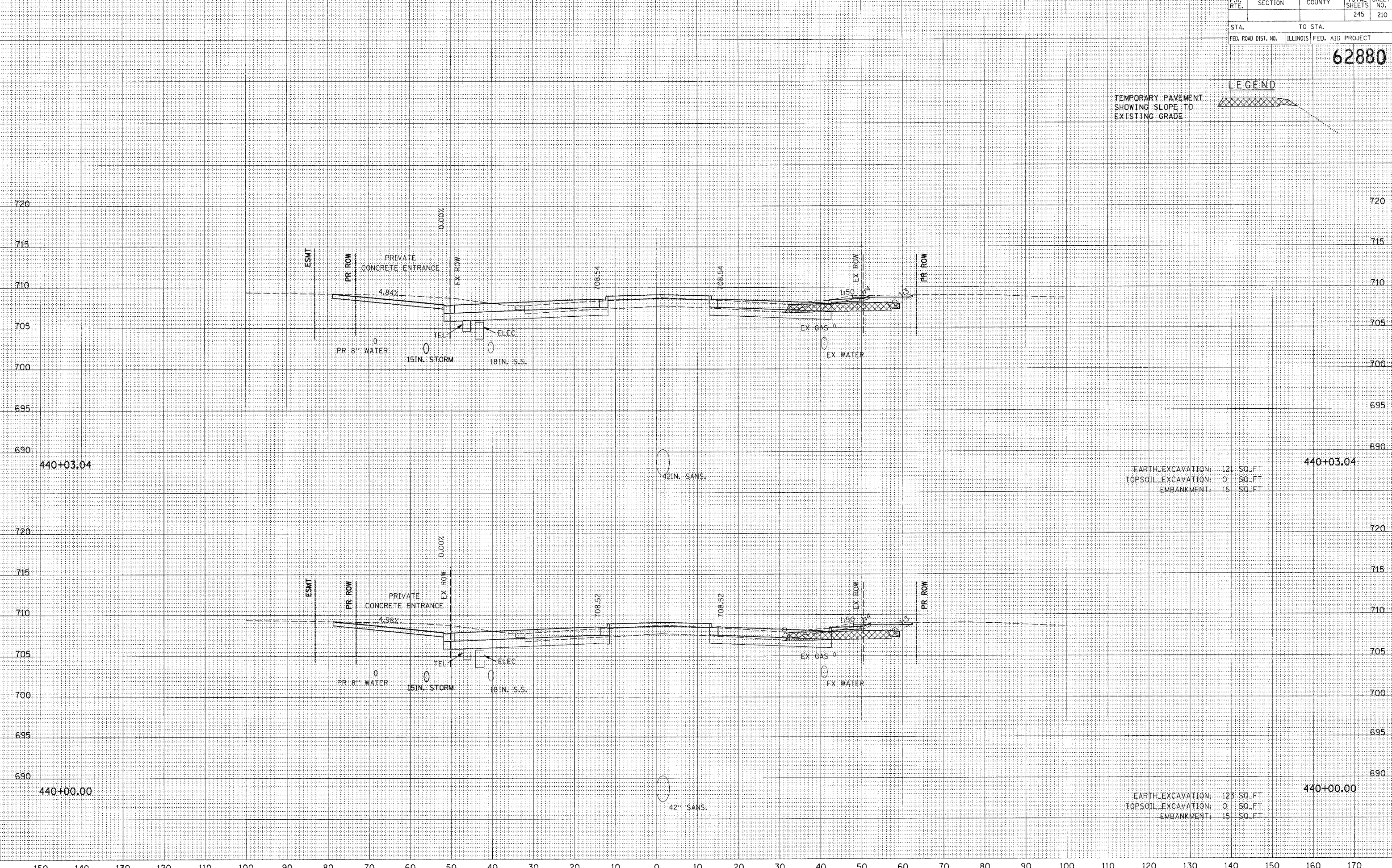

440+03.04

440+03.04

EARTH EXCAVATION: 121 SQ. FT.  
TOPSOIL EXCAVATION: 0 SQ. FT.  
EMBANKMENT: 15 SQ. FT.

440+00.00

440+00.00

EARTH EXCAVATION: 123 SQ. FT.  
TOPSOIL EXCAVATION: 0 SQ. FT.  
EMBANKMENT: 15 SQ. FT.