

EXISTING HORIZONTAL & VERTICAL CONTROL

CONTRACT #64938				
F.A.S. RTE.	SECTION	COUNTY	TOTAL SHEETS	SHEET NO.
2247	13X-BR-1	BUREAU	51	6
STA.		TO STA.		
FED. ROAD DIST. NO.		ILLINOIS	FED. AID PROJECT	

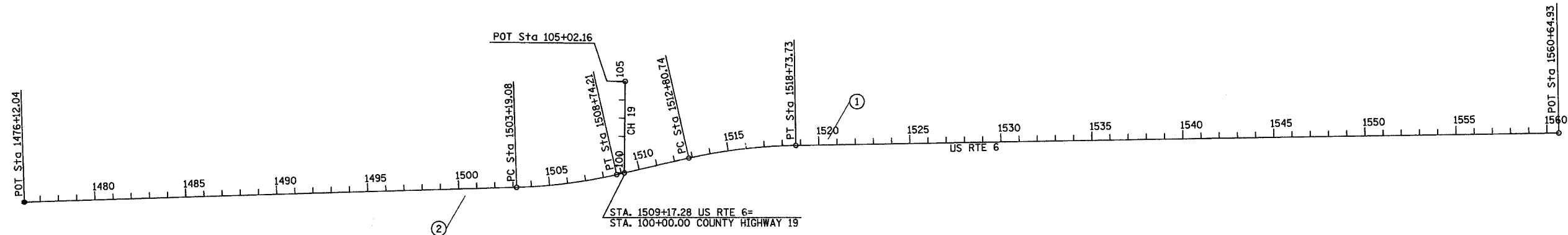

Chain ALIGN6 contains:
21 CUR 230 CUR 240 22

Beginning chain ALIGN6 description

Point 21 N 1,711,565.4400 E 2,524,111.6500 Sta 1476+12.040

Course from 21 to PC 230 N 88° 20' 06.68" E Dist 2,707.0394

Curve Data

Curve 230			
P. I. Station	1505+97.518	N 1,711,652.1752	E 2,527,095.8675
Delta	= 11° 06' 07.64" (LT)		
Degree	= 1° 59' 59.65"		
Tangent	= 278.4383		
Length	= 555.1332		
Radius	= 2,864.9284		
External	= 13.4987		
Long Chord	= 554.2651		
Mid. Ord.	= 13.4354		
P. C. Station	1503+19.079	N 1,711,644.0859	E 2,526,817.5467
P. T. Station	1508+74.213	N 1,711,713.7061	E 2,527,367.4220
C. C.		N 1,714,507.8050	E 2,526,734.3137
Back	= N 88° 20' 06.67" E		
Ahead	= N 77° 13' 59.03" E		
Chord Bear	= N 82° 47' 02.85" E		

Course from PT 230 to PC 240 N 77° 13' 59.08" E Dist 406.5226

Curve Data

Curve 240			
P. I. Station	1515+78.296	N 1,711,869.2984	E 2,528,054.0987
Delta	= 11° 51' 33.54" (RT)		
Degree	= 1° 59' 59.63"		
Tangent	= 297.5611		
Length	= 592.9959		
Radius	= 2,864.9344		
External	= 15.4114		
Long Chord	= 591.9379		
Mid. Ord.	= 15.3289		
P. C. Station	1512+80.735	N 1,711,803.5417	E 2,527,763.8942
P. T. Station	1518+73.731	N 1,711,874.0118	E 2,528,351.6224
C. C.		N 1,709,009.4368	E 2,528,397.0033
Back	= N 77° 13' 59.07" E		
Ahead	= N 89° 05' 32.61" E		
Chord Bear	= N 83° 09' 45.84" E		

Course from PT 240 to 22 N 89° 05' 32.65" E Dist 4,191.2034

Point 22 N 1,711,940.4000 E 2,532,542.3000 Sta 1560+64.934

Ending chain ALIGN6 description

Chain ALIGNCH contains:
23 24

Beginning chain ALIGNCH description

Point 23 N 1,711,723.2230 E 2,527,409.4240 Sta 100+00.000

Course from 23 to 24 N 0° 35' 48.29" E Dist 502.1592

Point 24 N 1,712,225.3550 E 2,527,414.6540 Sta 105+02.159

Ending chain ALIGNCH description

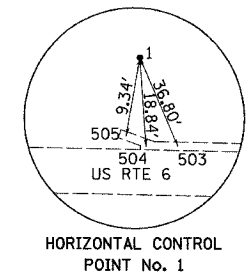
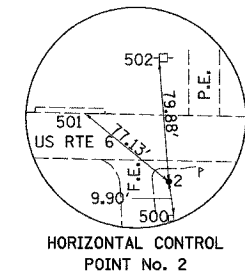

CURVE	PI	CC	PC	PT
230	230	231	232	233
240	240	241	242	243

POINT	CHAIN	STATION	OFFSET	DESCRIPTION
500	ALIGN6	1500+34.09	49.88' RT.	RAILROAD TIE GATE POST
501	ALIGN6	1500+52.55	37.68' LT.	SURVEY NAIL BETWEEN BIT. & CONC. GUTTER
502	ALIGN6	1499+82.20	16.89' LT.	SURVEY NAIL IN POWER POLE
503	ALIGN6	1520+86.23	18.83' LT.	CHISELED X IN CONC. GUTTER
504	ALIGN6	1520+62.77	17.19' LT.	CHISELED X IN CONC. GUTTER
505	ALIGN6	1520+49.15	23.95' LT.	CHISELED X IN CONC. GUTTER

POINT	NORTH	EAST	ELEVATION	CHAIN	STATION	OFFSET	DESCRIPTION
1	1711909.606	2528529.487	666.392	ALIGN6	1520+52.14	32.77' LT.	REBAR WITH RED AMERICAN SURVEY CONSULTANT CAP
2	1711595.786	2526534.026	672.196	ALIGN6	1500+34.28	40.04' RT.	REBAR WITH RED AMERICAN SURVEY CONSULTANT CAP

POINT	NORTH	EAST	ELEVATION	CHAIN	STATION	OFFSET	DESCRIPTION
400	1711759.0700	2527486.1000	632.93	ALIGN6	1509+99.98	18.02' LT	CHISELED SQUARE ON TOP OF N.W. WINGWALL
401	1712343.2400	2527434.5000	631.06	ALIGN6	1510+78.75	599.15' LT	CHISELED SQUARE ON NORTH END OF CONCRETE HEADWALL 600' ± N. OF RTE 6 E. SIDE OF 2750 N. RD. (CH 19)

FILE NAME = Z:\BUREAU\13X\BR-1\13X-BR-1.DWG
PLOT SCALE = AS NOTED
PLOT DATE = 3/08
OPERATOR = CHANS