

F.A.P. RTE.	SECTION	COUNTY	TOTAL SHEETS	SHEET NO.
627	(I-1) BR & I	LA SALLE	106	48
STA. TO STA.		ILLINOIS FED. AID PROJECT		
FED. ROAD DIST. NO.		ILLINOIS FED. AID PROJECT		

SHEET NO. F14  
OF 14 SHEETS

FED. ROAD DIST. NO.	STATE	FED. AID PROJ. NO.	FISCAL YEAR	SHEET NO.	TOTAL SHEETS
ILL	7	1918	1918	24	31

STATE OF ILLINOIS  
DEPARTMENT OF PUBLIC WORKS AND BUILDINGS  
DIVISION OF HIGHWAYS

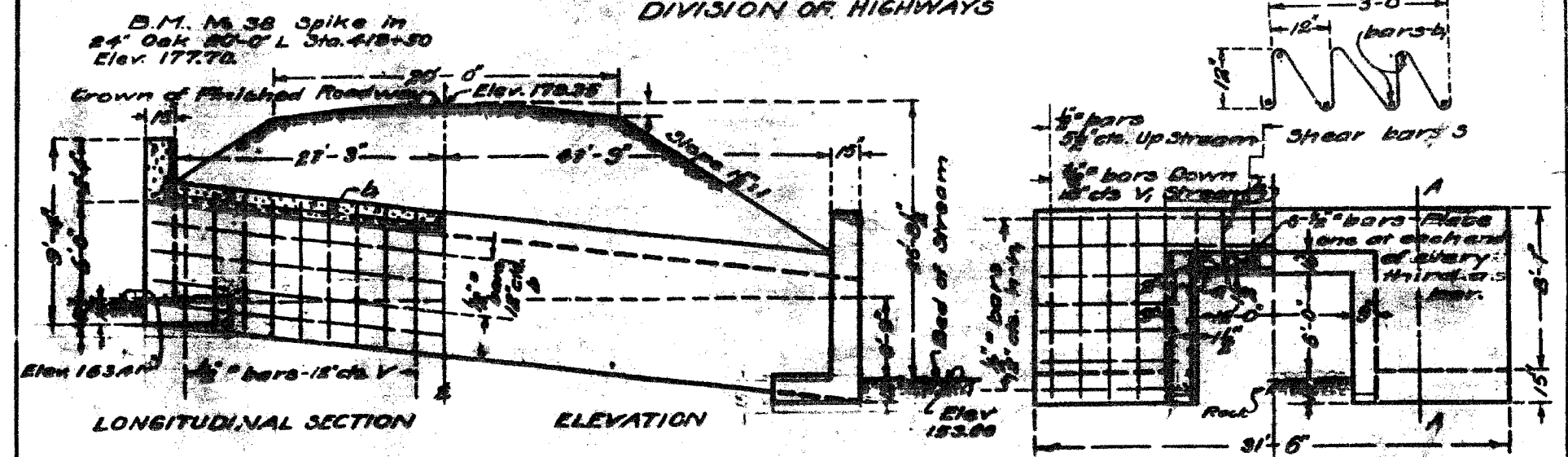

LONGITUDINAL SECTION ELEVATION

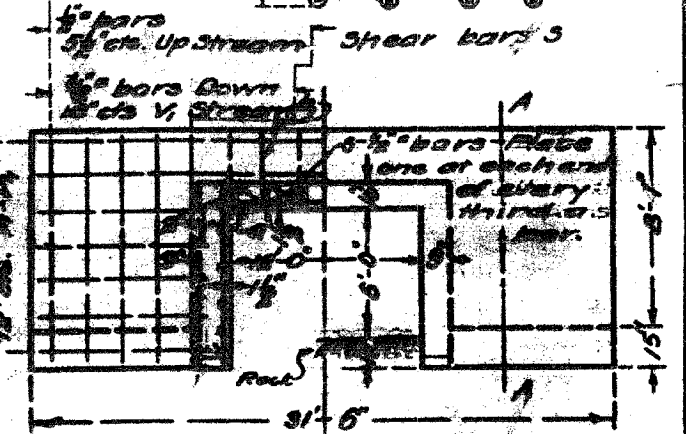

END ELEVATION

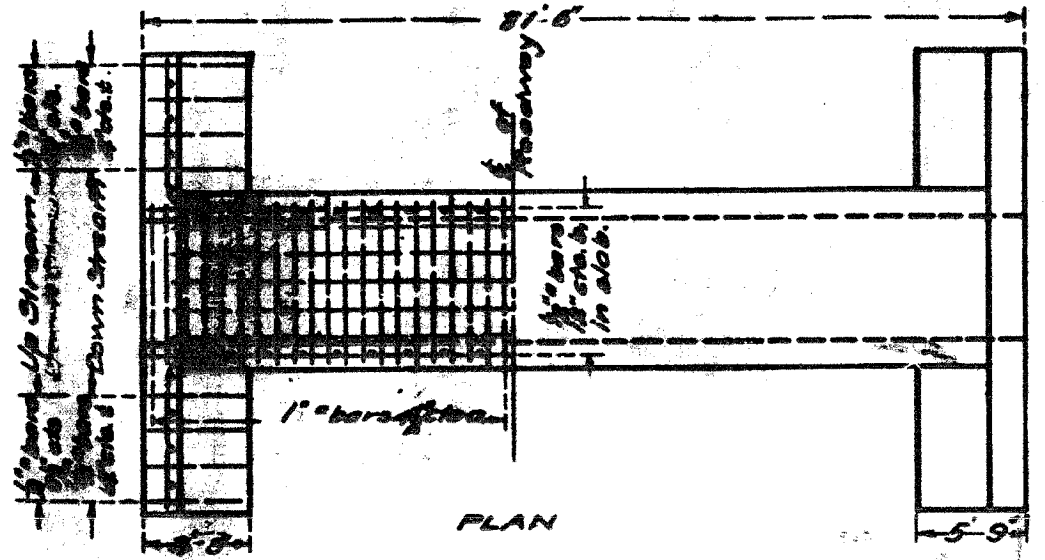

SHOWING REINFORCEMENT SHOWING OUTLINES

BILL OF MATERIAL

Dist. No.	Spec. Length	Vol.	Weight
V	12'-0"	1.00	141.43
W	12'-0"	1.00	141.43
X	12'-0"	1.00	141.43
Y	12'-0"	1.00	141.43
Z	12'-0"	1.00	141.43
AA	12'-0"	1.00	141.43
AB	12'-0"	1.00	141.43
AC	12'-0"	1.00	141.43
AD	12'-0"	1.00	141.43
AE	12'-0"	1.00	141.43
AF	12'-0"	1.00	141.43
AG	12'-0"	1.00	141.43
AH	12'-0"	1.00	141.43
AI	12'-0"	1.00	141.43
AJ	12'-0"	1.00	141.43
AK	12'-0"	1.00	141.43
AL	12'-0"	1.00	141.43
AM	12'-0"	1.00	141.43
AN	12'-0"	1.00	141.43
AO	12'-0"	1.00	141.43
AP	12'-0"	1.00	141.43
AQ	12'-0"	1.00	141.43
AR	12'-0"	1.00	141.43
AS	12'-0"	1.00	141.43
AT	12'-0"	1.00	141.43
AU	12'-0"	1.00	141.43
AV	12'-0"	1.00	141.43
AW	12'-0"	1.00	141.43
AX	12'-0"	1.00	141.43
AY	12'-0"	1.00	141.43
AZ	12'-0"	1.00	141.43
BA	12'-0"	1.00	141.43
BB	12'-0"	1.00	141.43
BC	12'-0"	1.00	141.43
BD	12'-0"	1.00	141.43
BE	12'-0"	1.00	141.43
BF	12'-0"	1.00	141.43
BG	12'-0"	1.00	141.43
BH	12'-0"	1.00	141.43
BI	12'-0"	1.00	141.43
BJ	12'-0"	1.00	141.43
BK	12'-0"	1.00	141.43
BL	12'-0"	1.00	141.43
BM	12'-0"	1.00	141.43
BN	12'-0"	1.00	141.43
BO	12'-0"	1.00	141.43
BP	12'-0"	1.00	141.43
BQ	12'-0"	1.00	141.43
BR	12'-0"	1.00	141.43
BS	12'-0"	1.00	141.43
BT	12'-0"	1.00	141.43
BU	12'-0"	1.00	141.43
BV	12'-0"	1.00	141.43
BW	12'-0"	1.00	141.43
BX	12'-0"	1.00	141.43
BY	12'-0"	1.00	141.43
BZ	12'-0"	1.00	141.43
CA	12'-0"	1.00	141.43
CB	12'-0"	1.00	141.43
CC	12'-0"	1.00	141.43
CD	12'-0"	1.00	141.43
CE	12'-0"	1.00	141.43
CF	12'-0"	1.00	141.43
CG	12'-0"	1.00	141.43
CH	12'-0"	1.00	141.43
CI	12'-0"	1.00	141.43
CJ	12'-0"	1.00	141.43
CK	12'-0"	1.00	141.43
CL	12'-0"	1.00	141.43
CM	12'-0"	1.00	141.43
CN	12'-0"	1.00	141.43
CO	12'-0"	1.00	141.43
CP	12'-0"	1.00	141.43
CQ	12'-0"	1.00	141.43
CR	12'-0"	1.00	141.43
CS	12'-0"	1.00	141.43
CT	12'-0"	1.00	141.43
CU	12'-0"	1.00	141.43
CV	12'-0"	1.00	141.43
CW	12'-0"	1.00	141.43
CX	12'-0"	1.00	141.43
CY	12'-0"	1.00	141.43
CA	12'-0"	1.00	141.43

Class A concrete to be used thruout. Proportions 1:2 1/2:4.

Sta. 417+42  
Project 7-Section I.  
Federal Aid  
Marris-Henry Road  
La Salle Co.

5B1 R1. 7-A

SPECIAL Drawn F.R. Zaher  
Checked E.C. Sumner

APPROVED: *Alfred Alder*

Examined *S. J. Sumner* 9, 1919  
Revised 11-11-19  
Bridge Engineer

FOR INFORMATIONAL  
USE ONLY

EXISTING PLANS  
IL ROUTE 71  
OVER TRIBUTARY TO ILLINOIS RIVER  
F.A.P. ROUTE 627 - SEC. (I-1) BR & I  
LA SALLE COUNTY  
STATION 416+44.62  
STRUCTURE NO. 050-C804