

BILL OF MATERIAL				
Bar No.	Size	Length (ft)	Shape	
h <sub>1</sub> (E)	#5	19'-5"		
p <sub>1</sub> (E)	#8	13'-11"		
s <sub>5</sub> (E)	#4	9'-7"		
s <sub>6</sub> (E)	#4	10'-3"		
u <sub>1</sub> (E)	#6	8'-8"		
u <sub>2</sub> (E)	#6	10'-5"		
v(E)	#5	3'-0"		
v <sub>2</sub> (E)	#5	6'-10"		
Concrete Structures			Cu. Yd.	26.7
Reinforcement Bars, Epoxy Coated			Pound	3390
Furnishing Steel Piles, HP 12x63			Ft.	96
Setting Piles in Rock			Each	6
Underwater Structure Excavation Protection, Location 1			Each	1
Bar Splicers			Each	22

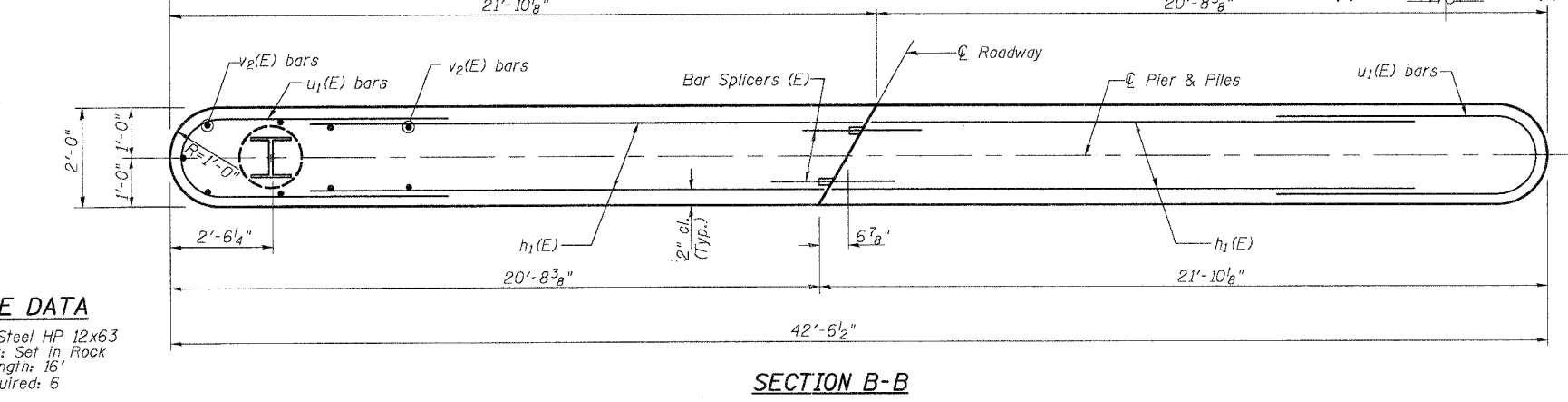
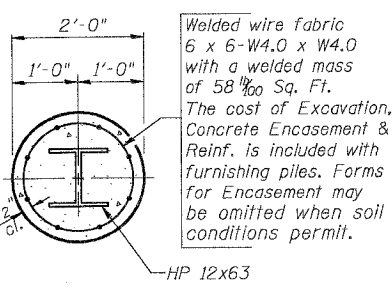
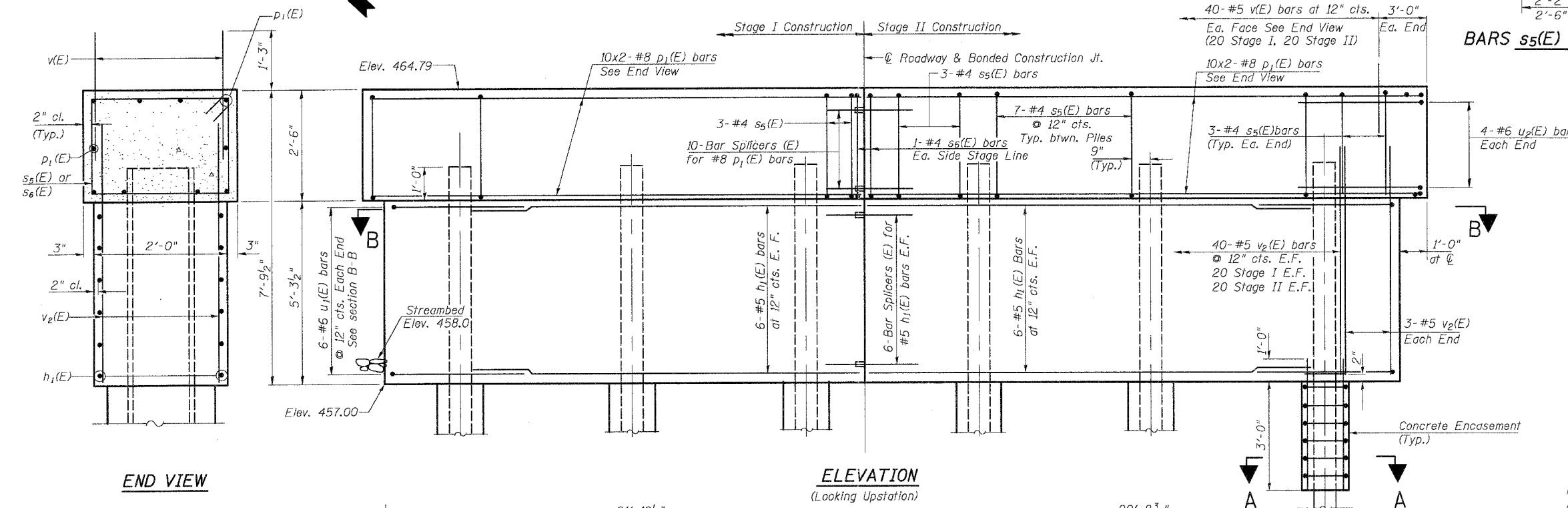

**PILE DATA**  
 Type: Steel HP 12x63  
 Capacity: Set in Rock  
 Est. Length: 16'  
 No. Required: 6

**NOTES**  
 Reinforcement bars designated (E) shall be epoxy coated.  
 All edges shall have standard 3/4" chamfers except as noted.  
 See sheet 10 of 12 for bar splicer details.  
 Piles will be set into 2'-0" diameter holes embedded 5'-0" into rock. See special provisions for Setting Piles in rock.

ILLINOIS DEPARTMENT OF TRANSPORTATION	
PIER	
PROJECT FAP ROUTE 627 (IL 71) OVER UNNAMED STREAM	PROJECT NO. 05025-1
SECTION U-BR	SCALE DATE 12/17/05
LA SALLE COUNTY	DRAWN BY TFC
STATION 98+58.9	CHECKED BY KPS/BD/MCB
STRUCTURE NUMBER 050-0243	DRAWING NO. 9
<b>COOMBE-BLOXDORF P.C.</b> Engineers / Land Surveyors Springfield, Illinois Design Firm License No. 184-002703	
OF 12 SHTS	