

STATE OF ILLINOIS  
DEPARTMENT OF TRANSPORTATION

ROUTE NO.	SECTION	COUNTY	TOTAL SHEETS	SHEET	SHEET NO. 5 313 SHEETS
F.A.I. 39	50-4B	LASALLE		27	
FED. ROAD DIST. NO. 7	ILLINOIS	FED. AID PROJECT-			

Contract # 66586

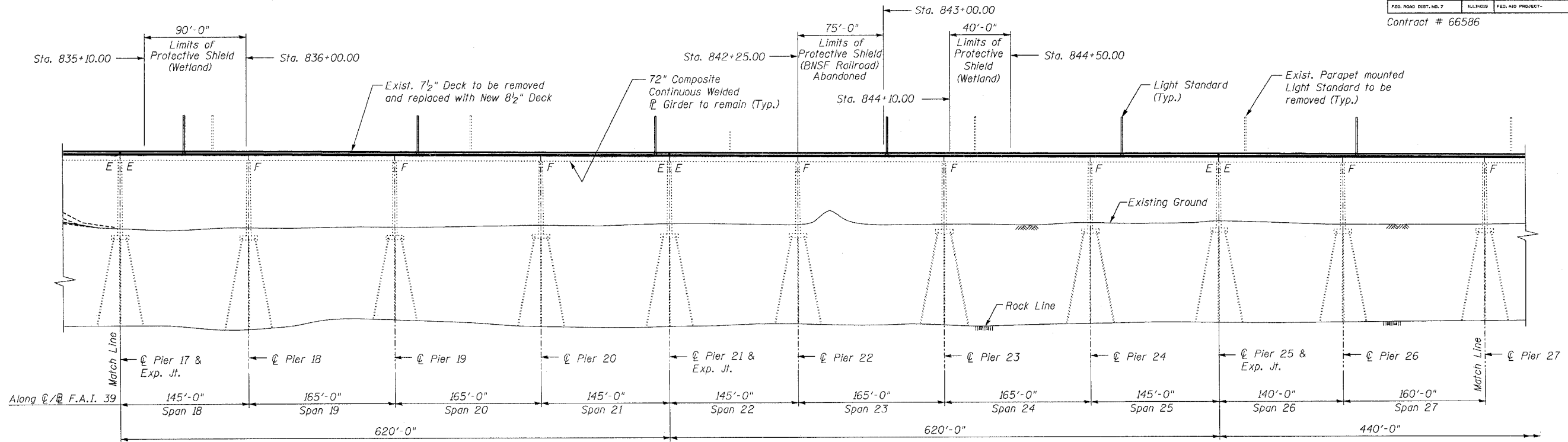

PART ELEVATION

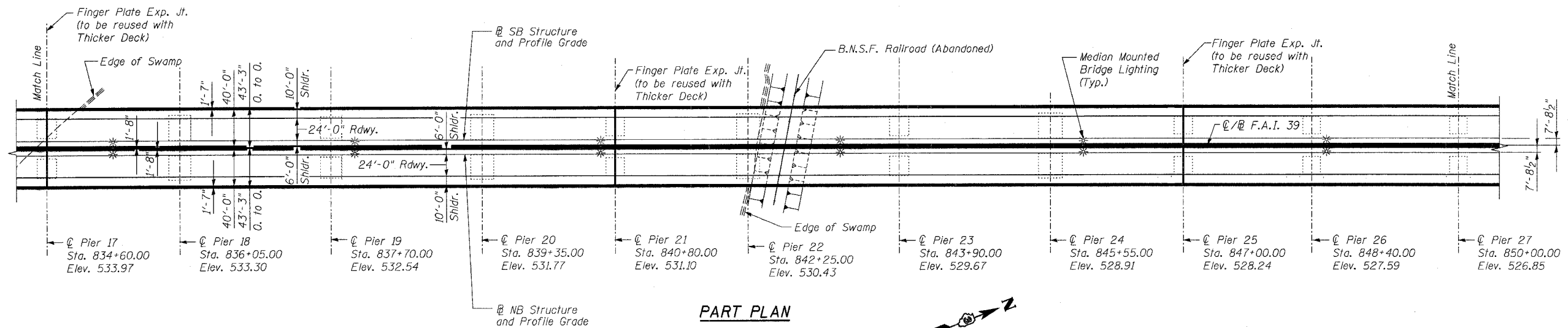

PART PLAN

NOTES:  
1. For Notes, see sheet 3.

DESIGNED -	MRB
CHECKED -	HMA
DRAWN -	VH
CHECKED -	MRB

**benesch**

alfred benesch & company  
Engineers • Surveyors • Planners  
205 North Michigan Avenue, Suite 2400  
Chicago, Illinois 60601  
312-565-0450  
Job # 3856

GENERAL PLAN AND ELEVATION - 3 OF 6  
ABRAHAM LINCOLN MEMORIAL BRIDGE OVER  
THE ILLINOIS RIVER (PUBLIC WATERS)  
F.A.I. ROUTE 39 SEC. (50-4B) BR  
LASALLE COUNTY  
STATION 863+16.00  
STRUCTURE NO. 050-0191 (SB & NB)

x:\38000s\3856\structures\dbe\lincoln\memorial\final\plans\AL-gpe03.sht

3:01:33 PM

10/16/2006