

F.A.P. RTE.	SECTION	COUNTY	TOTAL SHEETS	SHEET NO.
330	*	KANKAKEE	24	23

\* (11X-2)RS-1 & (11,1)RS-4

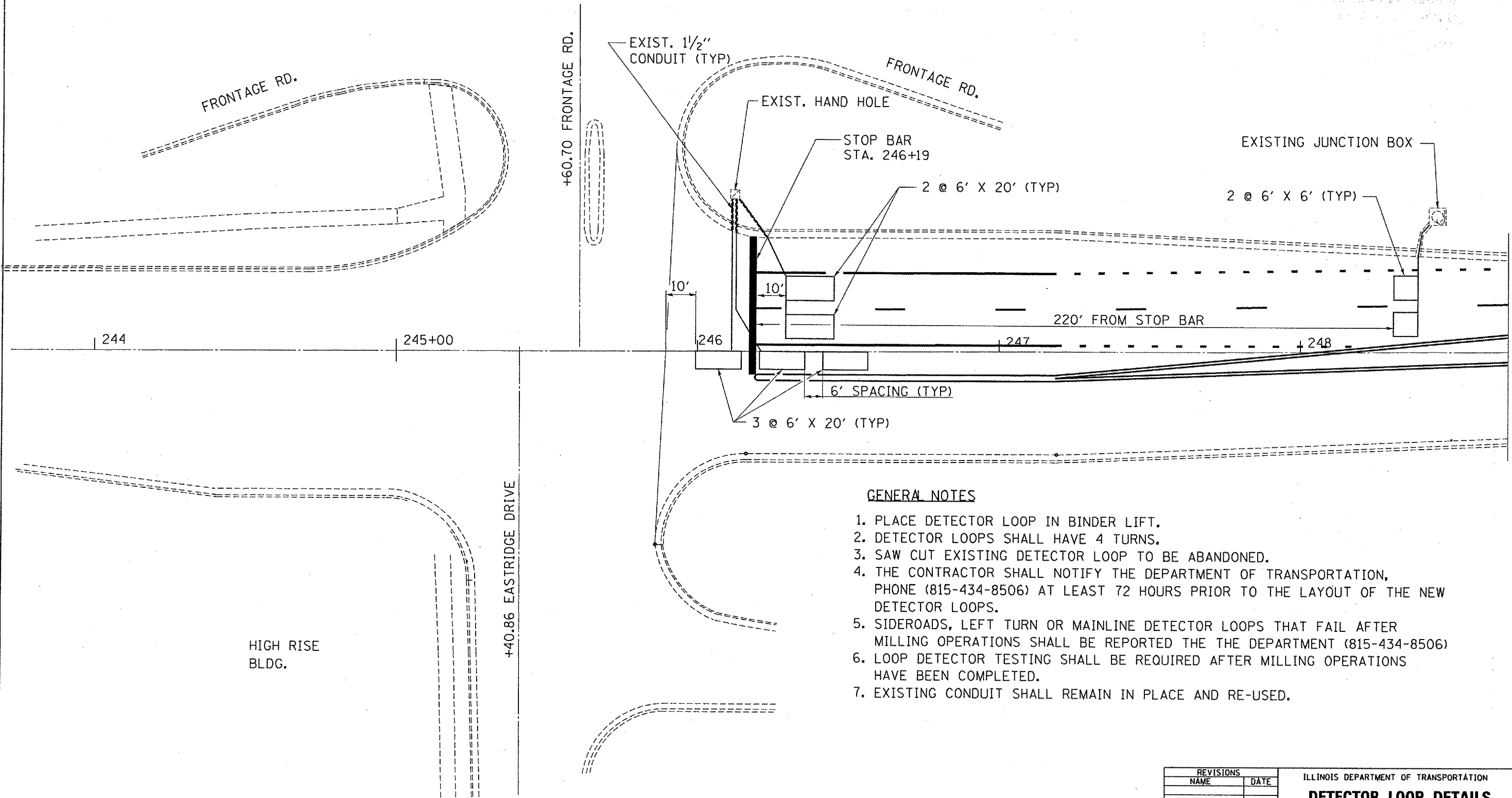

**GENERAL NOTES**

1. PLACE DETECTOR LOOP IN BINDER LIFT.
2. DETECTOR LOOPS SHALL HAVE 4 TURNS.
3. SAW CUT EXISTING DETECTOR LOOP TO BE ABANDONED.
4. THE CONTRACTOR SHALL NOTIFY THE DEPARTMENT OF TRANSPORTATION, PHONE (815-434-8506) AT LEAST 72 HOURS PRIOR TO THE LAYOUT OF THE NEW DETECTOR LOOPS.
5. SIDEROADS, LEFT TURN OR MAINLINE DETECTOR LOOPS THAT FAIL AFTER MILLING OPERATIONS SHALL BE REPORTED THE THE DEPARTMENT (815-434-8506)
6. LOOP DETECTOR TESTING SHALL BE REQUIRED AFTER MILLING OPERATIONS HAVE BEEN COMPLETED.
7. EXISTING CONDUIT SHALL REMAIN IN PLACE AND RE-USED.

REVISIONS	
NAME	DATE

ILLINOIS DEPARTMENT OF TRANSPORTATION  
**DETECTOR LOOP DETAILS**  
**EASTRIDGE DRIVE**  
 F.A.P. ROUTE 330 (IL ROUTE 17)  
 SECTION (11X-2)RS-1 & (11,1)RS-4  
 KANKAKEE COUNTY

DATE: 06/27/2006  
 c:/projects/cm305/details.dgn