

| F.A.P. RTE.         | SECTION     | COUNTY            | TOTAL SHEETS     | SHEET NO.                |
|---------------------|-------------|-------------------|------------------|--------------------------|
| 315                 | (34-6,55-1) | HANCOCK/McDONOUGH | 433              | 45                       |
| STA. 1392+00        |             | TO STA. 1407+00   |                  |                          |
| FED. ROAD DIST. NO. |             | ILLINOIS          | FED. AID PROJECT | STATE CONTRACT NO. 68206 |

PROP. CURVE IL336-1  
 PI STA. = 1399+83.51  
 $\Delta = 16^\circ 28' 12''$  (LT)  
 $D = 2^\circ 33' 00''$   
 $R = 2,246.89'$   
 $T = 325.18'$   
 $L = 645.88'$   
 $E = 23.41'$   
 $e = 5.9\%$   
 $T.R. = 39'$   
 $S.E. RUN = 265'$   
 $P.C. STA = 1396+58.32$   
 $P.T. STA = 1403+04.21$

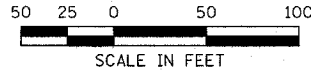
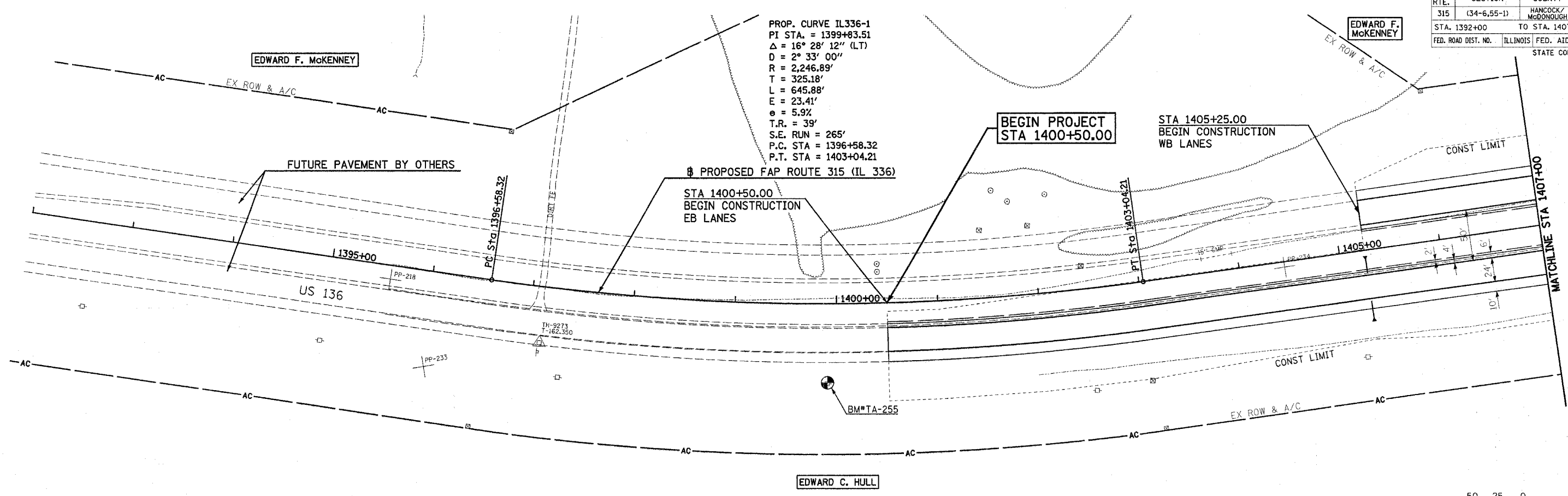

| PLAN      | DATE |
|-----------|------|
| DATE      |      |
| BY        |      |
| NO.       |      |
| FILE NAME |      |

| PROFILE   | DATE |
|-----------|------|
| DATE      |      |
| BY        |      |
| NO.       |      |
| FILE NAME |      |

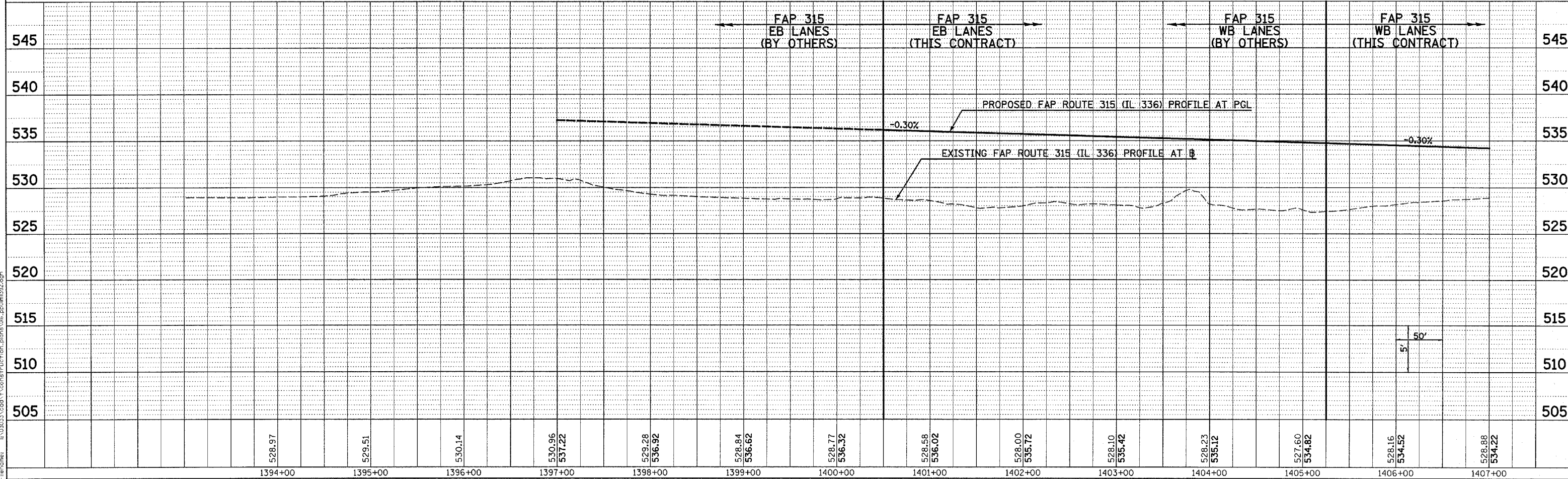

Plot Date: 7/18/2006  
 Plot Time: 3:24:35 PM  
 Plotted By: bccmndt  
 File: R:\03033\cd\1\construction\plans\06\_pp01m1992.dgn

ROADWAY PLAN & PROFILE - FAP ROUTE 315 (IL 336) STA 1392+00 TO STA 1407+00