

PROP. CURVE DETIL61-1
 PI STA. = 394+28.05
 $\Delta = 24^\circ 33' 45''$ (LT)
 $D = 9^\circ 28' 13''$
 $R = 605.00'$
 $T = 131.70'$
 $L = 259.36'$
 $E = 14.17'$
 $e = NC$
 $T.R. = N/A$
 $S.E. RUN = N/A$
 $P.C. STA. = 392+96.35$
 $P.T. STA. = 395+55.71$

PROP. CURVE DETIL61-2
 PI STA. = 397+95.76
 $\Delta = 26^\circ 04' 02''$ (RT)
 $D = 9^\circ 28' 13''$
 $R = 605.00'$
 $T = 140.05'$
 $L = 275.25'$
 $E = 16.00'$
 $e = NC$
 $T.R. = N/A$
 $S.E. RUN = N/A$
 $P.C. STA. = 396+55.71$
 $P.T. STA. = 399+30.96$

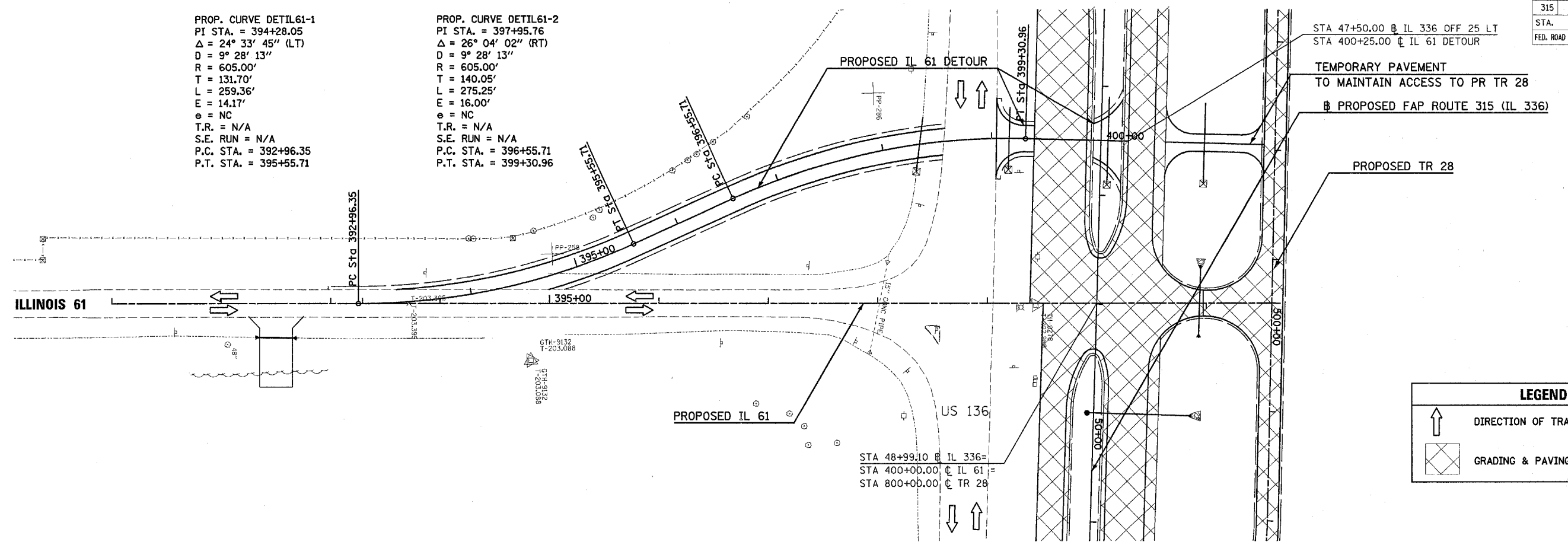

LEGEND

↑ DIRECTION OF TRAFFIC FLOW

▣ GRADING & PAVING

PLAN	DATE
SURVEYED	BY
NOTE BOOK	NO.
ALIGNED	CHECKED
FIELD FILE NAME	

PROFILE	DATE
SURVEYED	BY
NOTE BOOK	NO.
GRADES CHECKED	
FIELD FILE NAME	

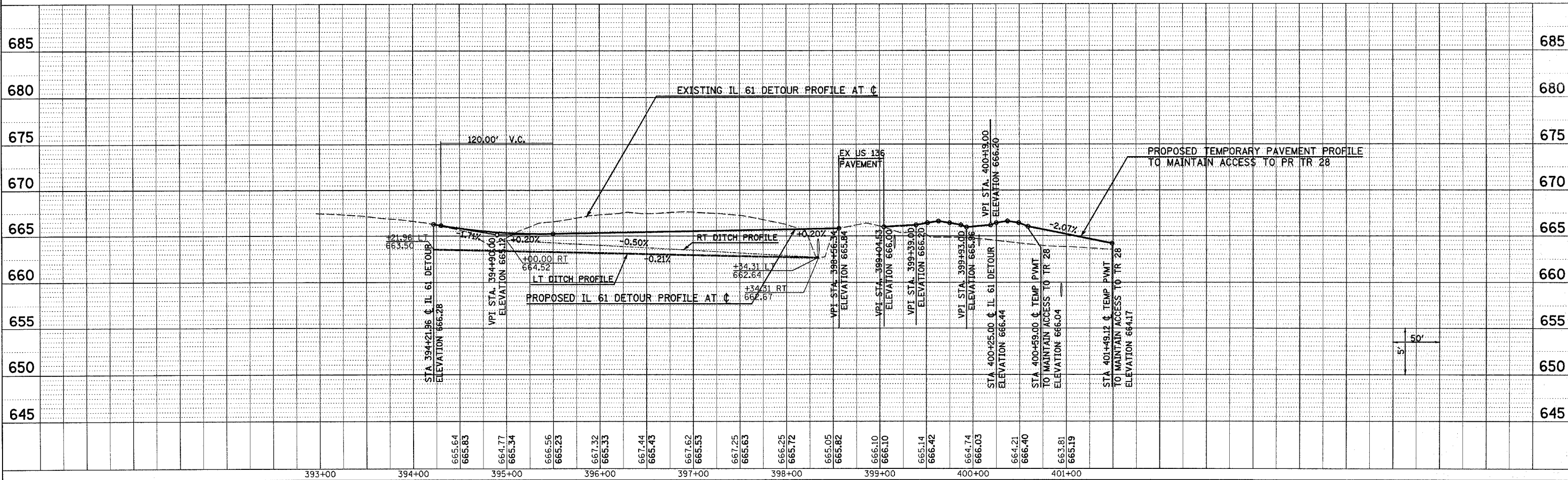

Plot Date: 7/18/2006
 Plot Time: 3:26:27 PM
 Plotted By: bschmidt
 File Name: I:\020333\road\1\construction\plans\064_c61\05\profile\detour.dgn

MAINTENANCE OF TRAFFIC (STAGE 1) ROADWAY PLAN & PROFILE - IL 61 DETOUR STA 392+96.35 TO STA 401+25