

|                          |             |                   |                  |           |
|--------------------------|-------------|-------------------|------------------|-----------|
| F.A.P. RTE.              | SECTION     | COUNTY            | TOTAL SHEETS     | SHEET NO. |
| 315                      | (34-6,55-1) | HANCOCK/MCDONOUGH | 433              | 122       |
| STA. 57+00.00            |             | TO STA. 71+50.00  |                  |           |
| FED. ROAD DIST. NO.      |             | ILLINOIS          | FED. AID PROJECT |           |
| STATE CONTRACT NO. 68206 |             |                   |                  |           |

|      |    |
|------|----|
| DATE | BY |
|      |    |
| DATE | BY |
|      |    |
| DATE | BY |
|      |    |

|      |    |
|------|----|
| DATE | BY |
|      |    |
| DATE | BY |
|      |    |
| DATE | BY |
|      |    |

Plot Date: 7/8/2006  
 Plot Time: 3:27:30 PM  
 Plotted By: bsrnmd  
 Coder: bsrnmd  
 File Name: I:\03033\cadd\construct\plan\plans\093\_du09m57.dgn

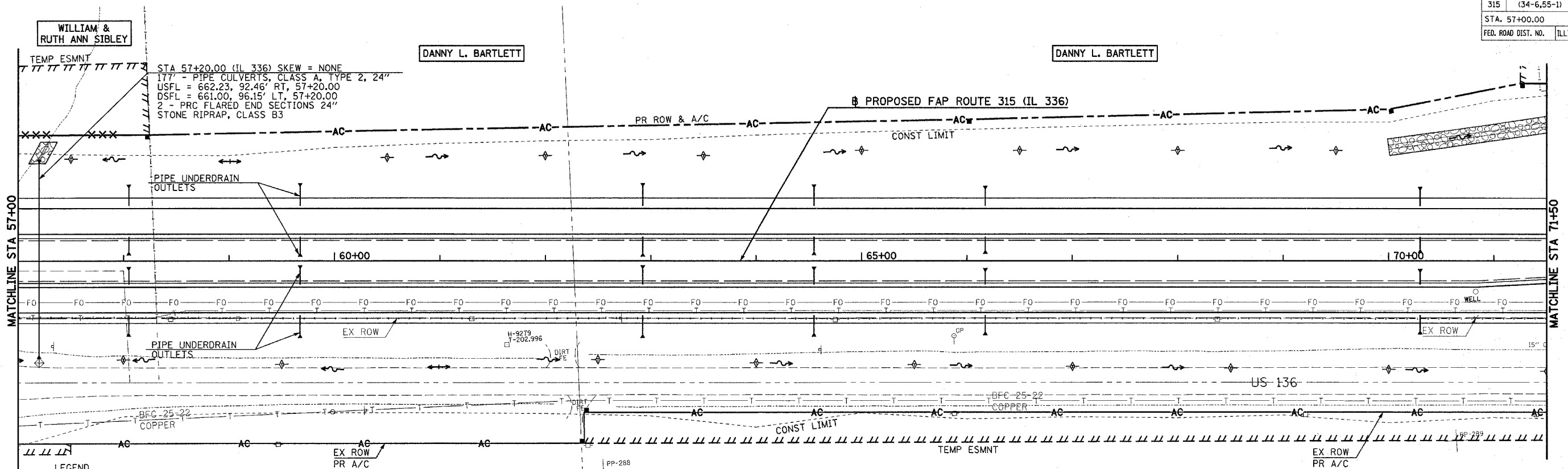

- LEGEND**
- STONE RIPRAP
  - EROSION CONTROL BLANKET
  - SEDIMENT BASIN
  - TEMPORARY DITCH CHECK
  - INLET & PIPE PROTECTION

FOR PIPE UNDERDRAIN OUTLETS LOCATION, OFFSET, AND ELEVATION SEE SCHEDULE OF QUANTITIES

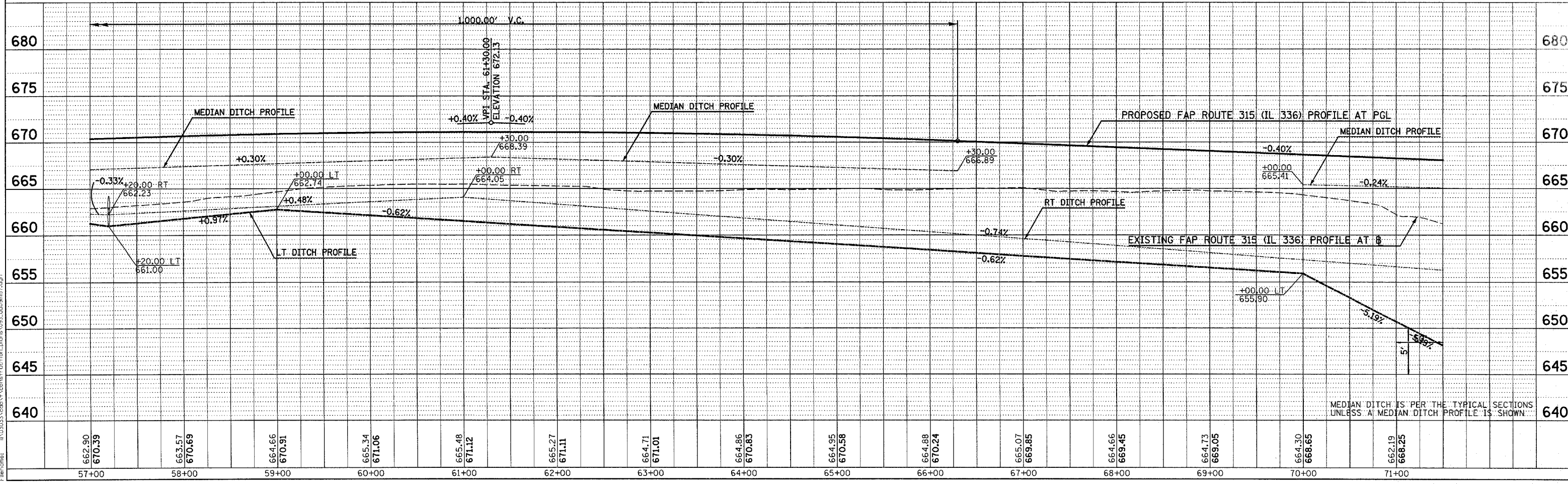
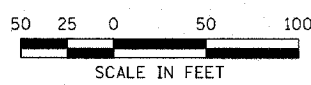

MEDIAN DITCH IS PER THE TYPICAL SECTIONS UNLESS A MEDIAN DITCH PROFILE IS SHOWN

**DRAINAGE & UTILITY PLAN & PROFILE - FAP ROUTE 315 (IL 336) STA 57+00 TO STA 71+50**