

F.A.P. RTE.	SECTION	COUNTY	TOTAL SHEETS	SHEET NO.
315	(34-6,55-1)	HANCOCK/McDONOUGH	433	126
STA. 114+00.00		TO STA. 129+00.00		
FED. ROAD DIST. NO.		ILLINOIS FED. AID PROJECT		
STATE CONTRACT NO. 68206				

PLAN	DATE
BY	
REVISIONS	
NO.	

PROFILE	DATE
BY	
REVISIONS	
NO.	

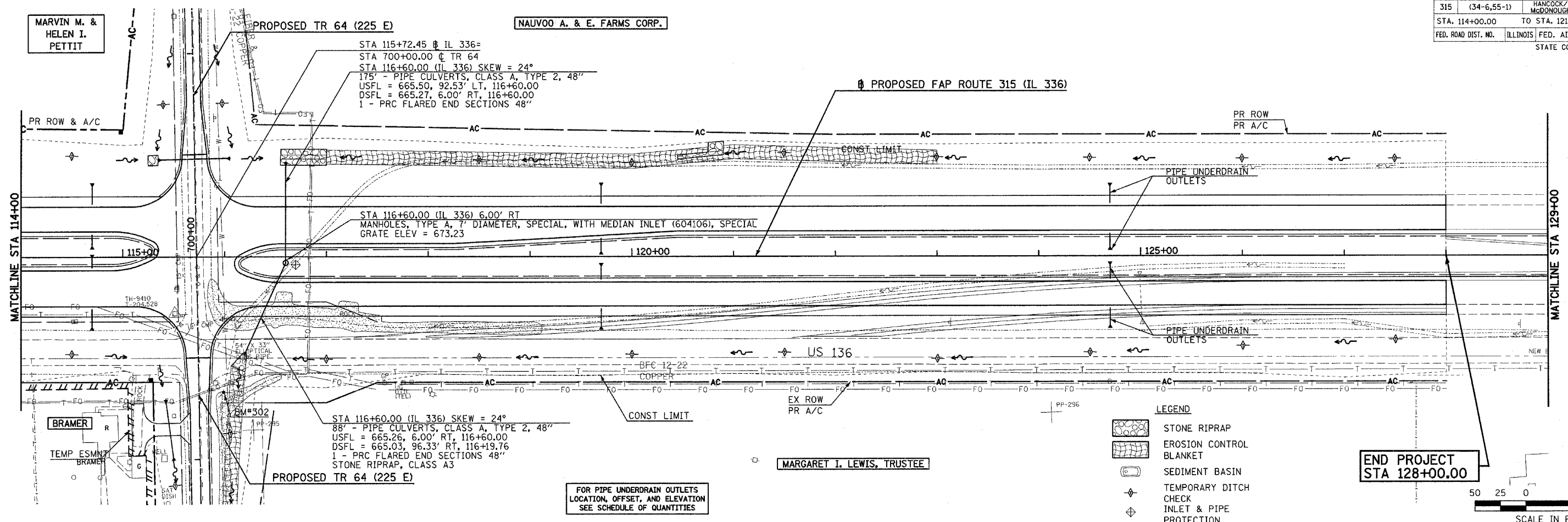

- LEGEND**
- STONE RIPRAP
  - EROSION CONTROL BLANKET
  - SEDIMENT BASIN
  - TEMPORARY DITCH CHECK
  - INLET & PIPE PROTECTION

FOR PIPE UNDERDRAIN OUTLETS  
LOCATION, OFFSET, AND ELEVATION  
SEE SCHEDULE OF QUANTITIES

END PROJECT  
STA 128+00.00

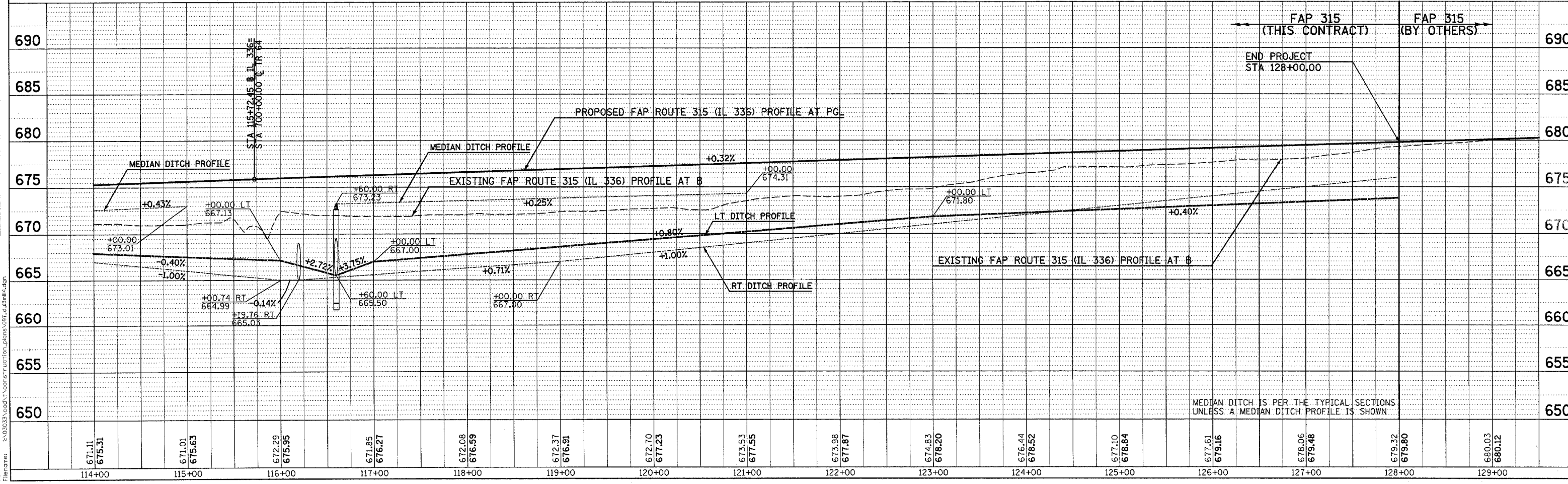
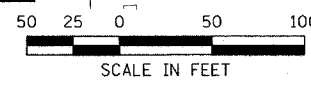

MEDIAN DITCH IS PER THE TYPICAL SECTIONS  
UNLESS A MEDIAN DITCH PROFILE IS SHOWN

**DRAINAGE & UTILITY PLAN & PROFILE - FAP ROUTE 315 (IL 336) STA 114+00 TO STA 129+00**

Plot Date: 8/20/2006  
Plot Time: 12:47:17 PM  
Plotted By: sdonohue  
Pen Table: 1dot1tbl  
Filename: P:\030333\cadd\1\construct\utility\plans\08T\_drainage.dgn