

F.A.P. RTE.	SECTION	COUNTY	TOTAL SHEETS	SHEET NO.
315	(34-6,55-1)	HANCOCK/McDONOUGH	433	158
STA.	TO STA.			
FED. ROAD DIST. NO.	ILLINOIS	FED. AID PROJECT	STATE CONTRACT NO. 68206	

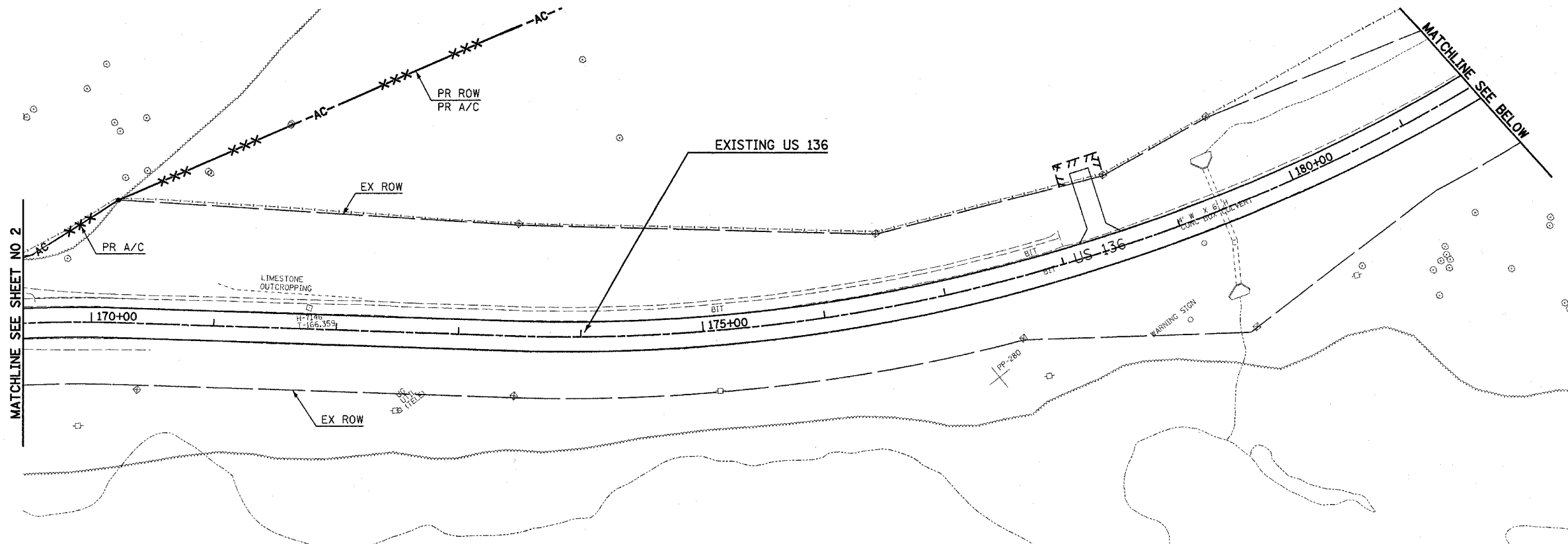

REMOVAL LEGEND					
	PAVEMENT REMOVAL		EXISTING GRAVEL PAVEMENT TO BE REMOVED. COST INCIDENTAL TO EARTH EXCAVATION.		BUILDING REMOVAL
	EXISTING OIL & CHIP PAVEMENT TO BE REMOVED. COST INCIDENTAL TO EARTH EXCAVATION.		EXISTING ENTRANCE PAVEMENT TO BE REMOVED. COST INCIDENTAL TO EARTH EXCAVATION.	X	TREE REMOVAL
	STRUCTURE REMOVAL		TREE REMOVAL, ACRES	XXXXXX	GUTTER REMOVAL

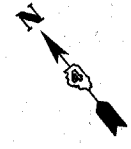
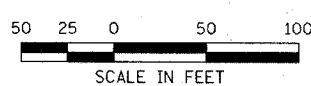
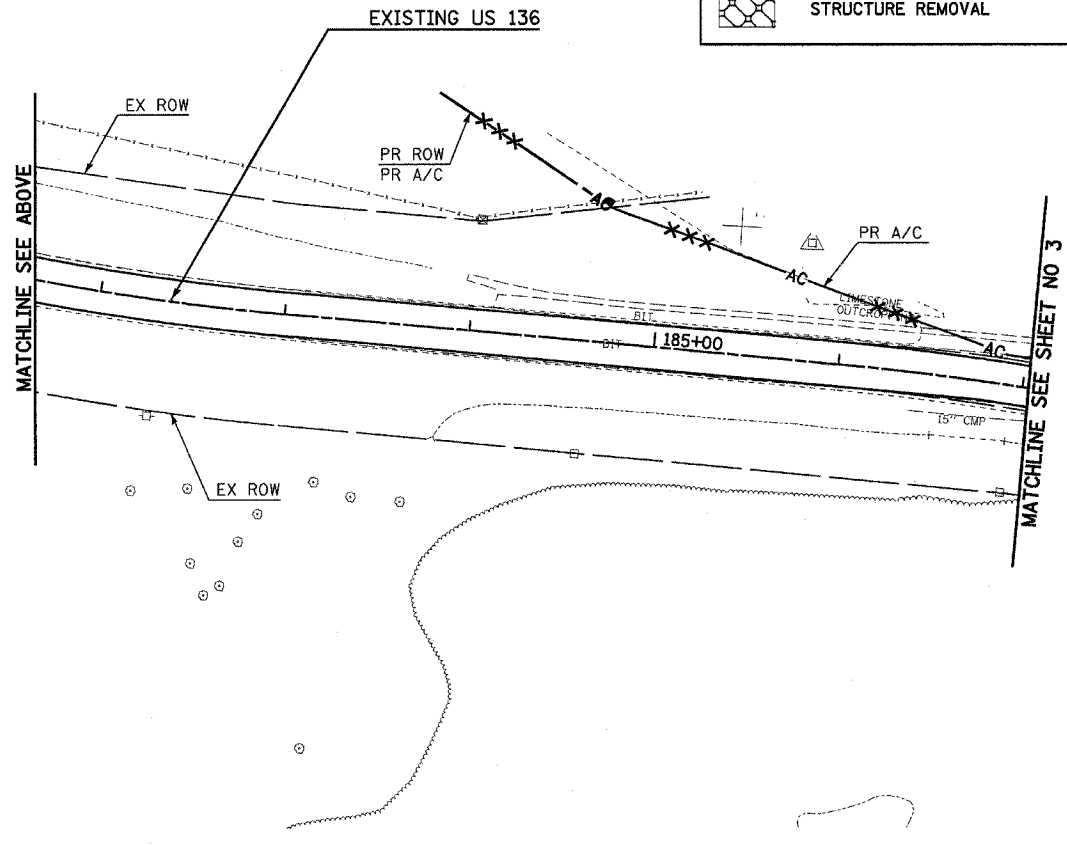
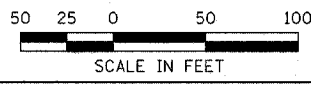

Plot Date: 7/15/2006
 Plot Time: 1:58:47 PM
 Plotter: B. H. H. H.
 Pen Tables: h001.tbl
 Filename: I:\02033\road\1\constr\us136\plan\plan\rm08mex.dgn