

DATE	BY	CHECKED	TOTAL SHEETS	SHEET NO.
F.A. 53		HANCOCK/McDONOUGH	59	26
REV. NO.		DESCRIPTION		
24/RS-3, B-1				

SHEET NO. 2
OF
3 SHEETS

FOR INFORMATION ONLY

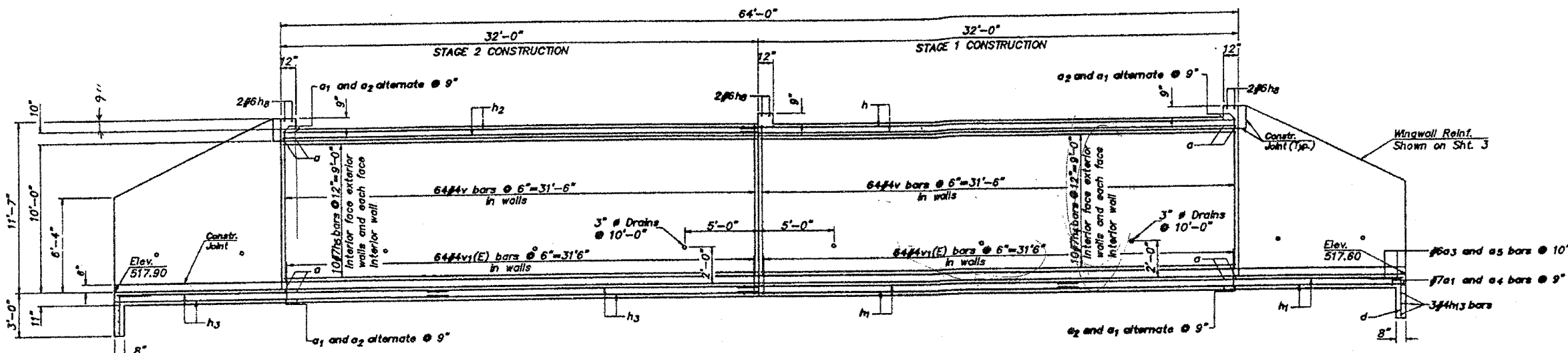

ELEVATION

BILL OF MATERIAL

Bar	No.	Size	Length	Shape
a	156	6	25'-6"	U
a1	118	7	24'-0"	U
a2	84	7	10'-6"	U
a3	28	6	20'-0"	U
a4	30	7	17'-3"	U
a5	26	6	19'-9"	U
d	60	4	4'-8"	L
h	58	4	33'-2"	U
h1	128	4	22'-10"	U
h2	58	4	31'-10"	U
h3	128	4	22'-2"	U
h4	40	7	35'-3"	U
h5	40	7	31'-9"	U
h6	56	4	10'-10"	U
h7	8	6	17'-2"	U
h8	6	6	23'-2"	U
h9	36	4	15'-7"	U
h10	8	4	18'-9"	U
h11	6	4	15'-3"	U
h12	156	7	8'-0"	U
h13	12	4	23'-8"	U
n(E)	76	6	7'-0"	U
v	512	4	10'-2"	U
v1(E)	512	4	2'-7"	U
v2	38	4	16'-11"	U
v3	16	4	16'-9"	U
Removal of Existing Structures	Each		1	
Class X Concrete Box Culvert	Cu. Yd.		212.3	
Reinforcement Bars	Pound		36,510	
Reinforcement Bars (Epoxy Coated)	Pound		1680	

Notes:
 Pour apron slab monolithic with bottom slab of barrel.
 Pour wingwalls monolithic with outside walls of barrel.
 Reinforcement bars designated (E) shall be epoxy coated.
 Bars indicated thus 20X3-#5 etc. indicates 20 lines of bars with 3 lengths per line.
 Field cut horizontal bars in outside walls and longitudinal bars in top and bottom slab for splicer couplings where noted.

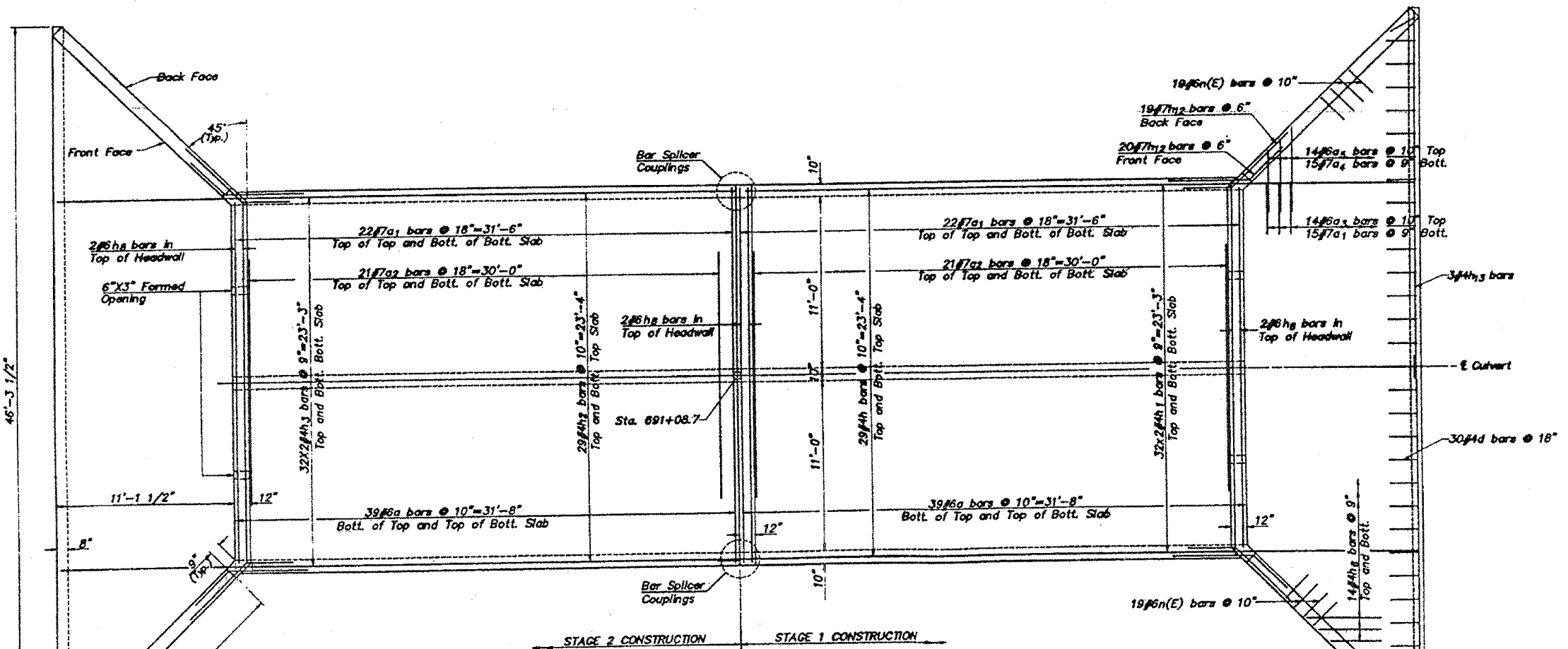

PLAN

REV. NO.	DATE	DESCRIPTION	DATE

F.A. RTE. 53
 SECTION 24, B-1
 HANCOCK/McDONOUGH COUNTIES
 PLAN AND ELEVATION
 STRUCTURE NUMBER 034-2007
 STA. 691+08.7