

Bench Mark: Standard tablet "3 REI 1944", Elev. 537.51

Existing Structure: S.N. 034-0005, originally built in 1924 as SBI Rte 9, Sec 24. In 1974, the superstructure and parts of the substructure were replaced and one new pier was constructed as SBI Rte. 9, Sec 24BR. The existing structure is a four span (55'-51'-51'-55') precast deck beam bridge with a 33'-0" out to out deck. The existing structure is to be removed and replaced as S.N. 034-0511. Traffic will be diverted to the proposed West Bound IL 336 S.N. 034-0512 during construction.

STATE OF ILLINOIS
DEPARTMENT OF TRANSPORTATION

ROUTE NO.	SECTION	COUNTY	DATE	SHEET NO.	SHEET NO. 1
F.A.P. 315	34-6, 55-1	HANCOCK	433	199	36 SHEETS
FED. AID DIST. NO.	DATE	FED. AID PROJECT			

Contract #68206

No Salvage.

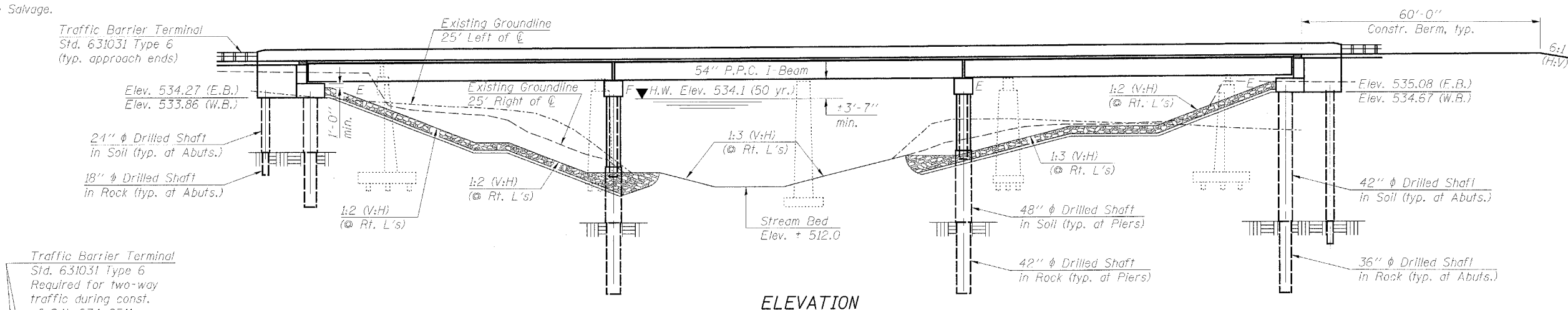

LOADING HL-93
Allow 50#/sq. ft. for future wearing surface.

DESIGN SPECIFICATIONS
2004 AASHTO LRFD Bridge Design Specifications

DESIGN STRESSES

FIELD UNITS
 $f'_c = 3,500$ psi
 $f_y = 60,000$ psi (reinforcement)

PRECAST PRESTRESSED UNITS
 $f'_c = 7,000$ psi
 $f'_t = 6,000$ psi
 $f_y = 270,000$ psi ($1/2$ " ϕ low lax. strands)
 $f_y = 201,960$ psi ($1/2$ " ϕ low lax. strands)

SEISMIC DATA
 Seismic Performance Category (SPC) = A
 Bedrock Acceleration Coefficient (A) = 4.0%g
 Site Coefficient (S) = 1.0

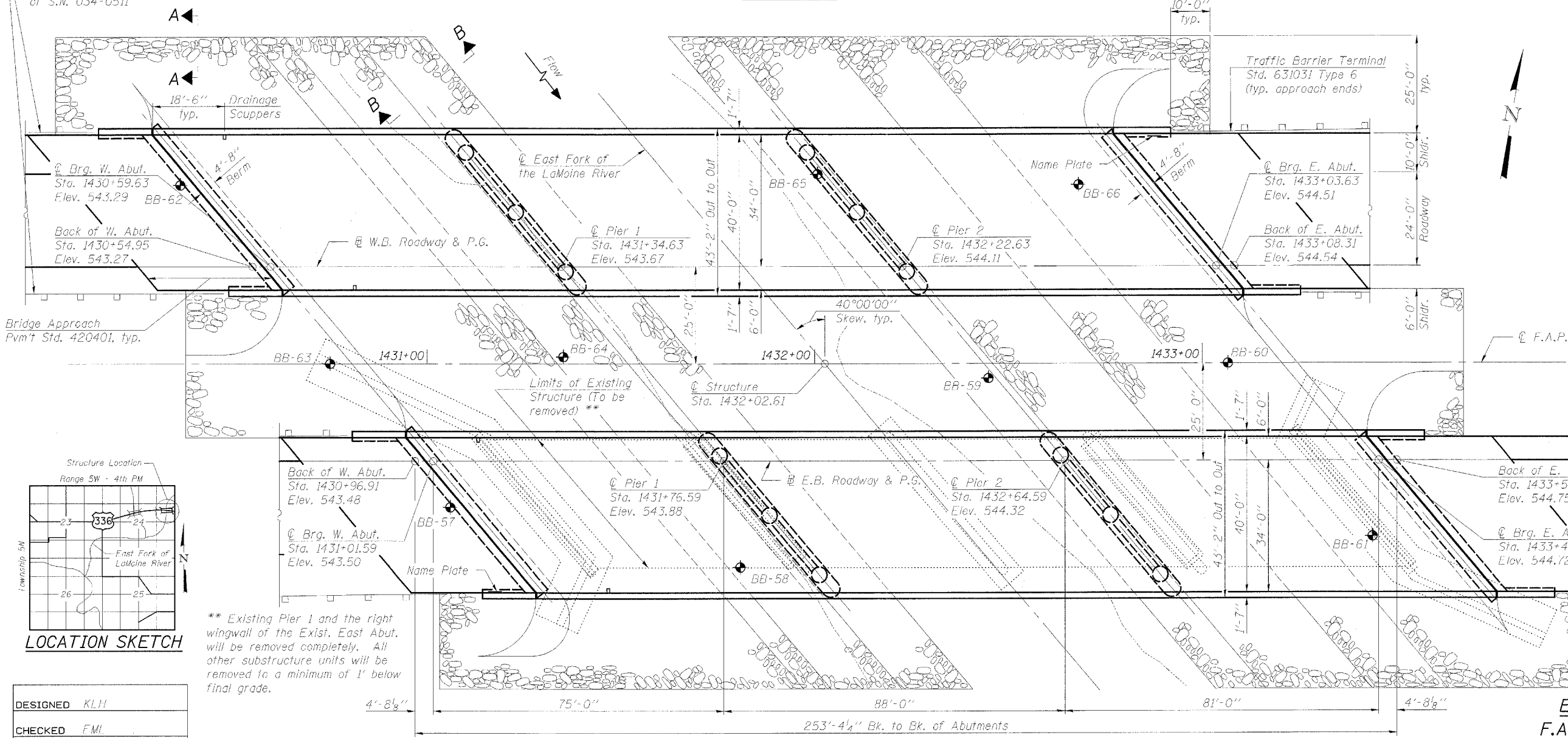

DOWNDRAW FORCES

Westbound Structure		Eastbound Structure	
Location	Force (Ton)	Location	Force (Ton)
West Abutment	0	West Abutment	0
Pier 1	8	Pier 1	10
Pier 2	15	Pier 2	15
East Abutment	20	East Abutment	20

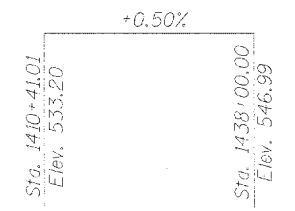

APPROVED
FOR STRUCTURAL ADEQUACY ONLY

Ralph E. Anderson
ENGINEER OF BRIDGES AND STRUCTURES

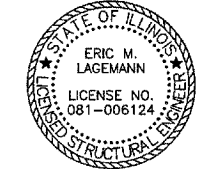

Eric Lagemann 7/17/06
Expires 11/30/2006

GENERAL PLAN
ILLINOIS ROUTE 336 OVER
EAST FORK OF THE LAMOINE RIVER
F.A.P. ROUTE 315 - SECTION 34-6, 55-1
HANCOCK COUNTY; STA. 1432+02.61
STRUCTURE NO. 034-0511 (E.B.)
STRUCTURE NO. 034-0512 (W.B.)

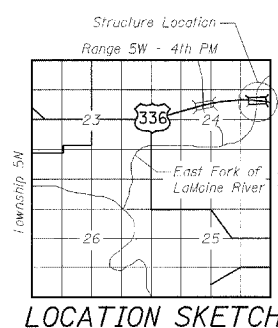

** Existing Pier 1 and the right wingwall of the Exist. East Abut. will be removed completely. All other substructure units will be removed to a minimum of 1' below final grade.

DESIGNED	KLH
CHECKED	F.M.
DRAWN	KBF/EML
CHECKED	JGC

HORNER & SHIFRIN, INC.
ENGINEERS ARCHITECTS PLANNERS