

BRIDGE NO 1- 072-0134 US RT 24 OVER KICKAPOO CREEK

F.A. RTE.	SECTION	COUNTY	TOTAL SHEETS	SHEET NO.
VAR	04 BRDG PNT 07	VARIOUS	17	6
STA.		TO STA.		
FED. ROAD DIST. NO. 4		ILLINOIS		

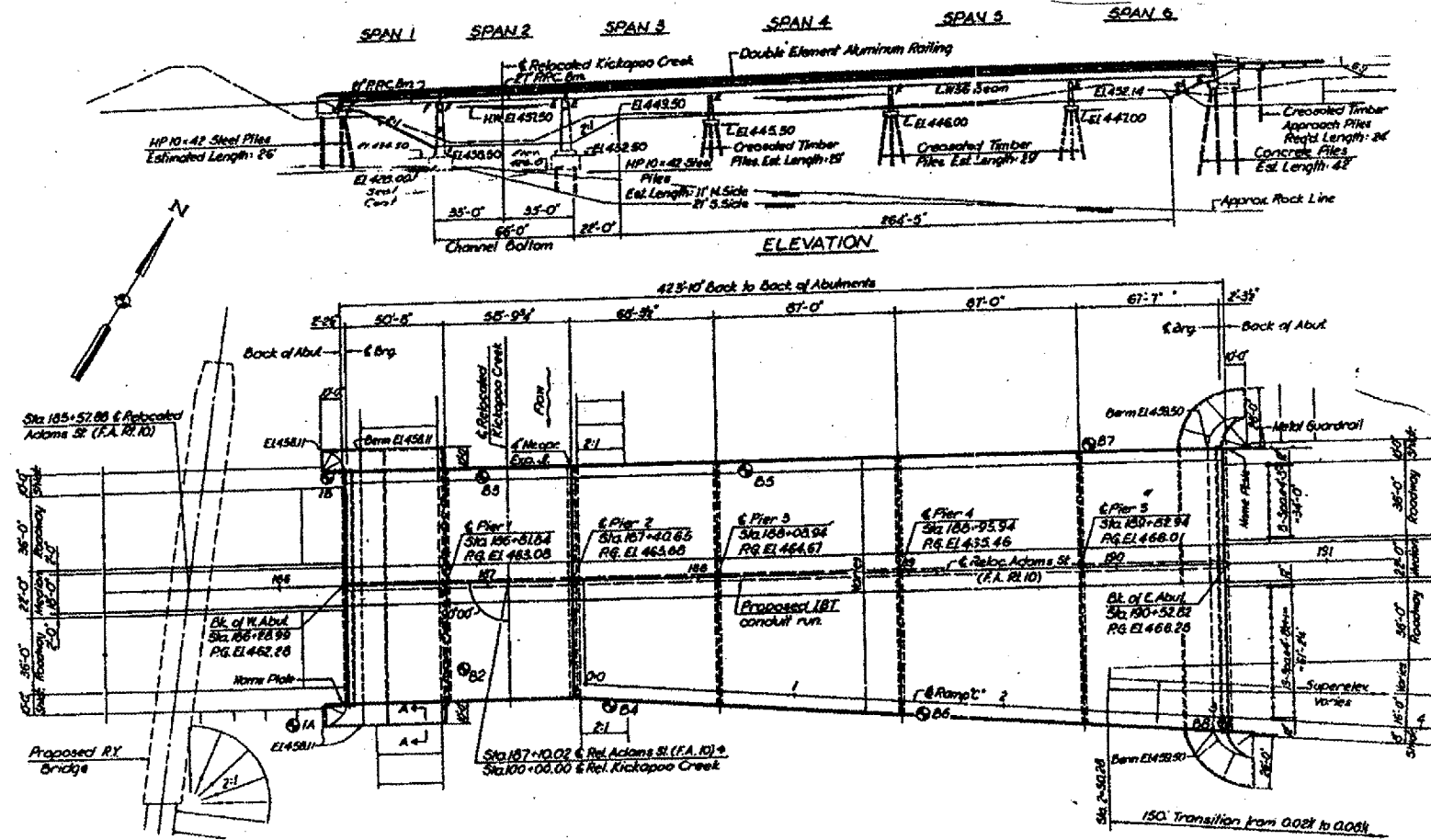

FOR INFORMATION ONLY

ILLINOIS DEPARTMENT OF TRANSPORTATION
 BRIDGE NO 1
 PLAN & ELEVATION

DATE 07-26-2006

DRAWN BY