

PAP. ROUTE	SECTION	COUNTY	TOTAL SHEETS	SHEET NO.
42	2BR	WASHINGTON	33	9
STA.		TO STA.		
EXISTING CONDITIONS:				

CONTRACT NO. 76389

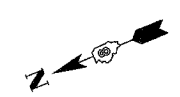

LEGEND

- TEMPORARY TRAFFIC SIGNALS
- TEMPORARY IMPACT ATTENUATOR
- TEMPORARY CONCRETE BARRIER

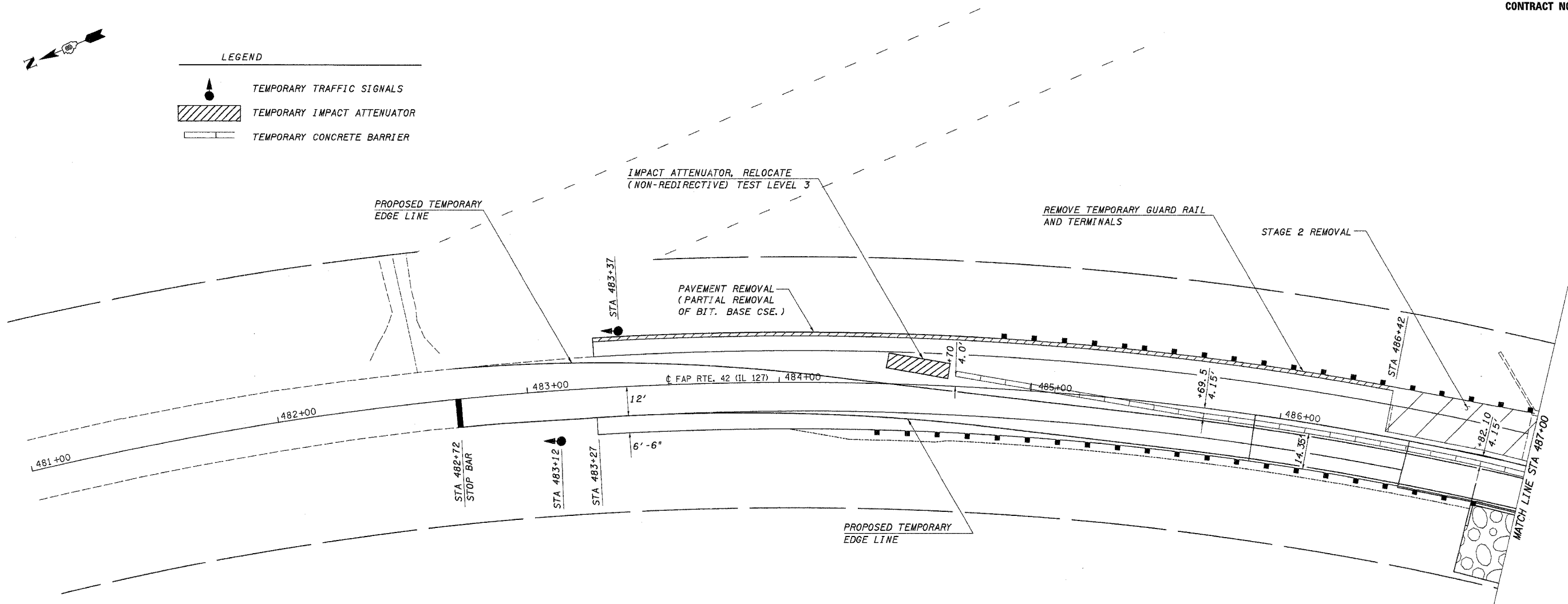

SEQUENCE OF OPERATIONS

- STAGE 2:
1. SHIFT TRAFFIC CONTROL DEVICES FOR STAGE 2 CONSTRUCTION. ESTABLISH ONE-LANE, TWO-WAY TRAFFIC IN SOUTHBOUND LANE AND RELOCATE WORK ZONE TRAFFIC CONTROL DEVICES, TEMPORARY CONCRETE BARRIER AND IMPACT ATTENUATORS AS SHOWN ON THIS PLAN AND STANDARD T01321.
 2. REMOVE TEMPORARY GUARD RAIL AND TERMINALS.
 3. REMOVE STAGE 2 PORTION OF PAVEMENT AND STRUCTURE INCLUDING PARTIAL REMOVAL OF BITUMINOUS BASE COURSE CONSTRUCTED IN THE PRELIMINARY PHASE AS SHOWN ON TYPICAL ROADWAY CROSS SECTIONS.
 4. CONSTRUCT STAGE 2 PORTIONS OF PROPOSED STRUCTURE AND APPROACH PAVEMENTS.
 5. MILL NORTHBOUND LANE AND RESURFACE.
 6. CONSTRUCT BITUMINOUS SHOULDERS AND EARTH SHOULDERS.
 7. INSTALL TRAFFIC BARRIER TERMINAL TYPE 6 AND STEEL PLATE BEAM GUARD RAIL; RE-ERECT TRAFFIC BARRIER TERMINAL TYPE 1 SPECIAL (TANGENT).
 8. REMOVE TRAFFIC CONTROL DEVICES, TEMPORARY PAVEMENT MARKINGS, TEMPORARY CONCRETE BARRIER, AND IMPACT ATTENUATORS; INSTALL SHORT-TERM PAVEMENT MARKINGS AND OPEN ALL LANES TO TRAFFIC.
- FINAL PHASE:
1. REMOVE SHORT-TERM PAVEMENT MARKINGS; INSTALL PAVEMENT MARKINGS AND RAISED REFLECTIVE MARKERS.
 2. SEEDING AND FINAL CLEAN UP.

NOTES

SEE STANDARD T01321 FOR DETAILS NOT SHOWN.

TEMPORARY CONCRETE BARRIER ON THE APPROACH ROADWAY SHALL BE PLACED PARALLEL TO THE C OF IL 127. TEMPORARY CONCRETE BARRIER WITHIN THE LIMITS OF THE PROPOSED STRUCTURE SHALL BE PLACED PARALLEL TO THE C OF THE PROPOSED STRUCTURE.

OFFSETS REFER TO THE DISTANCE FROM THE C OF IL 127 TO THE FACE OF THE TEMPORARY CONCRETE BARRIER.

IF THE CONTRACTOR ELECTS TO DELAY BITUMINOUS RESURFACING UNTIL AFTER STAGE CONSTRUCTION IS COMPLETE, TEMPORARY RAMPS AND AGGREGATE PRIME COAT WILL BE REQUIRED. THE COST OF THESE ITEMS WILL NOT BE PAID FOR SEPERATELY BUT SHALL BE INCLUDED IN THE COST OF THE VARIOUS RESURFACING ITEMS.

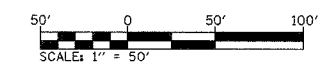

STAGE II CONSTRUCTION

FAP ROUTE 42 (IL 127)
SECTION 2BR
WASHINGTON COUNTY

CUMMINS ENGINEERING CORPORATION	JOB #: 2158
	FILE: Stage2
	DATE: 3/17/05

PLAN	BY	DATE	NO.	NO.
SURVEYED				
NOTE BOOK				
ALIGNED				
CHECKED				
FILE NAME				