

F.A.P. RTE.	SECTION	COUNTY	TOTAL SHEETS	SHEET NO.
329	126BR-1	RANDOLPH	27	11
STA.	TO STA.			
FED. ROAD DIST. NO.	ILLINOIS FED. AID PROJECT			
CONTRACT NO. 76898				

LEGEND:

- STRUCTURE REMOVAL
- TEMPORARY CONCRETE BARRIER
- IMPACT ATTENUATOR
- INDUCTION LOOP DETECTOR
- DRUM WITH STEADY BURNING LIGHT
- SIGNALIZED TWO-WAY TRAFFIC LANE
- TEMPORARY BRIDGE TRAFFIC SIGNAL
- TYPE III BARRICADE

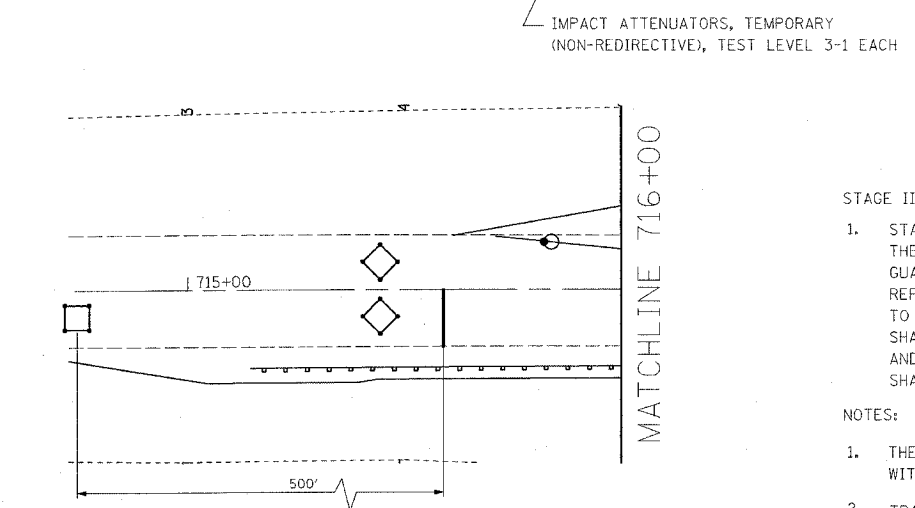
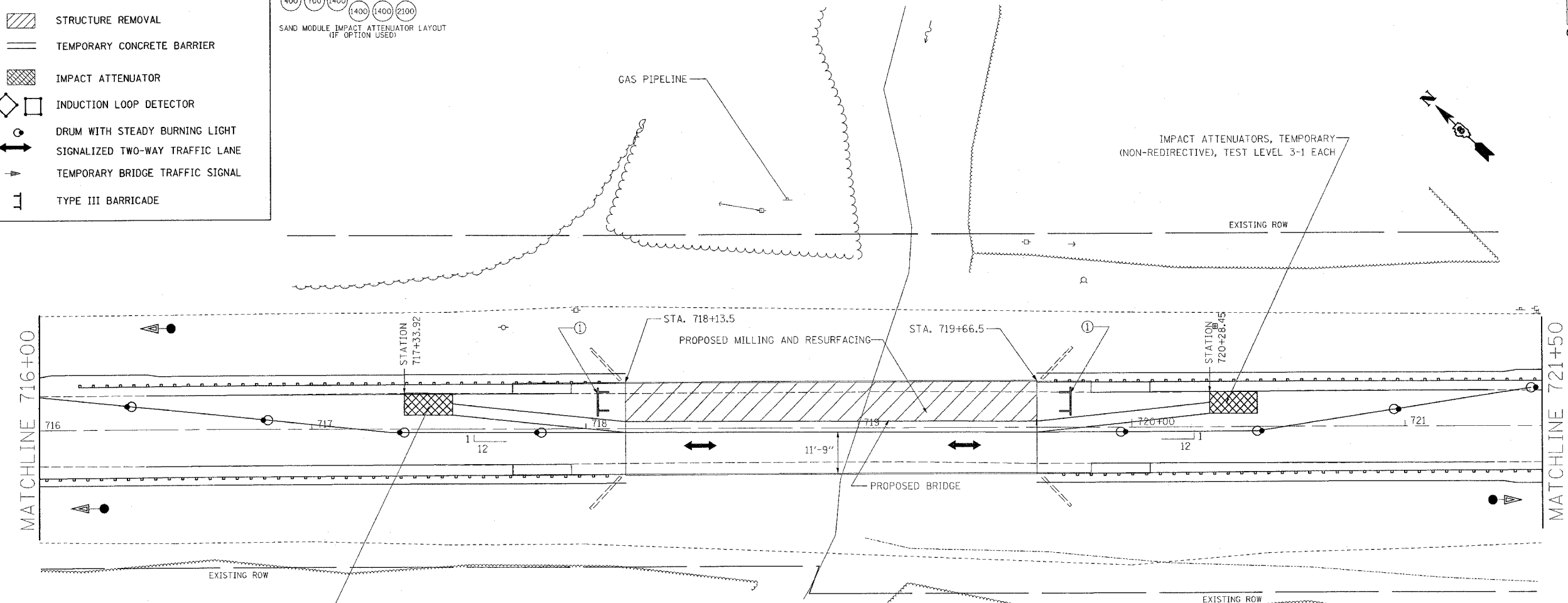
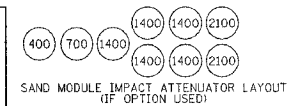

① LIGHTED TYPE III BARRICADES TO BE IN PLACE WHEN NO WORK IS BEING PERFORMED AT LEAST TWO AT EACH END.

STAGE II CONSTRUCTION:

- STAGE II CONSTRUCTION SHALL CONSIST OF STAGE II REMOVAL OF NORTH PORTION OF THE EXISTING SUPER STRUCTURE, CONSTRUCTION OF THE 9" DEPTH SHOULDER, PROPOSED GUARDRAIL IN THE N.W. AND N.E. QUAD. AND STAGE II CONSTRUCTION OF THE REPLACEMENT STRUCTURE. STAGE II CONSTRUCTION SHALL BE DONE ACCORDING TO STAGE CONSTRUCTION AS DETAILED IN THE BRIDGE PLANS. TRAFFIC CONTROL SHALL BE IN ACCORDANCE WITH THE APPLICABLE PORTIONS OF STANDARD 701321 AND AS DETAILED IN THE STAGE CONSTRUCTION PLANS. THIS TRAFFIC CONTROL SHALL BE PAID FOR AS TRAFFIC CONTROL AND PROTECTION 701321 (SPECIAL).

NOTES:

- THE CONTRACTOR SHALL MAINTAIN ACCESS TO PRIVATE AND FIELD ENTRANCES LOCATED WITHIN THE LIMITS OF THE PROJECT.
- TRAFFIC CONTROL & PROTECTION, STANDARD 701321 (SPECIAL) INCLUDES STAGES I, II & III AND ANY ADDITIONAL SIGNING OR TRAFFIC CONTROL DEVICES SHOWN ON THE STAGE CONSTRUCTION PLANS.
- THE FINAL BITUMINOUS WEARING SURFACE MUST BE IN PLACE ON THE STRUCTURE PRIOR TO OPENING A LANE TO TRAFFIC.
- REFER TO PLAN AND PROFILE SHEET TO DETERMINE LIMITS OF MILLING AND RESURFACING AREA.
- ALL ADDITIONAL TRAFFIC SIGNAL HEADS, LOOP DETECTORS AND ASSOCIATED EQUIPMENT REQUIRED TO MAINTAIN ACCESS AT THE FIELD AND DRIVEWAY ENTRANCES SHALL BE INCLUDED IN THE COST OF "TEMPORARY BRIDGE TRAFFIC SIGNALS"

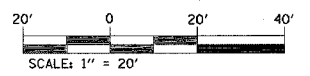
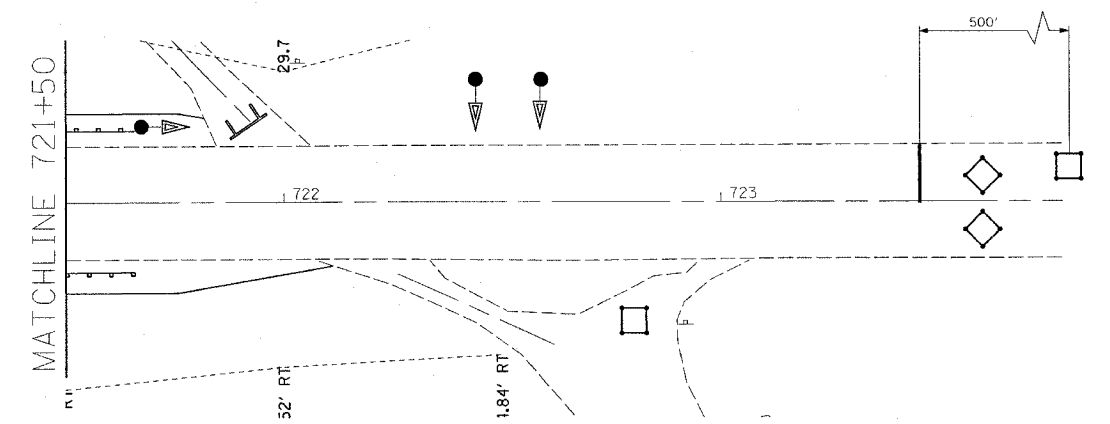

REVISIONS	
NAME	DATE

ILLINOIS DEPARTMENT OF TRANSPORTATION

STAGE II CONSTRUCTION
FAP ROUTE 329 (IL 154)
SECTION 126BR-1
RANDOLPH COUNTY

SCALE: VERT. _____
 DATE _____ HORIZ. _____

DRAWN BY _____
 CHECKED BY _____

PLOT DATE * 10/11/2006
 FILE NAME * c:\projects\126BR-1\plan\plg23895.dgn
 PLOT SCALE * 20.000000 / 1" = 20'
 USER NAME * bryant