

F.A. R.T.E.	SECTION	COUNTY	TOTAL SHEETS	SHEET NO.
*	50TS-1, 2TS	GREENE	6	1

* FAS 733 / FAP566

D-98-062-06

STATE OF ILLINOIS
DEPARTMENT OF TRANSPORTATION
DIVISION OF HIGHWAYS

**PROPOSED
HIGHWAY PLANS**

ROUTE FAS 733 / FAP 566 (US 67/L -106)

SECTION 50TS-1, 2TS

~~PROJECT~~

GREENE COUNTY

INSTALL FLASHING BEACONS ON STOP SIGN

C-98-051-06

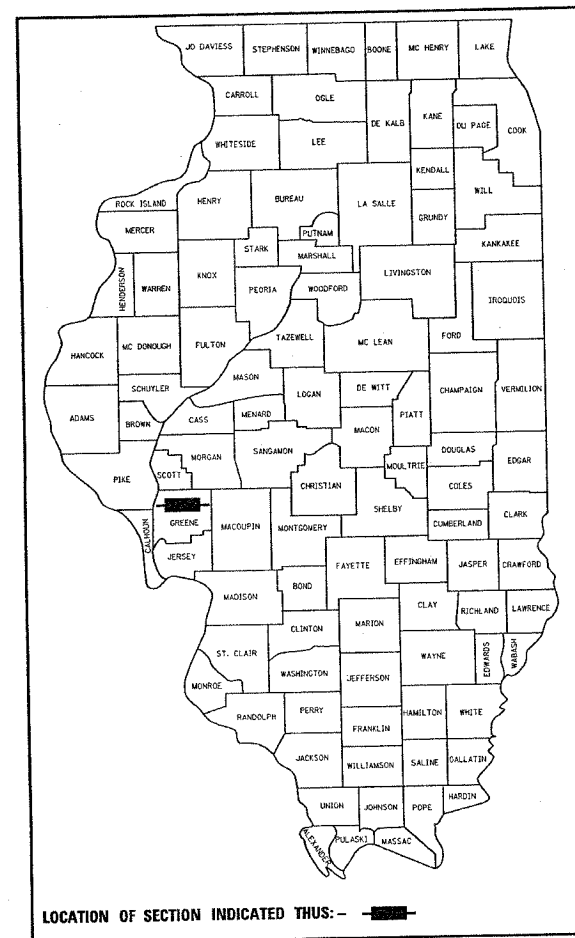

INDEX OF SHEETS

- 1 COVER SHEET
- 2 SUMMARY OF QUANTITIES
- 3 GENERAL NOTES, COMMITMENT, & LEGEND
- 4 PLAN SHEET
- 5 CABLE DIGRAM
- 6 ELECTRICAL DETAILS

STANDARDS

- 701001-01
- 701006-02 805001
- 701011-01 814001
- 701501-03 880001
- 702001-06

MICROFILMED _____
 REEL NUMBER _____
 AWARDED _____
 RESIDENT ENGINEER _____
 AS BUILT CHANGES WERE MADE
 ON THE FOLLOWING SHEETS

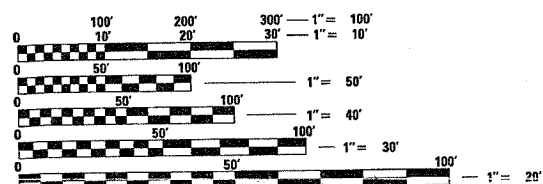

FULL SIZE PLANS HAVE BEEN PREPARED USING STANDARD
 ENGINEERING SCALES. REDUCED SIZED PLANS WILL NOT
 CONFORM TO STANDARD SCALES. IN MAKING MEASUREMENTS
 ON REDUCED PLANS, THE ABOVE SCALES MAY BE USED.

J.U.L.I.E.
 JOINT UTILITY LOCATION INFORMATION FOR EXCAVATION
 1-800-892-0123

CONTRACT NO. 76A24

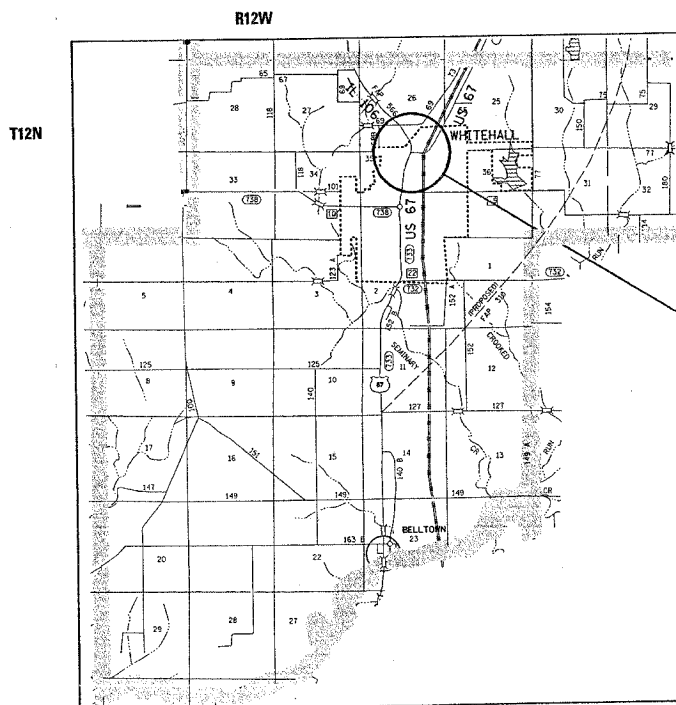

PROJECT LOCATION: US 67 @ IL 106
 IN WHITE HALL

ADT DATA - 2005

- US 67 (NB) @ IL 106 - 6600
- US 67 (SB) @ IL 106 - 5400
- IL 106 @ US 67 - 1100

WHITEHALL TOWNSHIP

LAYOUT



PROJECT ENGINEER: PATTI LEBEAU (618) 346-3179
 SQUAD LEADER: BHARAT PATEL (618) 346-3190

STATE OF ILLINOIS
 DEPARTMENT OF TRANSPORTATION
 DIVISION OF HIGHWAYS

SUBMITTED July 7, 2006

May C. Starni
 DEPUTY DIRECTOR OF HIGHWAYS
 REGION FIVE ENGINEER

August 18, 2006
Mike Stone
 ENGINEER OF DESIGN AND ENVIRONMENT

August 18, 2006
Milton R. See, P.E.
 DIRECTOR, DIVISION OF HIGHWAYS

PRINTED BY THE AUTHORITY
 OF THE STATE OF ILLINOIS

Rev.