

(2) SIGN PANELS TYPE 1 @ STA. 9+612 WITH (1) ALUMINUM SIGN POST, SPECIAL SIGN POST, SPECIAL (SEE DETAIL)



**PROP. CURVE CL-6**  
 PI STA = 9+656.877  
 N = 51,178.296  
 E = 5,015.057  
 $\Delta = 3^\circ 30' 27''$  (LT)  
 R = 40.000 m  
 T = 1.225 m  
 L = 2.449 m  
 E = 0.019 m

**PROP. CURVE CL-7**  
 PI STA = 9+776.321  
 N = 51,059.002  
 E = 5,020.888  
 $\Delta = 3^\circ 23' 43''$  (LT)  
 R = 100.000 m  
 T = 2.964 m  
 L = 5.926 m  
 E = 0.044 m

**PROP. CURVE CL-9**  
 PI STA = 9+855.334  
 N = 50,981.029  
 E = 5,029.937  
 $\Delta = 16^\circ 57' 38''$  (LT)  
 R = 50.000 m  
 T = 7.455 m  
 L = 14.801 m  
 E = 0.553 m

**PROP. CURVE CL-11**  
 PI STA = 9+923.682  
 N = 50,913.290  
 E = 5,033.205  
 $\Delta = 12^\circ 06' 15''$  (LT)  
 R = 50.000 m  
 T = 5.301 m  
 L = 10.563 m  
 E = 0.280 m

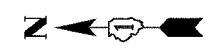

SECTION	COUNTY	TOTAL SHEETS	SHEET NO.
02-00090-00-BT	DUPAGE	117	15
STA. TO STA.			
IDOT PROJECT NO. M-8003(222)			
SALT CREEK GREENWAY TRAIL			

CONTRACT NO. 83713  
**PROPOSED RUSTIC RAIL FENCE LIMITS:**  
 STA. 9+818.6 LT TO STA. 10+003.5 LT  
 STA. 10+013.80 LT TO STA. 10+149.80  
 FENCE TO BE OFFSET 3 m LT OF PROP.  $\phi$  EXCEPT FOR CORNER AT ELIZABETH.

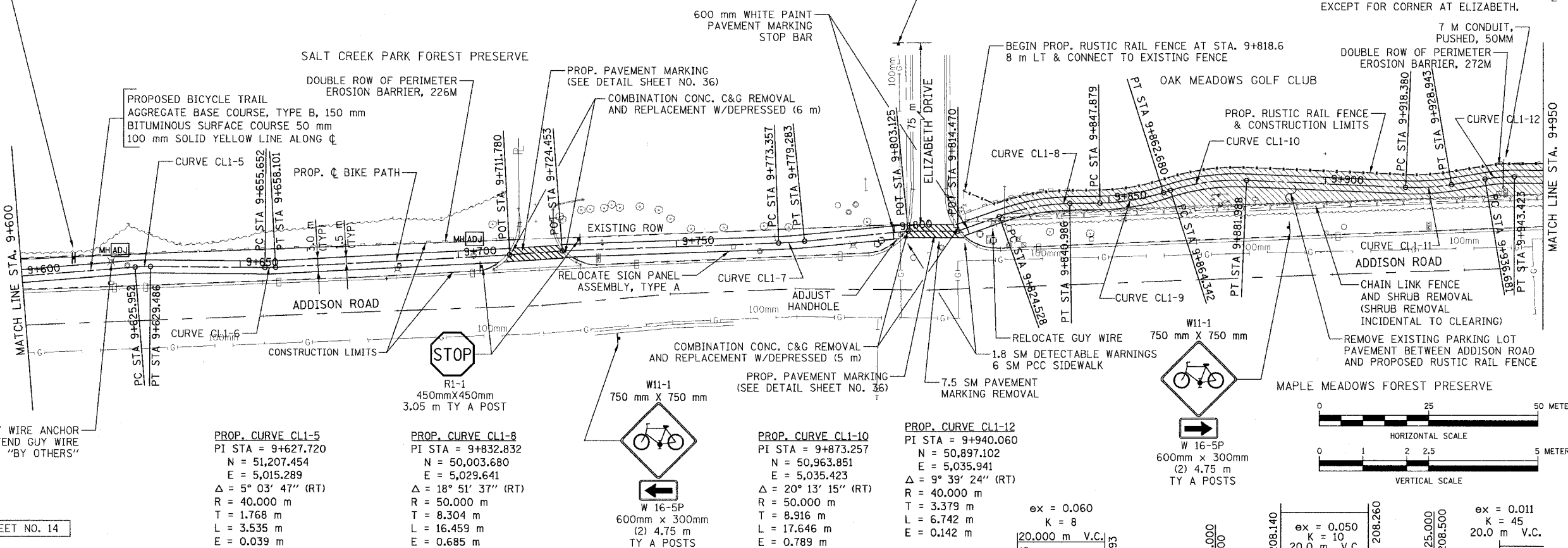

MOVE GUY WIRE ANCHOR AND EXTEND GUY WIRE "BY OTHERS"

**PROP. CURVE CL-5**  
 PI STA = 9+627.270  
 N = 51,207.454  
 E = 5,015.289  
 $\Delta = 5^\circ 03' 47''$  (RT)  
 R = 40.000 m  
 T = 1.768 m  
 L = 3.535 m  
 E = 0.039 m

**PROP. CURVE CL-8**  
 PI STA = 9+832.832  
 N = 50,003.680  
 E = 5,029.641  
 $\Delta = 18^\circ 51' 37''$  (RT)  
 R = 50.000 m  
 T = 8.304 m  
 L = 16.459 m  
 E = 0.685 m

**PROP. CURVE CL-10**  
 PI STA = 9+873.257  
 N = 50,963.851  
 E = 5,035.423  
 $\Delta = 20^\circ 13' 15''$  (RT)  
 R = 50.000 m  
 T = 8.916 m  
 L = 17.646 m  
 E = 0.789 m

**PROP. CURVE CL-12**  
 PI STA = 9+940.060  
 N = 50,897.102  
 E = 5,035.941  
 $\Delta = 9^\circ 39' 24''$  (RT)  
 R = 40.000 m  
 T = 3.379 m  
 L = 6.742 m  
 E = 0.142 m

W 16-5P  
 600mm x 300mm  
 (2) 4.75 m  
 TY A POSTS

FOR LEGEND SEE SHEET NO. 14

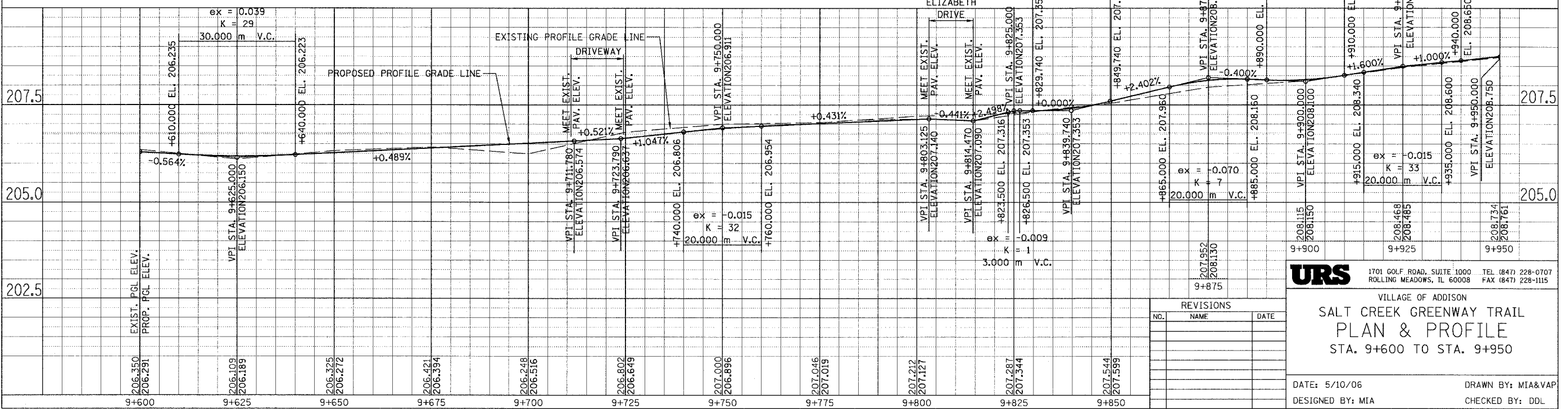

**URS** 1701 GOLF ROAD, SUITE 1000 TEL (847) 228-0707  
 ROLLING MEADOWS, IL 60008 FAX (847) 228-1115

VILLAGE OF ADDISON  
**SALT CREEK GREENWAY TRAIL  
 PLAN & PROFILE  
 STA. 9+600 TO STA. 9+950**

DATE: 5/10/06 DRAWN BY: MIA&VAP  
 DESIGNED BY: MIA CHECKED BY: DDL

REVISIONS		
NO.	NAME	DATE