

F.A.P. RTE.	SECTION	COUNTY	TOTAL SHEETS	SHEET NO.
1517	03-00247-00-BR	KANE	121	23
STA.	107+50	TO STA.	117+50	
FED. ROAD DIST. NO. 1		ILLINOIS HIGHWAY PROJECT		
CONTRACT # 83867				



LEGEND:

- DENOTES PROPOSED TOPSOIL FURNISH AND PLACE 6" AND SOODING, SALT TOLERANT
- DENOTES PERIMETER EROSION BARRIER
- DENOTES STONE RIP RAP
- DENOTES ROLLED EXCELSIOR
- DENOTES FLOW DIRECTION

EROSION CONTROL NOTES:

THE KANE-DUPAGE SOIL AND WATER CONSERVATION DISTRICT (KDSWD) MUST BE NOTIFIED ONE WEEK PRIOR TO THE PRE-CONSTRUCTION CONFERENCE, ONE WEEK PRIOR TO THE COMMENCEMENT OF LAND DISTURBING ACTIVITIES, AND ONE WEEK PRIOR TO THE FINAL INSPECTION.

WORK SHALL BE DONE IN ACCORDANCE WITH HIGHWAY STANDARD 280001 AND DETAILS IN THE PLANS.

A COPY OF THE APPROVED EROSION AND SEDIMENT CONTROL PLAN SHALL BE MAINTAINED ON THE SITE AT ALL TIMES.

THE CONTRACTOR IS RESPONSIBLE FOR INSTALLATION OF ANY ADDITIONAL EROSION CONTROL MEASURES NECESSARY TO PREVENT EROSION AND SEDIMENTATION AS DETERMINED BY THE KDSWD.

PERIMETER EROSION BARRIER MUST REMAIN IN PLACE UNTIL FINAL STABILIZATION HAS BEEN ESTABLISHED.

ALL EROSION AND SEDIMENT CONTROL MEASURES SHALL BE INSPECTED WEEKLY OR AFTER A ONE-HALF INCH OR GREATER RAINFALL EVENT AND ANY REQUIRED REPAIRS WILL BE MADE.

WATER PUMPED OR OTHERWISE DISCHARGED FROM THE SITE DURING CONSTRUCTION SHALL BE FILTERED AND A MEANS PROVIDED TO REDUCE EROSION.

ROLLED EXCELSIOR SHALL BE PLACED ALONG THE RIVER EDGE AS SHOWN. THE REMOVAL AND REINSTALLATION REQUIRED DUE TO CONSTRUCTION OPERATIONS SHALL BE INCLUDED IN COST OF THE ROLLED EXCELSIOR.

MECHANIZED CONSTRUCTION EQUIPMENT SHALL NOT BE OPERATED FROM OR MOVED ALONG THE RIVER BOTTOM.

ANY DISTURBED GROUND SHALL BE PROTECTED WITHIN 7 DAYS WITH EITHER PERMANENT OR TEMPORARY EROSION CONTROL MEASURES.

ROLLED EXCELSIOR'S SHALL BE IN ACCORDANCE WITH THE STANDARD SPECIFICATIONS AND SHALL BE A MINIMUM OF 12' IN LENGTH.

CONTRACTOR SHALL NOT DISTURB GROUND OUTSIDE THE PERIMETER EROSION BARRIER. PRIOR TO COMMENCING LAND-DISTURBING ACTIVITIES IN AREA OTHER THAN INDICATED ON THESE PLANS, A SUPPLEMENTARY EROSION CONTROL PLAN SHALL BE SUBMITTED TO THE CITY OF AURORA FOR REVIEW BY THE KDSWD.

WORK THIS SHEET WITH THE BRIDGE PLANS AND THE 'EARTH EXCAVATION TABLE.

AT ALL TIMES, PERIMETER EROSION BARRIER SHALL BE INSTALLED BETWEEN ALL DISTURBED AREAS AND THE RIVER. PERIMETER BARRIERS SHALL BE INSPECTED AT THE END OF EACH WORK DAY AND PRIOR TO ANY RAIN EVENTS.

ALL INLETS ON AND ADJACENT TO THE SITE MUST HAVE A SEDIMENT TRAPPING OR CONTAINMENT DEVICE INSTALLED DURING CONSTRUCTION ACTIVITIES. STRAW BALES ARE NOT ALLOWED.

BUILDING MATERIAL STOCKPILES SHALL BE LOCATED IN AREAS THAT DO NOT HAVE HIGH POTENTIAL FOR CONTRIBUTING SEDIMENTS TO THE RIVER OR STORMWATER STRUCTURES.

THE CONTRACTOR IS NOT PERMITTED TO ALLOW THE EXISTING DECK MATERIAL, OR OTHER CONSTRUCTION DEBRIS TO FALL INTO THE RIVER DURING DEMOLITION OR CONSTRUCTION.

IN THE EVENT THE CONTRACTOR REQUESTS TEMPORARY WORK ACCESS TO THE FOX RIVER TO PLACE TEMPORARY SHORING PLATFORMS OR OTHER STRUCTURES, THE CONTRACTOR MUST CONTACT THE KANE-DUPAGE SOIL & WATER CONSERVATION DISTRICT AT 630-584-7891 EXT. 3, AND THE US ARMY CORP OF ENGINEERS TO COORDINATE EROSION AND SEDIMENT CONTROL MEASURES. AT NO TIME WILL ACTIVE EXCAVATION BE ALLOWED IN THE RIVER FLOWS.

IF ANY EXCAVATION OF THE BANKS SHALL TAKE PLACE FOR THE PLACEMENT OF RIPRAP, TIMING OF THE WORK TO COINCIDE WITH LOW FLOW CONDITIONS SHALL TAKE PLACE. IF ANY FLOWING WATER IS PRESENT ON THE BANKS DURING THE EXCAVATION AND PLACEMENT OF THE RIP RAP, A TURBIDITY CURTAIN, SILT FENCE, OR OTHER SEDIMENT BARRIER SHALL BE PLACED BETWEEN THE ACTIVE EXCAVATION AREA AND THE RIVER FLOWS. IF WORK SHALL NOT BE DONE DURING ACTIVE FLOWS ON THE BANKS, NO ADDITIONAL SEDIMENT CONTROL BARRIER IS NECESSARY, HOWEVER STABILIZATION AND PLACEMENT OF THE RIP RAP SHALL TAKE PLACE IMMEDIATELY UPON COMPLETION OF THE GRADING ON THE BANK AREA.

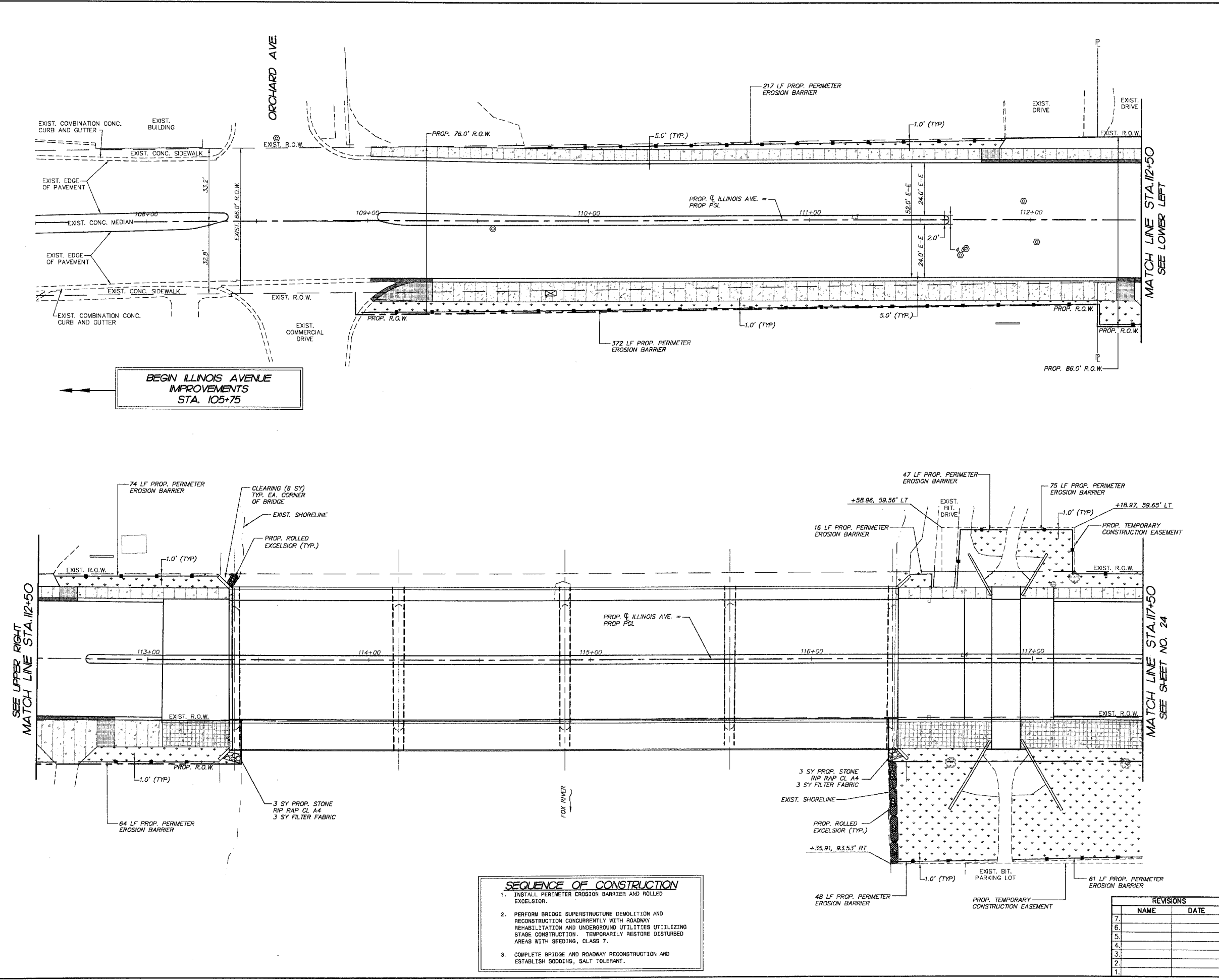

- SEQUENCE OF CONSTRUCTION**
1. INSTALL PERIMETER EROSION BARRIER AND ROLLED EXCELSIOR.
 2. PERFORM BRIDGE SUPERSTRUCTURE DEMOLITION AND RECONSTRUCTION CONCURRENTLY WITH ROADWAY REHABILITATION AND UNDERGROUND UTILITIES UTILIZING STAGE CONSTRUCTION. TEMPORARILY RESTORE DISTURBED AREAS WITH SEEDING, CLASS 7.
 3. COMPLETE BRIDGE AND ROADWAY RECONSTRUCTION AND ESTABLISH SOODING, SALT TOLERANT.

REVISIONS

NO.	NAME	DATE
7.		
6.		
5.		
4.		
3.		
2.		
1.		

SMITH ENGINEERING CONSULTANTS, INC.
 CIVIL/STRUCTURAL ENGINEERS AND SURVEYORS
 4500 PRIME PARKWAY, SUITE 201
 MCHENRY, ILLINOIS 60050
 PH: 815-385-1776 FAX: 815-385-1781
 www.smithengineering.com E-MAIL: sec@smithengineering.com
 MCHENRY HUNTLEY YOKSILL
 ILLINOIS PROFESSIONAL DESIGN FIRM # 184-000108

ILLINOIS DEPARTMENT OF TRANSPORTATION

CITY OF AURORA
 ILLINOIS AVENUE OVER THE FOX RIVER
 EROSION CONTROL PLAN
 STA 107+50 TO STA 117+50

SCALE: 1" = 20'
 DATE 07-28-2006
 DRAWN BY MPL
 CHECKED BY JLP

PLOT FILE STANDARD
 VIEW: CE-23
 COMP. FILE: C20181-526.dwg