

F.A.U. RTE.	SECTION	COUNTY	TOTAL SHEETS	SHEET NO.
1441	00-00059-00-BR	KANE	154	47
STA. 13+50		TO STA. IL RTE 25		
FED. ROAD DIST. NO.		ILLINOIS FED. AID PROJECT		

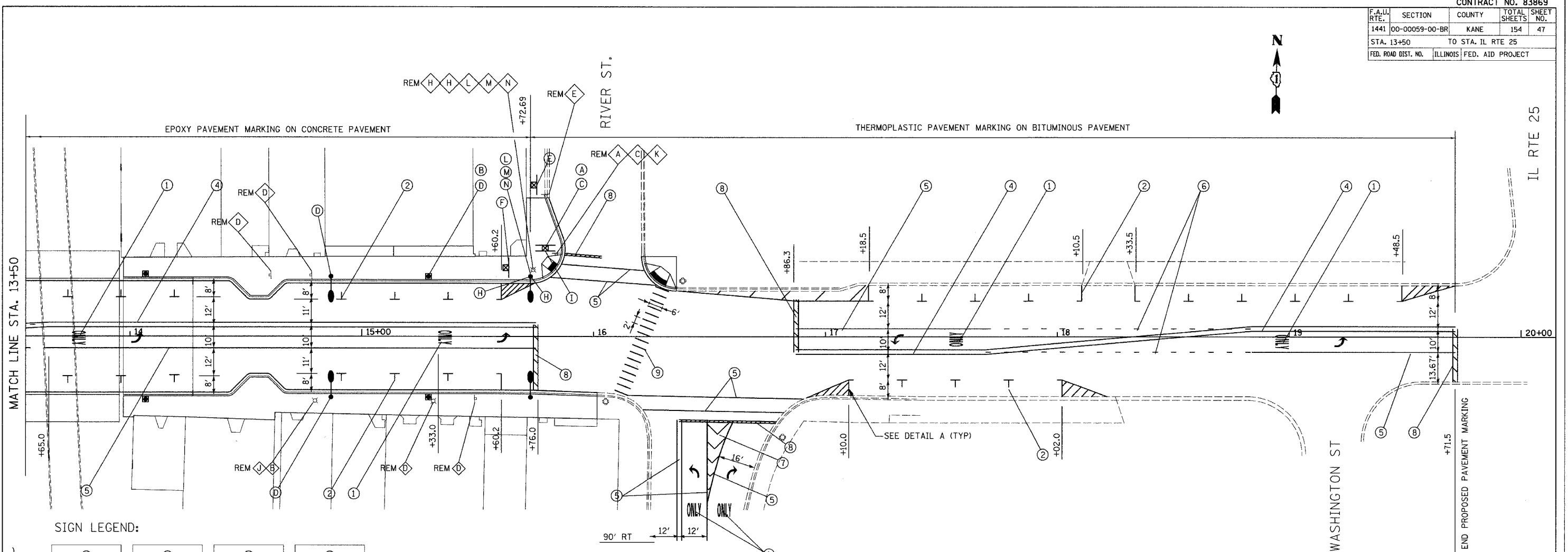

SIGN LEGEND:

R1-30	R2-1-2430	R3-5R-3036	R7-5M-1218

R7-8B-1218 \$250 FINE R7-1100-1206	R7-11-1218	R9-2-1218	D4-1-3024

D11-D-2418 M7-2-1209	R3-4-2424	

NOTE:
FOR SPECIAL SIGN DETAILS, SEE SHEET NO. SIG13

LEGEND:

- ① PAVEMENT MARKING - LETTERS AND SYMBOLS
- ② PAVEMENT MARKING - LINE 4" , SOLID, WHITE
- ③ PAVEMENT MARKING - LINE 4" , SKIP-DASH (30'-10'), WHITE
- ④ PAVEMENT MARKING - LINE 4" , SOLID, DOUBLE YELLOW
- ⑤ PAVEMENT MARKING - LINE 6" , SOLID, WHITE
- ⑥ PAVEMENT MARKING - LINE 6" , DOTTED (6'-2'), WHITE
- ⑦ PAVEMENT MARKING - LINE 12" , DIAGONALS, WHITE (5 LINES @ 45° EQUALLY SPACED IN EACH LOCATION)
- ⑧ PAVEMENT MARKING - LINE 24" , STOP BAR, SOLID, WHITE
- ⑨ PAVEMENT MARKING - LINE 12" , SOLID, WHITE, 2' SPACING
- ROADWAY LIGHT
- PEDESTRIAN LIGHT
- PROPOSED SIGN
- EXISTING SIGN REMOVAL ON LIGHT POLE OR SIGN POST
- ORNAMENTAL SIGN POST

NOTES:

1. FOR SIGN LEGEND AND PAVEMENT MARKING DETAILS, SEE SH 46
2. FOR SPECIAL SIGN DETAILS, SEE SH 49
3. ALL REMOVED SIGNS SHALL BE TRANSPORTED TO THE CITY OF BATAVIA PUBLIC WORKS DEPARTMENT.
4. DIMENSIONS ARE TO CENTERLINE OF PAVEMENT MARKING LINE OR FACE OF CURB.
5. FOR ALTERNATE ACCESS SIGNING PLAN SEE SH 48

REVISIONS	
NAME	DATE

ILLINOIS DEPARTMENT OF TRANSPORTATION
WILSON STREET
PAVEMENT MARKING &
SIGNING PLAN

SCALE: 1"=20'
DATE 07/28/2006

DRAWN BY RVM
CHECKED BY AKK

PLOT DATE = 08/11/2006
 FILE NAME = 11200600011441.dgn
 PLOT SCALE = AS CALLED
 USER NAME = RUSBER

T:\2006\1111\07\0802.dgn - 07/27/2006 08:48:38