

F.A. RTE.	SECTION	COUNTY	TOTAL SHEETS	SHEET NO.
0083 02-00270-00-BR		McHENRY	37	11
STA. 91+00	TO STA. 97+00			
FED. ROAD DIST. NO.	ILLINOIS	FED. AID PROJECT		
CONTRACT NO.: 83872				

PLAN SURVEYED BY: DATE: []
 PLOTTED BY: DATE: []
 CHECKED BY: DATE: []
 NOTE BOOK NO.: []
 RT. OF WAY CHECKED BY: []
 CLOUD FILE NAME: []

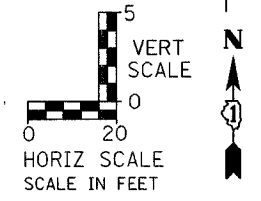

PROFILE SURVEYED BY: DATE: []
 PLOTTED BY: DATE: []
 CHECKED BY: DATE: []
 NOTE BOOK NO.: []
 BAL. NOTED BY: []
 STRUCTURE NOTATIONS CHD: []

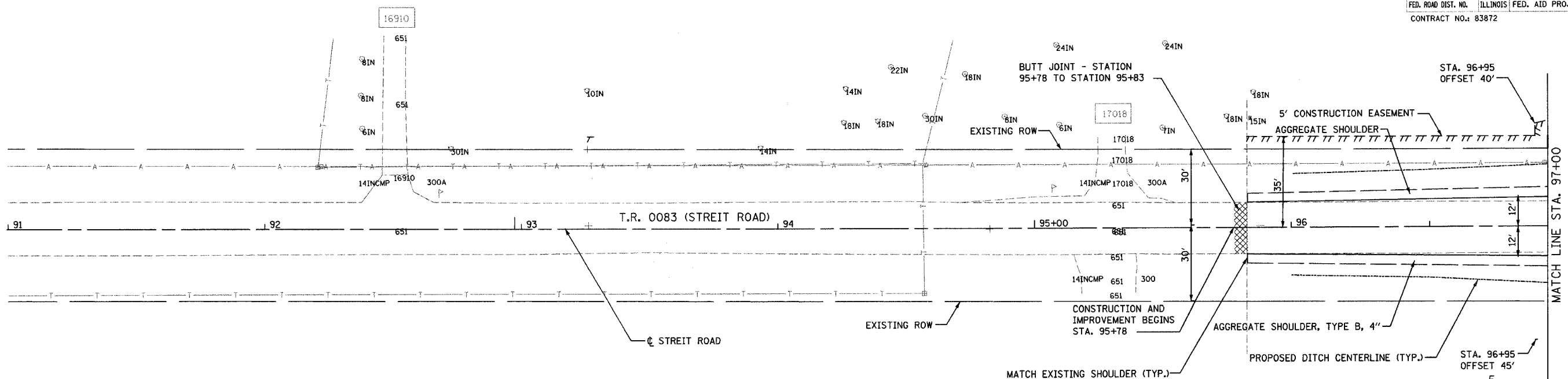
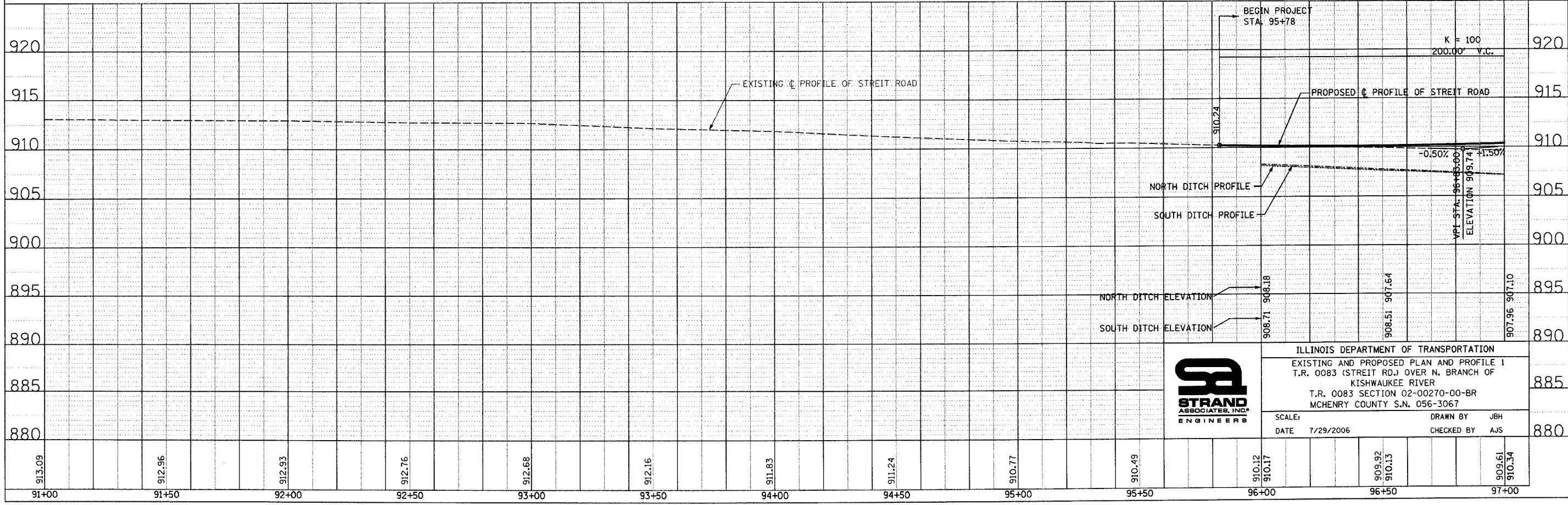

ILLINOIS DEPARTMENT OF TRANSPORTATION
 EXISTING AND PROPOSED PLAN AND PROFILE 1
 T.R. 0083 (STREIT RD.) OVER N. BRANCH OF
 KISHWAUKEE RIVER
 T.R. 0083 SECTION 02-00270-00-BR
 McHENRY COUNTY S.N. 056-3067
 SCALE: DRAWN BY JBH
 DATE 7/29/2006 CHECKED BY AJS