

F.A. RTE.	SECTION	COUNTY	TOTAL SHEETS	SHEET NO.
2666	00-00254-01-BR	LAKE	70	53
STA. 98+50		TO STA. 107+57		
FED. ROAD DIST. NO.		ILLINOIS	FED. AID PROJECT	

Sheet 30 of 35 Sheets
 PROJECT NO. BHM-8003(213)
 CONTRACT NO. 83875

PLAN	DATE	BY
DESIGNED		
PLOTTED		
ALIGNED		
CHECKED		
FILE NAME		

PROFILE	DATE	BY
DESIGNED		
PLOTTED		
CHECKED		
FILE NAME		

I:\lakeco\0220113\drawsheets\structure-16-06\cantilever forming brackets.dgn

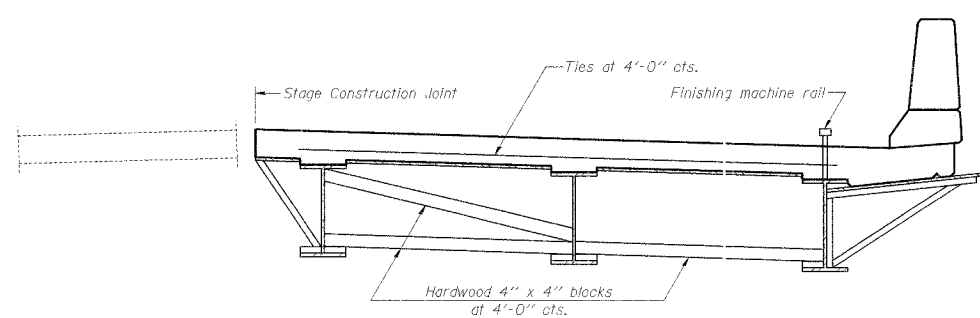

**FORM BRACES FOR
STAGE CONSTRUCTION**

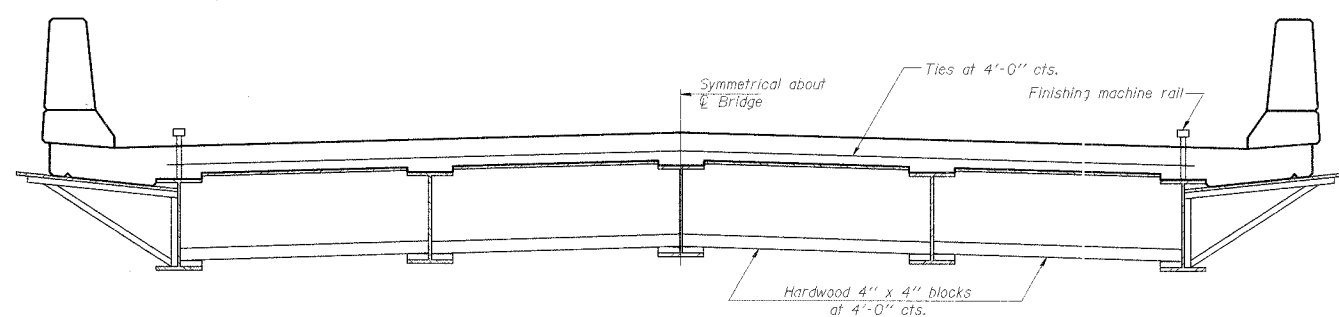

**FORM BRACES FOR
STANDARD CONSTRUCTION**

NOTES:

- When cantilever forming brackets are used, the work shall be done according to Article 503.06, except as modified below and in the details shown on this sheet.
- The finishing machine rails shall be placed on the top flange of the exterior beams.
- The beams or girders, supporting cantilever forming brackets, shall be tied together at 4 foot intervals.
- For Standard construction, or Stage Construction the Hardwood bracing materials shall be placed as shown between webs of beams in each bay.

REVISIONS	
NAME	DATE

LAKE COUNTY DIVISION OF TRANSPORTATION
CANTILEVER FORMING BRACKETS
 BUFFALO GROVE ROAD
 AT INDIAN CREEK BRIDGE
 SECTION 00-00254-01-BR STATION 101+50.00
 LAKE COUNTY STRUCTURE NO. 049-3043
 SCALE: NONE DRAWN BY: TBW
 DATE: 7/21/06 CHECKED BY: ATI, WK

CMT
 CRAWFORD MURPHY & TILLY, INC.
 CONSULTING ENGINEERS
 SPRINGFIELD, IL ■ AURORA, IL ■ ST. LOUIS, MO
 ROCKFORD, IL ■ PEORIA, IL ■ CHICAGO, IL

SB-1 9-01-03