

F.A. RTE.	SECTION	COUNTY	TOTAL SHEETS	SHEET NO.
2666 00-00254-01-BR	LAKE	LAKE	70	60
STA.	TO STA.			
FED. ROAD DIST. NO.	ILLINOIS FED. AID PROJECT			

PROJECT NO. BHM-8003(213)
CONTRACT NO. 83875

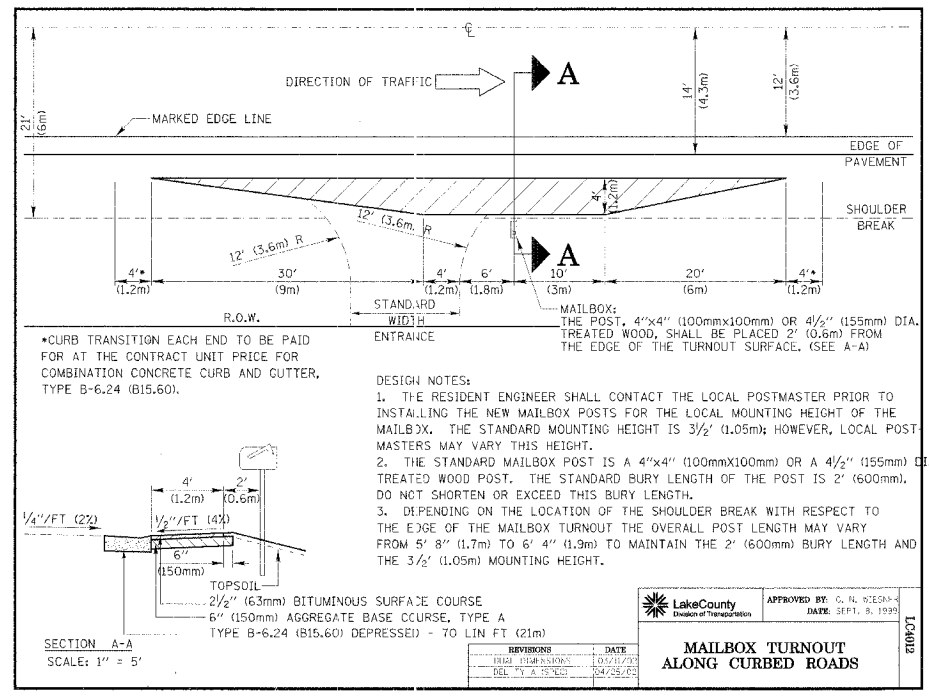
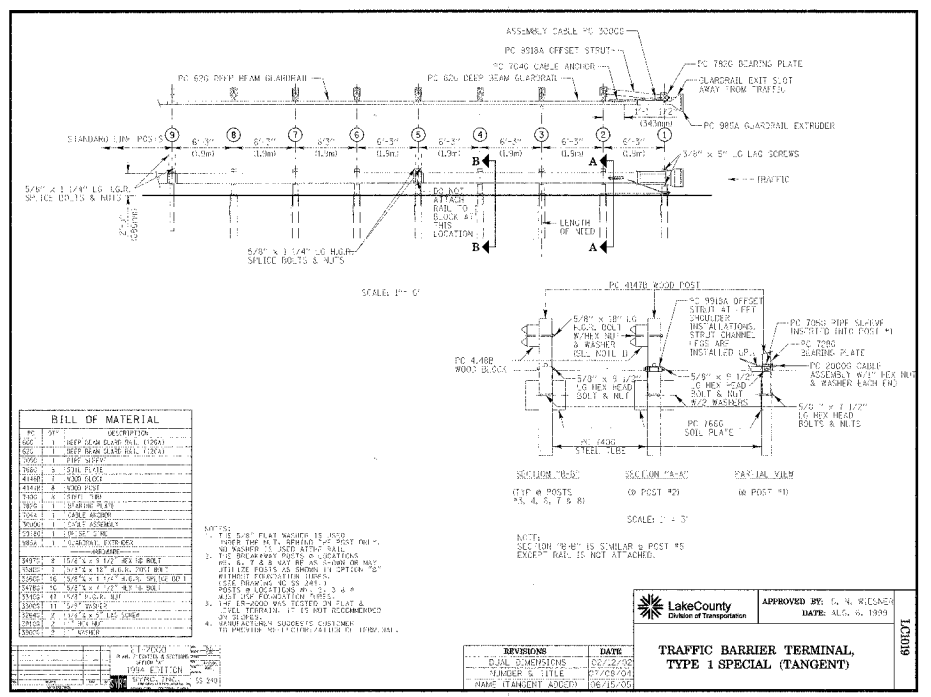
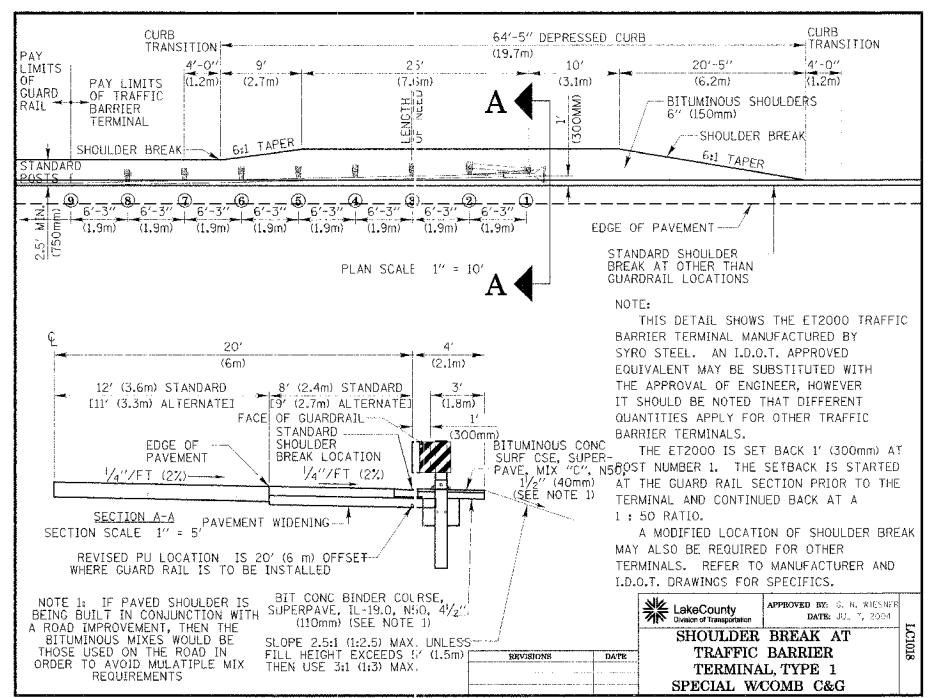
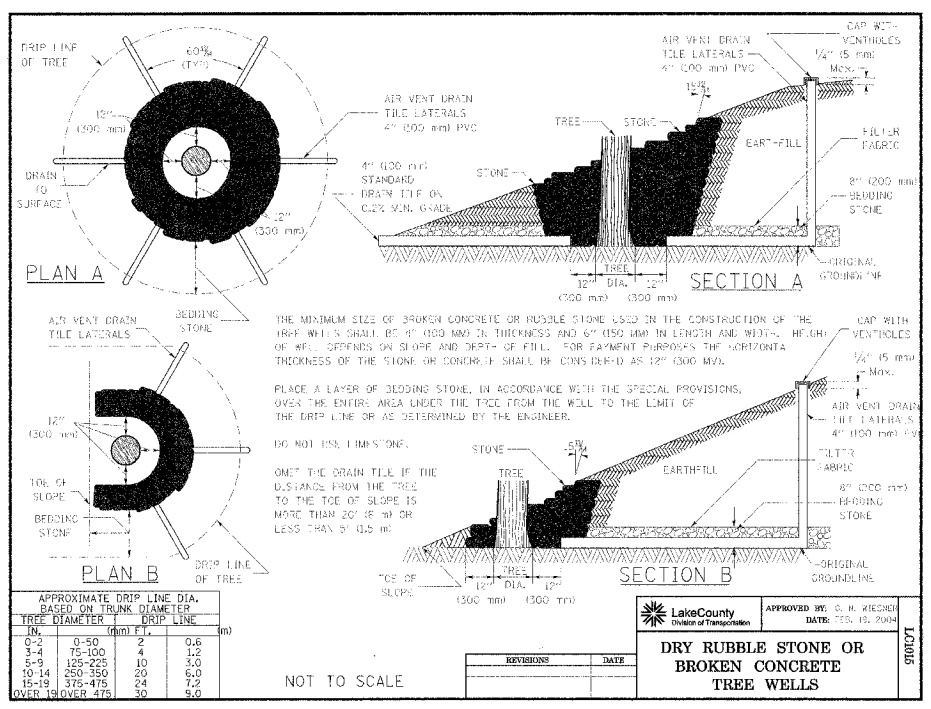

DATE	BY	REVISIONS

DATE	BY	REVISIONS

ITEM	DESCRIPTION	QUANTITY	UNIT
1	CONCRETE		
2	STEEL		
3	WOOD		
4	PAVEMENT		
5	AGGREGATE		
6	BITUMINOUS		
7	STONE		
8	BRICK		
9	GLASS		
10	PLASTER		
11	PAINT		
12	LABOR		
13	EQUIPMENT		
14	UTILITIES		
15	PERMITS		
16	INSURANCE		
17	TRAVEL		
18	MEALS		
19	HOUSING		
20	PHONE		
21	POSTAGE		
22	CONTINGENCY		
23	TOTAL		

REVISIONS	NAME	DATE

ILLINOIS DEPARTMENT OF TRANSPORTATION
CONSTRUCTION DETAILS
BUFFALO GROVE ROAD

CMT
CRAWFORD MURPHY & TILLY, INC.
CONSULTING ENGINEERS
SPRINGFIELD, IL ■ AURORA, IL ■ ST. LOUIS, MO

SCALE: VERT.: N.T.S.
HORIZ.: N.T.S.
DATE: 7/21/06
DRAWN BY: ERD
CHECKED BY: PWK