

- PROPOSED MH 1A**  
 STA. 11+31  
 TOP = 790.40  
 INV. = 778.08 (W)  
 (FIELD VERIFY)  
 INV. = 778.30 (E)
- PROPOSED MH 1**  
 STA. 12+83  
 TOP = 795.20  
 INV. = 779.55 (W)  
 INV. = 779.65 (S)  
 INV. = 782.68 (E) DROP  
 (FIELD VERIFY)
- PROPOSED MH 2**  
 STA. 15+13  
 TOP = 788.60  
 INV. = 780.80 (N,S)
- PROPOSED MH 3**  
 STA. 16+06  
 TOP = 786.25  
 INV. = 781.26 (N)  
 INV. = 781.36 (E)
- PROPOSED MH 4**  
 STA. 17+06  
 TOP = 790.8  
 INV. = 783.53 (S)  
 INV. = 783.30 (W)

**NOTE:**  
 ALL EASEMENT STATION AND OFFSET LABELS ARE BASED ON THE ENGLISH BASED PROPOSED ALTA ROAD SANITARY SEWER CENTERLINE STATIONING. ENGLISH STATIONING OF ALTA ROAD ESTABLISHED BY CONVERTING METRIC STA. 1+000 TO ENGLISH STA. 32+80.84

**NOTE:**  
 FIELD VERIFY ELEVATION OF EXISTING 16" DUCTILE IRON WATER MAIN PRIOR TO BEGINNING CONSTRUCTION.  
 ADJUST PROPOSED ELEVATIONS WITH THE APPROVAL OF THE ENGINEER TO PROVIDE 18" MIN CLEARANCE ABOVE EXISTING WATER MAIN.

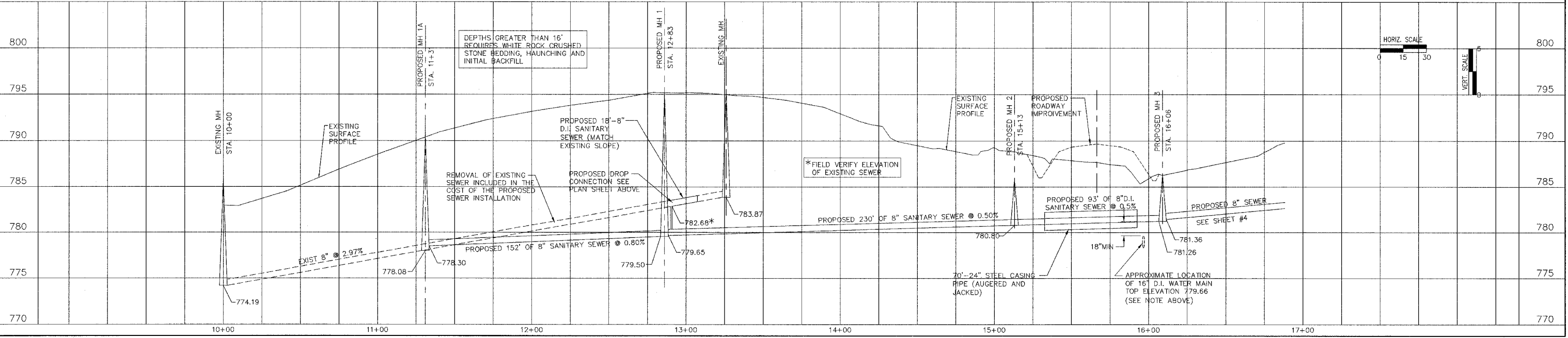

REVISIONS		
NO.	ITEM	DATE
1	REVISED PER GPSD & IDOT	3/8/06
2	MOVED SEWER OVER WATER MAIN	4/10/06

PLOTTING SCALE: 1" = 30'  
 DRAWN BY: MPS  
 CHECKED BY: JAR  
 DATE: JANUARY 2006

**McCLURE ENGINEERING ASSOCIATES, INC.**  
 714 East Jackson Street  
 (309) 833-4594  
 Macomb, Illinois 61455  
 FAX (309) 837-4909  
 Design Firm License #184-000816 Copyright 2006 by McClure Engineering Associates, Inc.

**ALTA ROAD SANITARY SEWER EXTENSION PLAN AND PROFILE**  
 PEORIA, ILLINOIS

PEORIA ILLINOIS  
 FILE NAME: \\DWG\PEORIA-2005\DUMLAP-BANK.DWG FIELD BOOK No: 2679-A JOB NUMBER: 03-23-05-114