

SEC.29, T.10N., R.8E., 4th P.M.

RTE NO.	SECTION	COUNTY	TOTAL	SHEET #
FA 646	(Y)W-1, RS-3	PEORIA	142	90
STATION 15+350 TO STATION 15+800				

- RAISED REFLECTIVE PAVEMENT MARKERS (RRPM)**
- 1 ONE-WAY RRPM CRYSTAL MARKER AT 24.38 m CENTERS
 - 2 ONE-WAY RRPM CRYSTAL MARKER AT 12.19 m CENTERS
 - 3 TWO-WAY RRPM AMBER MARKER AT 12.19 m
 - 4 ONE-WAY RRPM AMBER MARKER AT 12.19 m

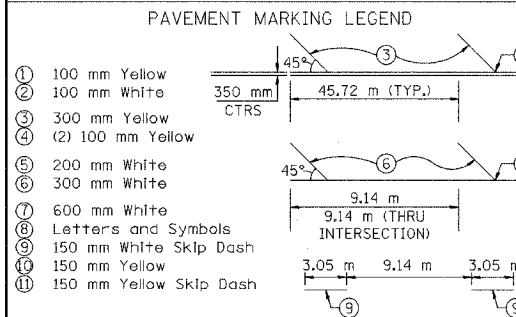
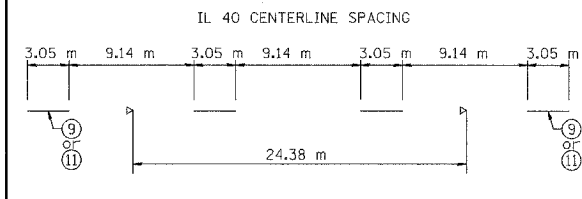

SIGN PANEL ERECTION DETAILS
REFER TO STANDARD 720006, MULTILANE HIGHWAYS, NONFREEWAYS.

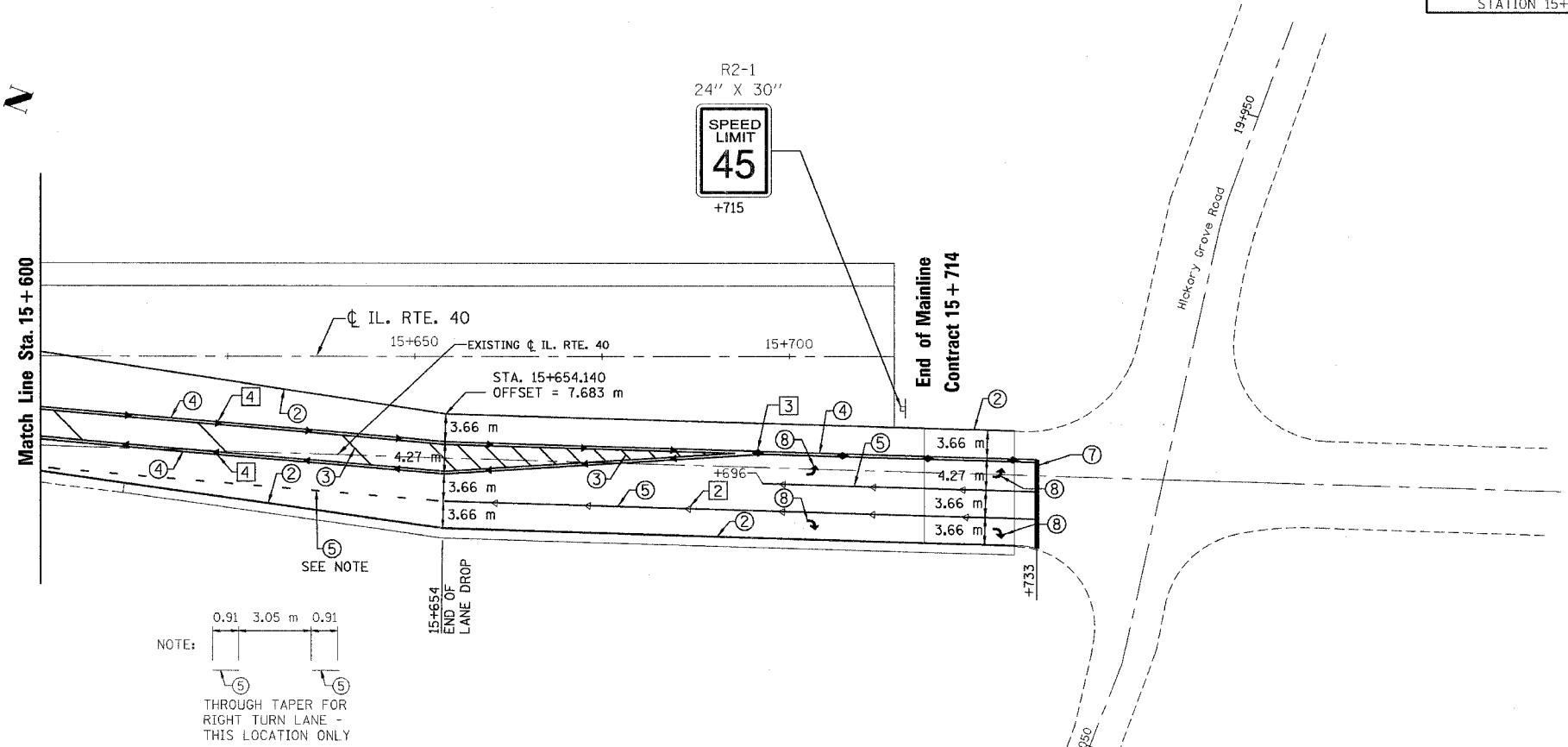

NOTE:
0.91 3.05 m 0.91
THROUGH TAPER FOR RIGHT TURN LANE - THIS LOCATION ONLY

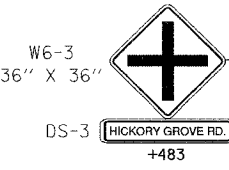
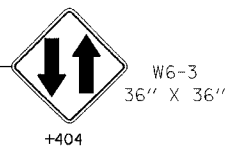
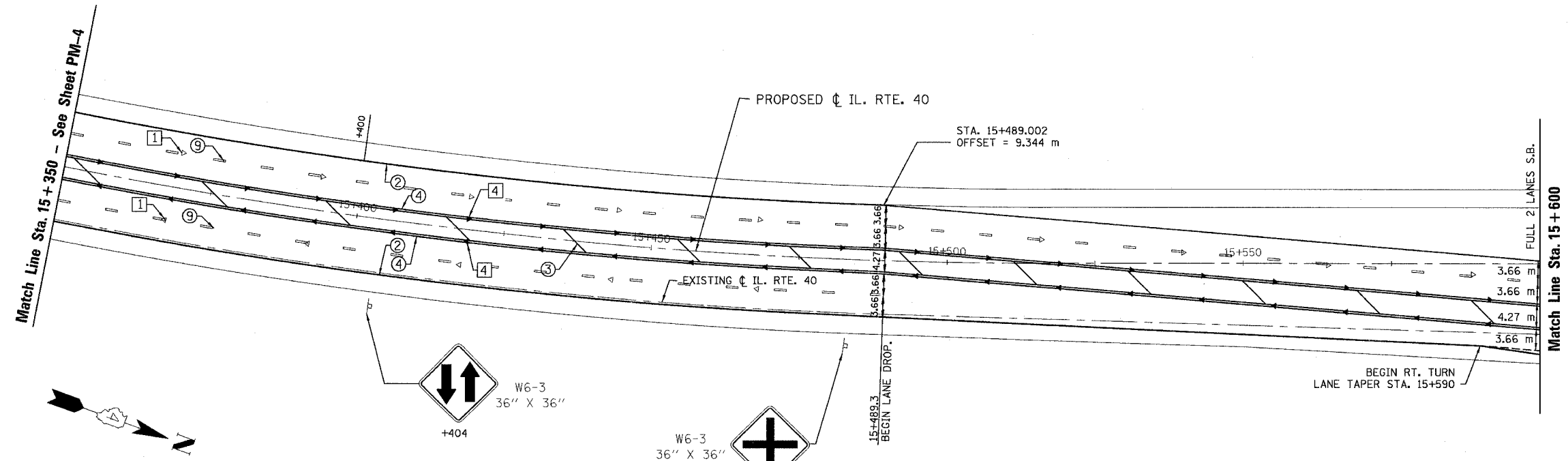

0m 10m 15m 20m 25m

REVISIONS	
NAME	DATE

ILLINOIS DEPARTMENT OF TRANSPORTATION
PAVEMENT MARKINGS AND SIGNING PLAN
ILLINOIS ROUTE 40

SCALE: 1:400
DATE: 09/01/06

DRAWN BY: JDU
CHECKED BY: ECM