

UNLESS ELEVATIONS ARE SHOWN:  
ALL UTILITY LOCATIONS ON THE CROSS SECTIONS ARE BASED ON  
THE APPROXIMATE DEPTH SUPPLIED BY THE UTILITY COMPANY.

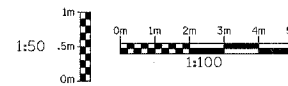

TOPSOIL EXCAVATION QUANTITIES DO NOT INCLUDE THE STOCKPILE LOCATED AT STA. 14+240 TO 14+295

RTE NO.	SECTION	COUNTY	TOTAL	SHEET #
FA 646	(Y)W-1, RS-3	PEORIA	142	131
STATION 15+125 TO STATION 15+200				

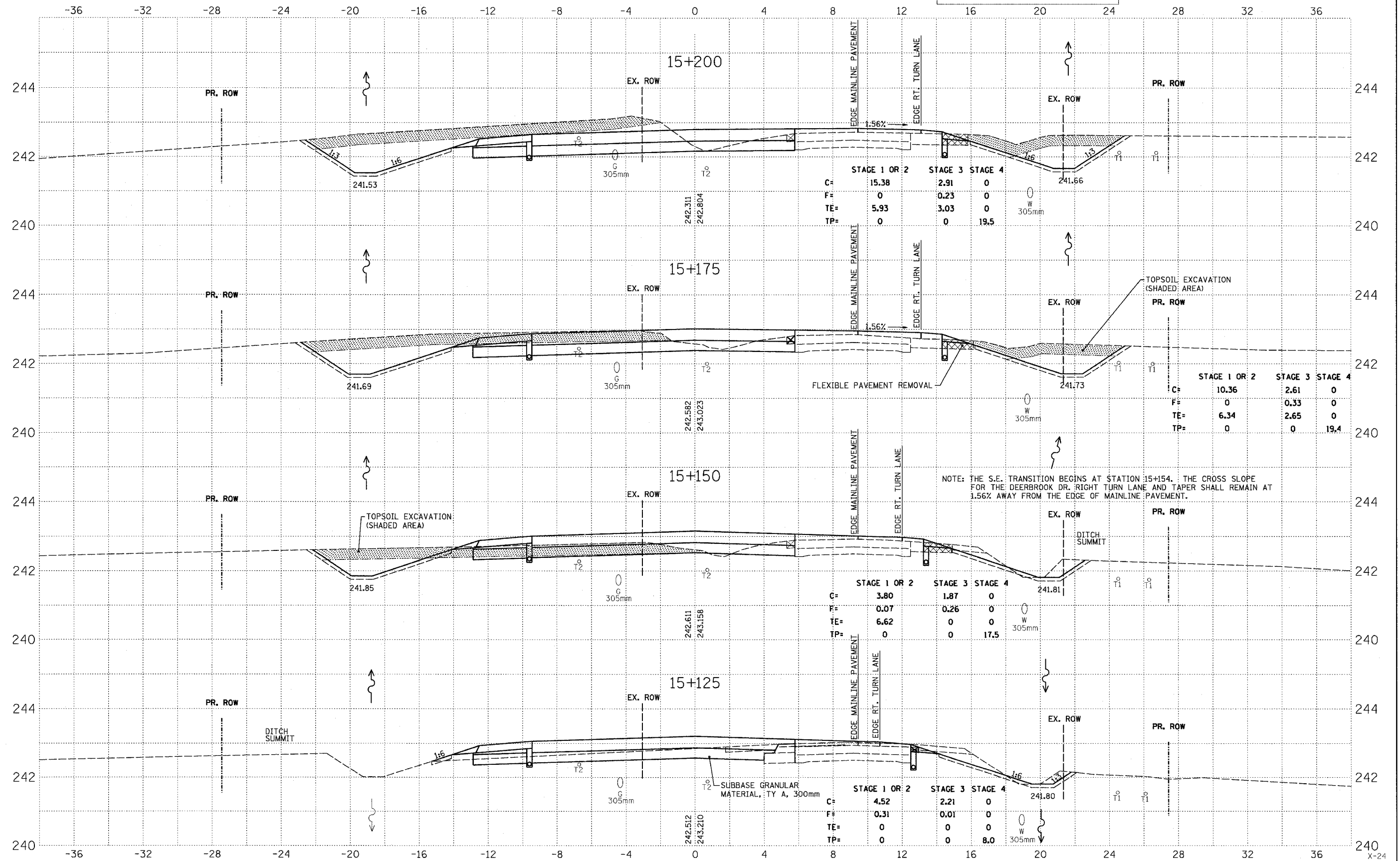

NOTE: THE S.E. TRANSITION BEGINS AT STATION 15+154. THE CROSS SLOPE FOR THE DEERBROOK DR. RIGHT TURN LANE AND TAPER SHALL REMAIN AT 1.56% AWAY FROM THE EDGE OF MAINLINE PAVEMENT.