

F.A. RTE.	SECTION	COUNTY	TOTAL SHEETS	SHEET NO.
332	RX-1-BR-1	VERMILION	140	73

CONTRACT NO. 90841

DETAIL OF TREE PLANTING

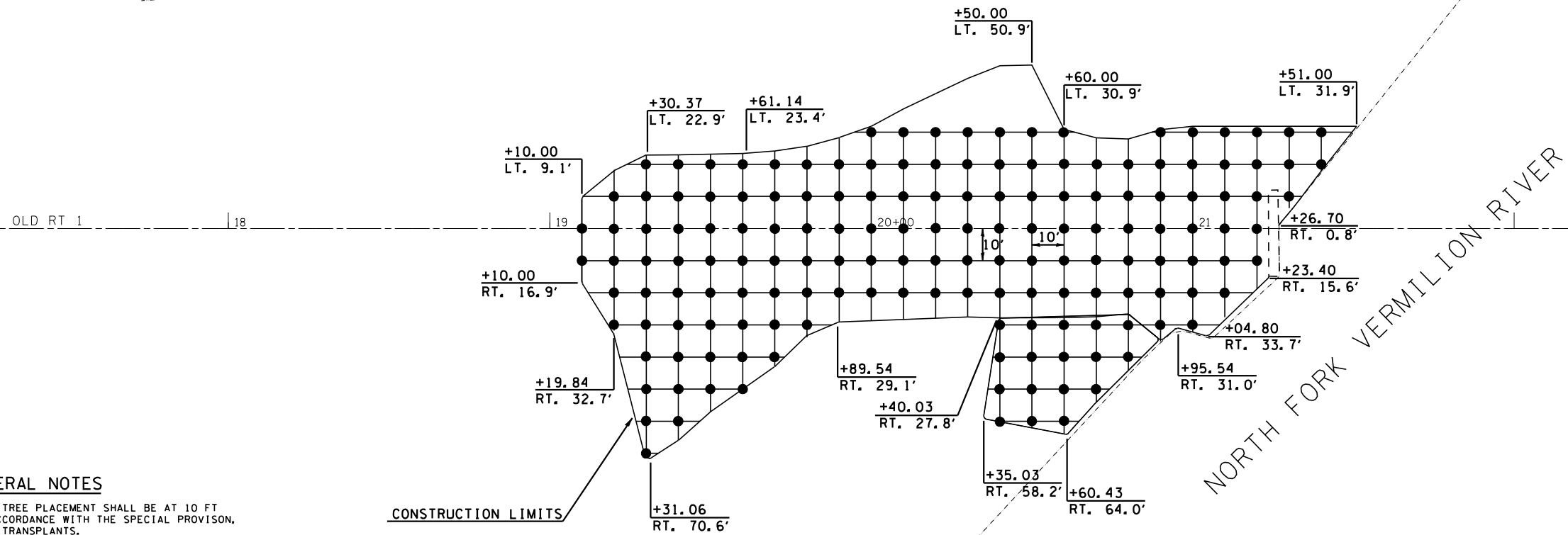

GENERAL NOTES

- FOR INFORMATION, TREE PLACEMENT SHALL BE AT 10 FT CENTERS AND IN ACCORDANCE WITH THE SPECIAL PROVISION, REPLACEMENT TREE TRANSPLANTS.

DETAIL OF POROUS GRANULAR BACKFILL AT A.R. PIPE CULVERTS

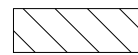
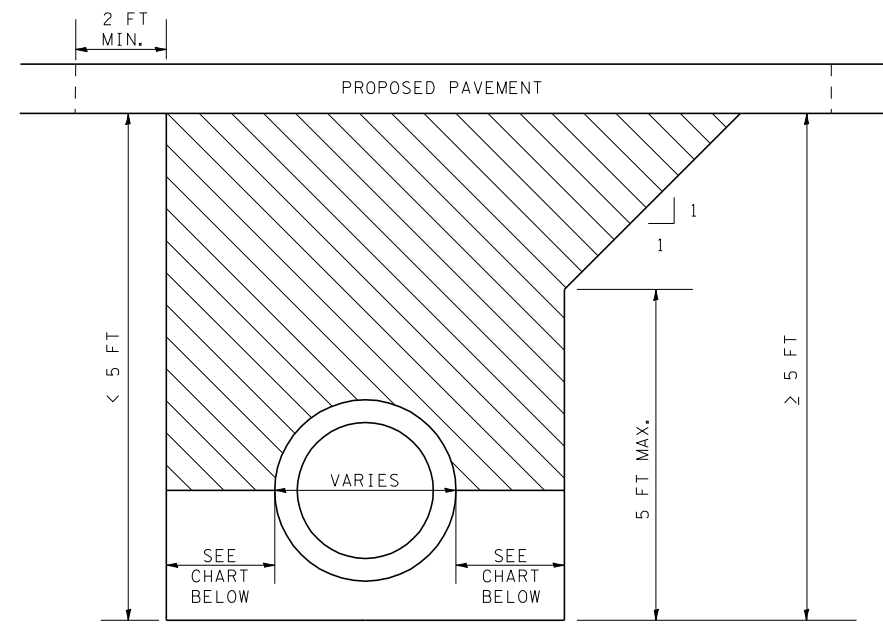

PAY LIMITS OF POROUS GRANULAR BACKFILL

POROUS GRANULAR BACKFILL SHALL EXTEND 2 FT OUTSIDE OF PROPOSED EDGE OF PAVEMENT

TRENCH DEPTH	MAX. WIDTH
< 5 FT	9 IN + O.D. + 9 IN
≥ 5 FT	18 IN + O.D. + 18 IN